

MINUTES OF THE SPECIAL MEETING OF THE BOARD OF EDUCATION
OF STERLING PUBLIC SCHOOLS, DISTRICT #33
Monday, February 21, 2022

A regular meeting of the Board of Education of Sterling Public Schools was convened in open and public session on Monday, February 21, 2022, 7:12 PM at Sterling Public Schools. The roll was called and the following Board members were present or absent:

Present: John Harms, Stan Karr, Kevin McAuliffe, Julie Saathoff, Russ Trauernicht, **Absent:** Rick Vollman.

Notice of the meeting was given in advance by posting in accordance with the Board approved method for giving notice of meetings. Notice of this meeting was given in advance to all members of the Board of Education. The agenda was posted in accordance to board policy. All proceedings of the Board of Education, except as may be hereinafter noted, were taken while the convened meeting was open to the attendance of the public.

A. Call Meeting to Order

B. Recognize Nebraska Open Meetings Law

C. Publication of Meeting

D. Roll Call

Motion made to dismiss Rick Vollman from the meeting. Passed with a motion by John Harms and a second by Julie Saathoff.

John Harms: Yea

Stan Karr: Yea

Kevin
McAuliffe: Yea

Julie Saathoff: Yea

Russ
Trauernicht: Yea

Yea: 5, Nay: 0

E. Pledge of Allegiance

F. Approval of agenda

G. Public Comment

H. Board Committee Reports

I. Administration Reports

J. Consent Agenda

I make the motion to approve the consent agenda as presented. Passed with a motion by John Harms and a second by Kevin McAuliffe.

John Harms: Yea

Stan Karr: Yea

Kevin
McAuliffe: Yea

Julie Saathoff: Yea

Russ
Trauernicht: Yea

Yea: 5, Nay: 0

K. Action Items

K.1. Commendations

K.2. Consider and Approve 2022-2023 Superintendent's Contract

K.3. Consider and Approve 2022-2023 Principal Contract

K.4. Consider and Approve 2022-2023 School Calendar

I make the motion to approve the 2022-2023 school calendar. Passed with a motion by Russ Trauernicht and a second by Stan Karr.

John Harms: Yea

Stan Karr: Yea

Kevin
McAuliffe: Yea

Julie Saathoff: Yea

Russ
Trauernicht: Yea

Yea: 5, Nay: 0

K.5. Consider and Approve Heartland Roofing Bid

K.6. Consider and Approve Tammy McAuliffe's Resignation

I make the motion to approve Tammy McAuliffe's resignation. Passed with a motion by John Harms and a second by Julie Saathoff.

John Harms: Yea

Stan Karr: Yea

Kevin
McAuliffe: Yea

Julie Saathoff: Yea

Russ
Trauernicht: Yea
Yea: 5, Nay: 0

K.7. Consider and Approve Sara Salzman's Resignation

I make the motion to approve Sara Salzman's Resignation. Passed with a motion by Kevin McAuliffe and a second by Stan Karr.

John Harms: Yea
Stan Karr: Yea
Kevin
McAuliffe: Yea
Julie Saathoff: Yea
Russ
Trauernicht: Yea
Yea: 5, Nay: 0

L. Discussion Items:

- L.1. Plan of use for ESSERS III
- L.2. Locker room flooring options
- L.3. Board Retreat
- M. Closed Session
- N. Adjourn

Adjourned at 8:35pm.

The meeting was duly adjourned.
DATED: Monday, February 21, 2022

JOHNSON COUNTY SCHOOL DISTRICT #33,
a/k/a STERLING PUBLIC SCHOOLS

ATTEST:

Secretary

Superintendent Report

February 21, 2022



ESU 6 Superintendent Meeting

January 19 - Pioneer Conference Meeting

- Diller Odell is cooping JHFB with Southern
- Looked at Conference expansion
 - Southern and Tri County were approached about joining the ECNC
- Jay Bellar addressed the group
 - Talked to group about how he believes that the best way to handle events is by locally governed as Lincoln should not dictate what Falls City is doing and so on
 - Spoke on Wet Bulb globe – used for football and other sporting events to determine heat issues – looking to purchase some as there has been 12 heat related deaths this last year
 - Reminded group that you can applying for accommodations for athletes with disability through the NSAA
 - Been fielding some questions on why softball is a fall sport – people are starting to petition it to be the spring
 - 90 day eligibility rule – some states are 180 days – asked the group their opinion and most agreed the 90 days was plenty
 - Home school case coming forward – local control on handling home school
 - NIL – is coming to HS but it can't relate back to the school – for example star player can be in a commercial for car dealership but cannot say what school they are affiliated with our wear school apparel
 - State track will most likely remain a 4-day deal
 - Shot clock – was turned down but will be brought up in the near future



Maintenance

- Steve is repairing the freezer door in the kitchen
- Replaced the fan on Air Handler in high school
- Tightened the seals on the Air Handler in ballroom
- Cleaned graffiti on the bathroom stalls
- The roof has been looked at by 2 different companies



Evaluation Updates

- 3 Year Evaluation Plan
- Touches on all elements over a 3 year period.
- More direct and improves teaching

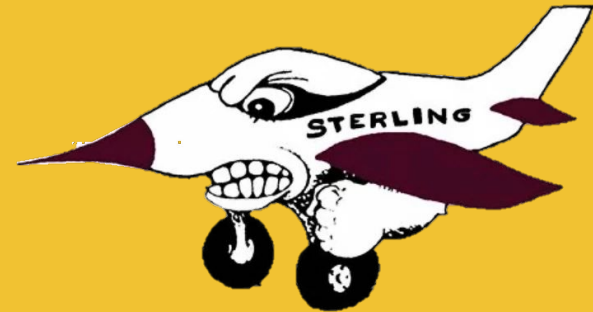

Principal Report

February 4 - Engaging Educators

- Dave Stuart Jr
- Shape Assessment Training (work in process)

February 15 - Commissioner zoom

- Youth transmissions are at an all time high

February 16 - Pioneer Conference Principal's Meeting

- Passing periods
- EduRoam

Chemistry as Physical Science Requirement

- Offers upper level students an opportunity to only take upper level classes
- Chemistry is a "Physical Science" as defined by the NDE
- Graduation requirements only require "Physical Science"
- Creates opportunities for students to reach upper level maths as electives later on as well

Assistant Track Coach Assigned

- Ms. Paitz



Principal Report

Class Schedule

Sterling Public Schools Secondary Schedule 2022-2023

	Period 1	AP	Period 2	Period 3	Period 4	Period 5	Period 6	Period 7	Period 8
	8:00-8:50	8:50-9:05	9:07-9:57	9:59-10:49	10:51-11:41	11:43-1:01	1:03-1:53	1:55-2:45	2:47-3:37
Gossard	9-12 Band		7-8 Band/Choir	ELEM	9-12 Choir	PLAN	ELEM	ELEM	ELEM
Harlan	Psych/ Soc?4th		Am. Govt 11	Am. Govt 11	Psych/ Soc?4th	World History 10	American History 7	World History 8	American History 9
Helmberger	Woods I/II (10)			Shop 8	Into to Skilled Tech 10	Woods I/II (12)	Drafting/Construction (12)	Transportation/Auto (11)	Metals 12
Heusman							College Algebra		
Hollman	Art 9		7-8 Art	Health	Art	PLAN			
Matkins			Physical Science 10		Science 7	Science 8	Chem 11	Biology 9	Physics 12
Paitz	Comp Apps 7		Personal Finance 12	Bus Comm 10	Acct 1-2 (11)	Digital Media	Business 8		Accounting 3-4
Pfeiffer	Math 8		Algebra 2 11	Trig 11	Calculus 12	Math 7	Algebra I (9)	Geometry 10	
Richardson	PE 2			ELEM	PE 9			PE 2	Jr. High PE
Saathoff									
Salberg	JB		7-8 Intervention	Spanish 1 (9)/JB	JB	Spanish 3 11	Spanish 2 (10)	PLAN	Spanish 4 12
Schultz	Ag 7		Ag 9	Careers 8	Ag 10	Life & Career/Food Prod 12	Sci 11		Jr. High PE
Steele	PLAN		Speech 9	English 7	Journalism	English 9	Drama 8	English 11	English 10
Wusk				English 12	English 8			Writing 7	

Secondary Silent Reading will be during the first 15 minutes of every rotating study hall excluding early out.

Color Coding Key

7th

8th

9th

10th

11th

12th

Transportation/AD Report

- Luke's bus was in need of some repairs at Inland in Lincoln. The main thing they replaced/fixed was the turbo actuator on his bus. We had been battling a stop engine warning light for a while, so hopefully this fixes that issue. We will be getting the 3rd round of inspections started in March.
- Our girls BB team will play in a district final next Friday vs. South Platte. Our boys travel down to FCSH to play Diller-Odell in subdistrict play on Tuesday.
- The state BB tournaments will happen over a 6 day period the week of March 7th - 12th. This is due to UNL hosting the Big 10 wrestling tournament. Our girls would play on Mon/Wed/Fri. If we were to qualify. The boys would play on Tues/Thur/Sat if they were to qualify.



Transportation/AD Report

- I will be attending the Mudecas AD meeting on Wednesday, Feb. 23rd.
- Our HS football schedule came out for the next 2 year cycle. Our out of district games are Heartland Lutheran, Hampton, and St. Edward.
- HS track practice is set to begin on Monday, Feb. 28th for those not participating in basketball.
- Our trap team has started practice and their 1st competition is scheduled for Saturday, March 12th in Beatrice. We have 14 students (11JH & 3HS) participating in trap shooting this year.



Transportation/AD Report



MINUTES OF THE SPECIAL MEETING OF THE BOARD OF EDUCATION
OF STERLING PUBLIC SCHOOLS, DISTRICT #33
Monday, January 17, 2022

A regular meeting of the Board of Education of Sterling Public Schools was convened in open and public session on Monday, January 17, 2022, 7:39 PM at Sterling Public Schools. The roll was called and the following Board members were present or absent:

Present: John Harms, Stan Karr, Kevin McAuliffe, Julie Saathoff, Russ Trauernicht, **Absent:** Rick Vollman.

Notice of the meeting was given in advance by posting in accordance with the Board approved method for giving notice of meetings. Notice of this meeting was given in advance to all members of the Board of Education. The agenda was posted in accordance to board policy. All proceedings of the Board of Education, except as may be hereinafter noted, were taken while the convened meeting was open to the attendance of the public.

A. Call Meeting to Order

Called to order at 7:02

B. Recognize Nebraska Open Meetings Law

C. Publication of Meeting

D. Roll Call

Motion to excuse Rick Vollman from the meeting. Passed with a motion by John Harms and a second by Julie Saathoff.

John Harms: Yea

Stan Karr: Yea

Kevin McAuliffe: Yea

Julie Saathoff: Yea

Russ Trauernicht: Yea

Yea: 5, Nay: 0

E. Pledge of Allegiance

F. Approval of agenda

G. Public Comment

H. Board Committee Reports

Negotiations have wrapped up to be voted on.

I. Administration Reports

J. Consent Agenda

I make the motion to accept the consent agenda as presented. Passed with a motion by Kevin McAuliffe and a second by Russ Trauernicht.

John Harms: Yea
Stan Karr: Yea
Kevin McAuliffe: Yea
Julie Saathoff: Yea
Russ Trauernicht: Yea
Yea: 5, Nay: 0

K. Action Items

K.1. Commendations

K.2. Consider and Approve 2022-2023 Negotiated Agreement

I make the motion to approve the 2022-2023 Negotiated Agreement as presented. Passed with a motion by Stan Karr and a second by Julie Saathoff.

John Harms: Yea
Stan Karr: Yea
Kevin McAuliffe: Yea
Julie Saathoff: Yea
Russ Trauernicht: Yea
Yea: 5, Nay: 0

K.3. Consider and approve revision of Superintendent evaluation instrument

K.4. Consider Work Release for Senior Student #1

I make the motion to approve an afternoon work-study for Kanyon Fossler. Passed with a motion by Kevin McAuliffe and a second by Julie Saathoff.

John Harms: Yea
Stan Karr: Yea
Kevin McAuliffe: Yea
Julie Saathoff: Yea
Russ Trauernicht: Yea
Yea: 5, Nay: 0

K.5. Consider Work Release for Senior Student #2

I make the motion to approve an afternoon work-study for Zeke Topp. Passed with a motion by Russ Trauernicht and a second by Kevin McAuliffe.

John Harms: Yea
Stan Karr: Yea
Kevin McAuliffe: Yea
Julie Saathoff: Yea
Russ Trauernicht: Yea
Yea: 5, Nay: 0

K.6. Consider and approve the sale of the 2013 Dodge Caravan

L. Discussion Items:

L.1. Annual Report

L.2. Review Board of Education Policies 1000 series

M. Closed Session

I make the motion to enter closed session to discuss personnel. Passed with a motion by John Harms and a second by Julie Saathoff.

John Harms: Yea

Stan Karr: Yea

Kevin McAuliffe: Yea

Julie Saathoff: Yea

Russ Trauernicht: Yea

Yea: 5, Nay: 0

I make the motion to return from closed session. Passed with a motion by Russ Trauernicht and a second by Julie Saathoff.

John Harms: Yea

Stan Karr: Yea

Kevin McAuliffe: Yea

Julie Saathoff: Yea

Russ Trauernicht: Yea

Yea: 5, Nay: 0

N. Adjourn

Adjourned at 8:23pm.

The meeting was duly adjourned.
DATED: Monday, January 17, 2022

JOHNSON COUNTY SCHOOL DISTRICT #33,
a/k/a STERLING PUBLIC SCHOOLS

ATTEST:

Secretary

Sterling Public Schools

Payment Management Invoice Report

[Cycle Name]: "FY21/22"; Created On: 2/17/2022 12:32:21 PM

Invoice Status	Invoice(s)	Invoice Type	Submit Date	PO Number	Ordering Vendor
Include	75895	Direct	02/14/2022		Menards
Include	January 14th Bill	Direct	02/14/2022		Nebraska Public Power Distric
Include	INV3337405	Direct	02/14/2022		WageWorks, Inc
Include	C13235353	Direct	02/14/2022		Cash-wa Distribution
Include	C13233614	Direct	02/14/2022		Cash-wa Distribution
Include	2239	Direct	02/14/2022		PANKO
Include	6205	Direct	02/14/2022		Village Of Sterling
Include	1300534	Direct	02/14/2022		DAS State Accounting - Central Finance
Include	Dennis Boslau Physical	Direct	02/14/2022		Johnson County Hospital
Include	reimb.	Employee	02/14/2022		Logston, Steven
Include	00210360	Regular	02/14/2022	22-0011	Glaser Ceramics
Include	4193	Regular	02/14/2022	22-0013	OverDrive Education
Include	1000265249	Regular	02/14/2022	22-0012	School Health
Include	13231531	Direct	02/14/2022		Cash-wa Distribution
Include	3325	Direct	02/14/2022		KLEIN HARDWARE HEATING & AIR
Include	multiple	Direct	02/14/2022		Amazon Capital Services
Include	17xm-7l6h-kxjy	Direct	02/14/2022		Amazon Capital Services
Include	16dr-cj1c-jmdc	Direct	02/14/2022		Amazon Capital Services
Include	1xrm-rrlm-16cf	Direct	02/14/2022		Amazon Capital Services
Include	210579	Direct	02/14/2022		Beatrice Mechanical Service Inc
Include	SR21058	Direct	02/14/2022		EDGERTON EXPLORIT CENTER
Include	2021 safe deposit box rental	Direct	02/14/2022		First Bank of Nebraska
Include	postage	Direct	02/14/2022		United States Postal Service
Include	753, 748, 278	Direct	02/14/2022		T.O. Haas
Include	662462191	Direct	02/14/2022		The Home Depot Pro
Include	01/24/22	Direct	02/14/2022		Buss Pest Control
Include	o-891	Direct	02/14/2022		NCECBVI
Include	418	Direct	02/14/2022		WUSK ELECTRIC
Include	22R32	Direct	02/14/2022		Waymire Well Drilling, Inc.
Include	9747 network admin 2nd half	Direct	02/14/2022		ESU #4
Include	1172	Direct	02/14/2022		Hancock Lumber, LLC
Include	347562	Direct	02/14/2022		EGAN SUPPLY CO
Include	346479A	Direct	02/14/2022		EGAN SUPPLY CO
Include	W0B5G10	Regular	02/14/2022	22-0016	Nasco

Include	461078827, 461089483, 461100197	Direct	02/14/2022		SYSCO OF LINCOLN
Include	18732	Direct	02/14/2022		Village Of Sterling
Include	4609	Direct	02/14/2022		Tecumseh Chieftain
Include	22/23 dues	Direct	02/14/2022		Nebraska Association Of Scbd
Include	60013	Regular	02/14/2022	22-0017	Blick art material
Include	11443	Direct	02/14/2022		KSB SCHOOL LAW
Include	01/31/2022	Direct	02/14/2022		ADAMS SUPER FOODS
Include	51908185	Direct	02/14/2022		Matheson Trigas DBA Linweld
Include	170821	Regular	02/14/2022	22-0022	KnowBe4
Include	13249726	Direct	02/14/2022		Cash-wa Distribution
Include	SI-22-004559	Direct	02/14/2022		UNITE PRIVATE NETWORKS, LLC
Include	30907674	Direct	02/14/2022		CAPITAL BUSINESS SYSTEMS, INC
Include	12538284	Direct	02/14/2022		Symmetry Energy Solutions, LLC
Include	01/31/2022	Employee	02/14/2022		MARSHALL KATIE B
Include	3563	Direct	02/14/2022		Striv, Inc
Include	953490, 953561, 953601, 953683	Direct	02/14/2022		HILAND DAIRY
Include	1753791T059	Direct	02/14/2022		WINDSTREAM COMMUNICATIONS, INC
Include	245, 235, 200	Direct	02/14/2022		Laffman Hot Rod Garage
Include	10804800, 10804801	Regular	02/14/2022	22-0020	FOLLETT SCHOOL SOLUTIONS INC
Include	5018	Direct	02/14/2022		JET STOP INC.
Include	LF 0037	Direct	02/14/2022		NRCSA
Include	382292904A	Direct	02/14/2022		PSAT/NMSQT
Include	01/31/2022	Direct	02/14/2022		WINDSTREAM COMMUNICATIONS, INC
Include	16452	Direct	02/14/2022		ESU #6
Include	02/08/2022	Regular	02/14/2022	22-0023	Staples
Include	reimbursement	Employee	02/14/2022		Alm, Kim L
Include	reimbursement	Employee	02/14/2022		Dunn, Mary R
Include	5765	Direct	02/14/2022		Mike's Welding
Include	13256655	Direct	02/14/2022		Cash-wa Distribution
Include	January 2022 OT	Direct	02/14/2022		Johnson County Hospital
Include	January 2022 PT	Direct	02/14/2022		Johnson County Hospital
Include	10473408	Regular	02/14/2022	22-0024	Journey Ed
Include	192946	Direct	02/14/2022		CULLIGAN OF LINCOLN
Include	13262756, A13257613	Direct	02/14/2022		Cash-wa Distribution
Include	364029038, 364028742	Direct	02/14/2022		JW PEPPER & SON, INC
Include	Luke Boldt Physical	Direct	02/14/2022		Johnson County Hospital
Include	January cellphone	Employee	02/14/2022		Allen, Adrian W
Include	January cellphone	Employee	02/14/2022		DAVENPORT, JACOB M
Include	January cell phone	Employee	02/14/2022		Heusman, Brent J
Include	Jan Cell	Employee	02/14/2022		Boldt, Luke M
Include	Jan cellphone	Employee	02/14/2022		Boden, Ronald R
Include	jan cellphone	Employee	02/14/2022		Boslau, Dennis R

Include	january cellphone	Employee	02/14/2022		Wirthele, Cheri J
Include	WOB3JR0	Direct	02/14/2022		Nasco
Include	9768	Direct	02/14/2022		ESU #4
Include	O-911	Direct	02/14/2022		NCECBVI
Include	1304755	Direct	02/14/2022		DAS State Accounting - Central Finance

Payment Vendor	Comment	Invoice Amount
Menards		\$60.68
Nebraska Public Power Distric		\$2,332.03
WageWorks, Inc		\$86.75
Cash-wa Distribution		\$514.90
Cash-wa Distribution		\$20.61
PANKO		\$4,063.75
Village Of Sterling		\$50.00
DAS State Accounting - Central Finance		\$259.49
Johnson County Hospital		\$152.00
		\$35.10
Glaser Ceramics		\$478.45
OverDrive Education		\$250.00
School Health		\$51.71
Cash-wa Distribution		\$314.00
KLEIN HARDWARE HEATING & AIR		\$863.52
Amazon Capital Services		\$353.10
Amazon Capital Services		\$46.97
Amazon Capital Services		\$60.86
Amazon Capital Services		\$11.59
Beatrice Mechanical Service Inc		\$2,735.17
EDGERTON EXPLORIT CENTER		\$1,999.32
First Bank of Nebraska		\$20.00
United States Postal Service		\$20.85
T.O. Haas		\$2,923.38
The Home Depot Pro		\$39.02
Buss Pest Control		\$70.00
NCECBVI		\$547.80
WUSK ELECTRIC		\$354.84
Waymire Well Drilling, Inc.		\$32.35
ESU #4		\$22,500.00
Hancock Lumber, LLC		\$24.14
EGAN SUPPLY CO		\$724.95
EGAN SUPPLY CO		\$9.35
Nasco		\$84.45

SYSCO OF LINCOLN		\$5,017.47
Village Of Sterling		\$172.00
Tecumseh Chieftain		\$51.60
Nebraska Association Of Scbd		\$3,406.00
Blick art material		\$127.69
KSB SCHOOL LAW		\$154.00
ADAMS SUPER FOODS		\$25.45
Matheson Trigas DBA Linweld		\$34.62
KnowBe4		\$783.20
Cash-wa Distribution		\$1,806.27
UNITE PRIVATE NETWORKS, LLC		\$556.43
CAPITAL BUSINESS SYSTEMS, INC		\$934.43
Symmetry Energy Solutions, LLC		\$887.30
		\$105.18
Striv, Inc		\$1,975.00
HILAND DAIRY		\$1,811.29
WINDSTREAM COMMUNICATIONS, INC		\$669.04
Laffman Hot Rod Garage		\$233.20
FOLLETT SCHOOL SOLUTIONS INC		\$1,429.50
JET STOP INC.		\$2,208.15
NRCSA		\$130.00
PSAT/NMSQT		\$126.00
WINDSTREAM COMMUNICATIONS, INC		\$391.78
ESU #6		\$61.00
Staples		\$225.12
		\$112.18
		\$24.00
Mike's Welding		\$532.51
Cash-wa Distribution		\$591.43
Johnson County Hospital		\$1,476.15
Johnson County Hospital		\$174.80
Journey Ed		\$1,222.40
CULLIGAN OF LINCOLN		\$137.00
Cash-wa Distribution		\$1,530.72
JW PEPPER & SON, INC		\$67.99
Johnson County Hospital		\$152.00
		\$50.00
		\$50.00
		\$25.00
		\$25.00
		\$25.00
		\$25.00

		\$25.00
Nasco		\$35.50
ESU #4		\$45.00
NCECBVI		\$547.80
DAS State Accounting - Central Finance		\$259.49

Sterling Public Schools

Monthly Balance Forecast Report

Cycle: FY21/22; Begin Date: 09/01/2021; End Date: 02/28/2022; Account Type: Expenditure,Revenue; Account Expression: [All]; Created On

Expenditure				
Description	September	October	November	December
01100 - Regular Instruction	(\$276,328.11)	(\$9,482.22)	(\$132,274.84)	(\$135,586.03)
01190 - Early Childhood Educational Programs	(\$45,273.46)	(\$222.88)	(\$23,258.36)	(\$21,600.17)
01200 - Special Education Instructional Programs - School Age	(\$33,485.96)	(\$2,444.40)	(\$18,576.52)	(\$19,568.67)
01300 - Summer School	(\$1,439.42)	\$0.00	\$0.00	\$0.00
02120 - Guidance Services	(\$18,211.68)	(\$30.00)	(\$8,872.99)	(\$8,471.15)
02140 - Psychological Services	\$0.00	(\$576.00)	(\$768.00)	(\$1,024.00)
02141 - Psychological Services - SPED - School Age	\$0.00	(\$6,222.00)	(\$6,222.00)	(\$6,222.00)
02151 - Speech Pathology and Audiology Services - SPED - School Age	\$0.00	(\$5,203.50)	(\$5,203.50)	(\$5,203.50)
02152 - Speech Pathology and Audiology Services - SPED - Ages 3-5	(\$408.44)	\$0.00	\$0.00	\$0.00
02161 - Occupational Therapy-Related Services - SPED - School Age	(\$452.94)	(\$2,096.06)	(\$2,267.61)	(\$2,496.53)
02171 - Physical Therapy-Related Services - SPED - School Age	(\$34.50)	(\$101.50)	(\$204.60)	(\$370.00)
02181 - Visually Impaired or Vision Services - SPED - School Age	\$0.00	(\$1,095.60)	(\$555.09)	(\$547.80)
02190 - Support Services - Student - Other	(\$208.59)	\$0.00	\$0.00	(\$70.46)
02210 - Improvement of Instruction	\$0.00	\$0.00	\$0.00	\$0.00
02213 - Instructional Staff Training	(\$250.00)	\$0.00	(\$100.00)	\$0.00
02220 - Library or Media Services	(\$9,940.40)	(\$41.98)	(\$10,801.69)	(\$4,864.25)
02230 - Instruction-Related Technology	(\$31,377.50)	(\$77.50)	(\$6,080.45)	(\$633.93)
02310 - Board of Education	(\$182.12)	(\$554.76)	(\$2,623.70)	(\$806.76)
02320 - Executive Administration	(\$29,279.96)	(\$80.00)	(\$13,604.93)	(\$13,388.93)
02330 - District Legal Services	(\$1,693.84)	\$0.00	(\$248.00)	(\$3,962.00)
02410 - Office of the Principal	(\$25,818.94)	(\$50.00)	(\$13,685.36)	(\$12,775.23)
02510 - Fiscal Services	(\$9,408.86)	\$0.00	(\$4,230.40)	(\$13,553.89)
02520 - Purchasing, Warehousing, and Distributing Services	(\$3,000.00)	\$0.00	\$0.00	\$0.00
02530 - Printing, Publishing, and Duplicating Services	(\$769.81)	(\$1,169.31)	(\$993.05)	(\$879.50)
02570 - Personnel Services	(\$120.00)	\$0.00	(\$60.00)	(\$120.00)
02580 - Administrative Technology Service	\$0.00	(\$1,718.04)	(\$291.98)	\$0.00
02610 - Operation of Buildings	(\$52,460.91)	(\$10,792.56)	(\$12,664.63)	(\$11,106.81)
02620 - Maintenance of Buildings	(\$1,075.68)	(\$758.67)	(\$387.15)	(\$599.82)
02630 - Care and Upkeep of Grounds	(\$1,771.94)	(\$2,840.16)	(\$344.17)	(\$143.66)
02710 - Vehicle Operation and Purchasing - Regular Education	(\$22,160.78)	(\$150.00)	(\$12,357.05)	(\$10,374.85)
02730 - Vehicle Servicing and Maintenance - Regular Education	(\$1,529.36)	(\$1,407.64)	(\$4,074.08)	(\$5,132.06)
02732 - Vehicle Servicing and Maintenance - School Age SPED	\$0.00	(\$100.00)	(\$100.00)	\$0.00
02900 - Other Support Services	(\$25,618.14)	(\$9,851.34)	(\$8,756.71)	(\$11,199.72)
03100 - Food Services Operations	(\$22,180.24)	(\$21,014.78)	(\$12,588.90)	(\$12,448.69)
03300 - Community Services Operations	(\$560.19)	(\$247.59)	(\$112.36)	(\$447.11)
05000 - Debt Service	\$0.00	\$0.00	\$0.00	(\$237,112.50)
06200 - Federal Services - Title I, Part A ESSA Improving Basic Programs Operated by Local Educational Agencies	(\$16,604.88)	\$0.00	(\$8,314.68)	(\$8,292.44)
06408 - IDEA Part B (611) Base & Enrollment Poverty Allocation Ages 0-21	\$0.00	(\$2,929.68)	(\$2,929.69)	(\$2,929.68)
06997 - ESSERS 2	(\$14,130.18)	(\$3,099.00)	(\$4,220.18)	\$0.00
08000 - Transfers (Outgoing)	\$0.00	\$0.00	\$0.00	\$0.00
09000 - Non-Program Expenditure	\$0.00	\$0.00	\$0.00	\$0.00
Sub Total	(\$645,776.83)	(\$84,357.17)	(\$317,772.67)	(\$551,932.14)

Revenue				
Description	September	October	November	December
01100 - Taxes Levied/Assessed by the School District	\$852,578.76	\$148,936.91	\$42,993.44	\$18,370.64
01115 - Carline Taxes	\$1,619.01	\$0.00	\$0.00	\$0.00
01125 - Motor Vehicle Taxes	\$12,053.31	\$5,699.57	\$10,553.00	\$9,491.37
01140 - Penalties and Interest on Taxes	\$635.65	\$869.58	\$529.09	\$882.96
01190 - Other Taxes	\$25.00	\$0.00	\$0.00	\$0.00
01360 - Adult Education Tuition and Fees	\$0.00	\$0.00	\$0.00	\$0.00
01510 - Interest on Investments	\$43.00	\$147.62	\$27.47	\$21.95
01611 - Daily Sales?School Lunch Program	\$755.94	\$798.30	\$589.80	\$319.00
01710 - School Sponsor Activity	\$5,493.75	\$7,345.00	\$2,971.02	\$2,828.00
01730 - Student Organization Membership Dues and Fees	\$941.69	\$344.00	\$591.00	\$132.00
01740 - Fees	\$20.00	\$11.00	\$20.00	\$34.00
01790 - Other Activity Income	\$6,450.56	\$37,983.95	(\$18,273.90)	\$5,618.96
01800 - Revenue From Community Services Activities	\$252.00	\$1,126.00	\$758.00	\$330.00
01911 - Local License Fees	\$300.00	\$0.00	\$48.43	\$0.00
01920 - Contributions and Donations From Private Sources	\$723.00	\$150.00	\$393.99	\$300.00
01960 - Miscellaneous Revenues from Other Local Governmental Units	\$3,377.12	\$0.00	\$0.00	\$0.00
01980 - Refund of Prior Year?s Expenditures	\$675.00	\$0.00	\$0.00	\$0.00
01990 - Miscellaneous Local Revenue	\$0.00	\$0.00	\$56.61	\$1,300.00
02110 - County Fines & License Fees	\$105.76	\$0.00	\$240.60	\$93.21
02130 - Other County Receipts	\$653.58	\$470.73	\$404.26	\$308.19
03110 - State Aid	\$9,836.00	\$9,836.00	\$9,836.00	\$9,836.00
03120 - SPED (School Age)	\$0.00	\$0.00	\$0.00	\$21,600.00
03130 - Homestead Exemption	\$0.00	\$24.61	\$0.00	\$0.00
03180 - Pro-Rate Motor Vehicle	\$0.00	\$864.26	\$213.63	\$0.00
03535 - Payment for High Ability Learners	\$0.00	\$0.00	\$3,164.00	\$0.00
04210 - Federal Nutrition Programs	\$0.00	\$26,799.45	\$13,741.44	\$12,548.36
04509 - Title II, Part A, ESSA Supporting Effective Instruction	\$0.00	\$0.00	\$9,042.87	\$0.00
04516 - IDEA Preschool (619) Base/IDEA Enrollment Poverty (619) Allocation	\$0.00	\$0.00	\$0.00	\$5,094.00
04708 - Medicaid in Public Schools	\$0.00	\$0.00	\$0.00	\$994.03
09000 - Non-Program Receipts	\$0.00	\$0.00	\$0.00	\$0.00
Sub Total	\$896,539.13	\$241,406.98	\$77,900.75	\$90,102.67
Grand Total	\$250,762.30	\$157,049.81	(\$239,871.92)	(\$461,829.47)

1: 2/17/2022 12:21:34 PM

January	February	Total (Date Range)	Budget (YTD)
(\$129,181.83)	(\$130,839.20)	(\$813,692.23)	\$0.00
(\$22,687.28)	(\$21,770.55)	(\$134,812.70)	\$0.00
(\$19,826.73)	(\$17,883.22)	(\$111,785.50)	\$0.00
\$0.00	\$0.00	(\$1,439.42)	\$0.00
(\$9,712.22)	(\$8,602.96)	(\$53,901.00)	\$0.00
(\$704.00)	\$0.00	(\$3,072.00)	\$0.00
(\$6,222.00)	\$0.00	(\$24,888.00)	\$0.00
(\$5,203.50)	\$0.00	(\$20,814.00)	\$0.00
\$0.00	\$0.00	(\$408.44)	\$0.00
(\$778.58)	(\$1,476.15)	(\$9,567.87)	\$0.00
(\$174.80)	(\$174.80)	(\$1,060.20)	\$0.00
\$0.00	(\$1,095.60)	(\$3,294.09)	\$0.00
(\$82.18)	(\$93.96)	(\$455.19)	\$0.00
(\$2,405.00)	\$0.00	(\$2,405.00)	\$0.00
(\$75.00)	\$0.00	(\$425.00)	\$0.00
(\$4,079.43)	(\$5,857.06)	(\$35,584.81)	\$0.00
(\$617.43)	(\$23,117.43)	(\$61,904.24)	\$0.00
(\$3,927.80)	(\$3,656.25)	(\$11,751.39)	\$0.00
(\$14,589.95)	(\$13,376.93)	(\$84,320.70)	\$0.00
(\$46.00)	(\$154.00)	(\$6,103.84)	\$0.00
(\$11,931.78)	(\$12,727.80)	(\$76,989.11)	\$0.00
(\$3,850.26)	(\$4,228.20)	(\$35,271.61)	\$0.00
\$0.00	\$0.00	(\$3,000.00)	\$0.00
(\$1,005.92)	(\$934.43)	(\$5,752.02)	\$0.00
\$0.00	\$0.00	(\$300.00)	\$0.00
\$0.00	(\$3,793.00)	(\$5,803.02)	\$0.00
(\$12,337.11)	(\$12,332.68)	(\$111,694.70)	\$0.00
(\$255.48)	(\$325.48)	(\$3,402.28)	\$0.00
(\$230.77)	(\$525.58)	(\$5,856.28)	\$0.00
(\$11,491.67)	(\$11,678.23)	(\$68,212.58)	\$0.00
\$0.00	(\$7,580.33)	(\$19,723.47)	\$0.00
\$0.00	\$0.00	(\$200.00)	\$0.00
(\$21,706.38)	(\$16,715.64)	(\$93,847.93)	\$0.00
(\$8,145.96)	(\$19,941.67)	(\$96,320.24)	\$0.00
(\$185.62)	(\$77.68)	(\$1,630.55)	\$0.00
\$0.00	\$0.00	(\$237,112.50)	\$0.00
(\$8,277.44)	(\$8,277.44)	(\$49,766.88)	\$0.00
(\$2,929.68)	\$0.00	(\$11,718.73)	\$0.00
\$0.00	\$0.00	(\$21,449.36)	\$0.00
\$0.00	\$0.00	\$0.00	\$0.00
\$0.00	\$0.00	\$0.00	\$0.00
(\$302,661.80)	(\$327,236.27)	(\$2,229,736.88)	\$0.00

January	February	Total (Date Range)	Budget (YTD)
\$448,685.39	\$0.00	\$1,511,565.14	\$0.00
\$0.00	\$0.00	\$1,619.01	\$0.00
\$13,422.08	\$0.00	\$51,219.33	\$0.00
\$1,040.29	\$0.00	\$3,957.57	\$0.00
\$0.00	\$0.00	\$25.00	\$0.00
\$14,546.35	\$0.00	\$14,546.35	\$0.00
\$24.94	\$0.00	\$264.98	\$0.00
\$799.36	\$0.00	\$3,262.40	\$0.00
\$3,928.50	\$0.00	\$22,566.27	\$0.00
\$591.00	\$0.00	\$2,599.69	\$0.00
\$50.00	\$0.00	\$135.00	\$0.00
\$9,968.25	\$0.00	\$41,747.82	\$0.00
\$420.00	\$0.00	\$2,886.00	\$0.00
\$30.00	\$0.00	\$378.43	\$0.00
\$1,500.00	\$0.00	\$3,066.99	\$0.00
\$0.00	\$0.00	\$3,377.12	\$0.00
\$0.00	\$0.00	\$675.00	\$0.00
\$5,102.00	\$0.00	\$6,458.61	\$0.00
\$135.66	\$0.00	\$575.23	\$0.00
\$374.44	\$0.00	\$2,211.20	\$0.00
\$9,836.00	\$0.00	\$49,180.00	\$0.00
\$19,658.00	\$0.00	\$41,258.00	\$0.00
\$0.00	\$0.00	\$24.61	\$0.00
\$1,769.23	\$0.00	\$2,847.12	\$0.00
\$0.00	\$0.00	\$3,164.00	\$0.00
\$10,332.73	\$0.00	\$63,421.98	\$0.00
\$0.00	\$0.00	\$9,042.87	\$0.00
\$51,623.00	\$0.00	\$56,717.00	\$0.00
\$0.00	\$0.00	\$994.03	\$0.00
\$0.00	\$0.00	\$0.00	\$0.00
\$593,837.22	\$0.00	\$1,899,786.75	\$0.00
\$291,175.42	(\$327,236.27)	(\$329,950.13)	\$0.00

Sterling Public Schools

Cash Summary Report

Accounting Cycle: FY21/22; Beginning Period: Period 01 (09/01/2021 - 09/30/2021) ; Ending Period: Period 05 (01/01/2022 - 01/31/2022) ; Show Prior Year Expense/Encumbrance: No; Prior Year Expense/Encumbrance: No; Include Transactions after the Last Period: None; Exclude Closing Entries: No; Include Unposted Transactions: Yes; Created On: 2/17/2022 12:27:25 PM

Fund	Description	Beginning Balance	Revenue	Expenditure	Other	Ending Balance	Encumbrances
01	General Fund	\$181,766.49	\$1,594,128.18	(\$1,498,660.12)	\$0.00	\$277,234.55	(\$3,394.78)
02	Depreciation Fund	\$336,056.37	\$0.00	(\$7,211.34)	\$0.00	\$328,845.03	\$0.00
05	Activity Fund	\$25,209.68	\$69,730.38	(\$70,772.36)	\$0.00	\$24,167.70	\$0.00
06	School Nutrition Fund	\$32,595.77	\$66,684.38	(\$76,378.57)	\$0.00	\$22,901.58	\$0.00
07	Bond Fund	\$121,924.38	\$79,460.84	(\$168,893.75)	\$0.00	\$32,491.47	\$0.00
08	Special Building Fund	\$466,789.43	\$42,692.28	\$0.00	\$0.00	\$509,481.71	\$0.00
09	QCPUF Fund	\$90,973.18	\$32,533.34	(\$68,218.75)	\$0.00	\$55,287.77	\$0.00
10	Cooperative Fund	\$9,140.33	\$14,546.35	(\$12,197.41)	\$0.00	\$11,489.27	\$0.00
12	Student Fees Fund	\$4,978.75	\$11.00	(\$168.31)	\$0.00	\$4,821.44	\$0.00
Sub Total		\$1,269,434.38	\$1,899,786.75	(\$1,902,500.61)	\$0.00	\$1,266,720.52	(\$3,394.78)

Year Ending Balance for Beginning Balance:

Liabilities	Available
\$0.00	\$273,839.77
\$0.00	\$328,845.03
\$0.00	\$24,167.70
\$0.00	\$22,901.58
\$0.00	\$32,491.47
\$0.00	\$509,481.71
\$0.00	\$55,287.77
\$0.00	\$11,489.27
\$0.00	\$4,821.44
\$0.00	\$1,263,325.74

Sterling Public Schools

Cash Summary Report

Accounting Cycle: FY21/22; Beginning Period: Period 01 (09/01/2021 - 09/30/2021) ; Ending Period: Period 05 (01/01/2022 - 01/31/2022) ; Show Prior Year Expense/Encumbrance: No; Prior Year Ending Balance for Beginning Balance: Yes; Include Transactions after the Last Period: None; Exclude Closing Entries: No; Include Unposted Transactions: Yes; Created On: 2/17/2022 12:27:25 PM

Fund	Description	Liabilities (Beginning)	Liabilities (Ending)	Cash Journal Entries	Other Total
01	General Fund	\$0.00	\$0.00	\$0.00	\$0.00
02	Depreciation Fund	\$0.00	\$0.00	\$0.00	\$0.00
05	Activity Fund	\$0.00	\$0.00	\$0.00	\$0.00
06	School Nutrition Fund	\$0.00	\$0.00	\$0.00	\$0.00
07	Bond Fund	\$0.00	\$0.00	\$0.00	\$0.00
08	Special Building Fund	\$0.00	\$0.00	\$0.00	\$0.00
09	QCPUF Fund	\$0.00	\$0.00	\$0.00	\$0.00
10	Cooperative Fund	\$0.00	\$0.00	\$0.00	\$0.00
12	Student Fees Fund	\$0.00	\$0.00	\$0.00	\$0.00
Sub Total		\$0.00	\$0.00	\$0.00	\$0.00

Sterling Public Schools

Account Summary Report

Cycle: FY21/22; Begin Date: 09/01/2021; End Date: 02/28/2022; Account Type: Expenditure,Revenue; Subtotal Elements: [None]; Account Expression: [All]; Subtotal By Account Type: No; Include Created On: 2/17/2022 12:28:25 PM

Account Code	Description	Actual (Date Range)	Budget (YTD)	Actual (YTD)	Encumbrance (YTD)	Available (YTD)
01-1-01100-000-000	Taxes Levied/Assessed by the School District	(\$1,357,746.51)	\$0.00	(\$1,357,746.51)	\$0.00	\$1,357,746.51
01-1-01115-000-000	CARLINE TAXES	(\$1,454.77)	\$0.00	(\$1,454.77)	\$0.00	\$1,454.77
01-1-01125-000-000	MOTOR VEHICLE TAXES	(\$51,219.33)	\$0.00	(\$51,219.33)	\$0.00	\$51,219.33
01-1-01140-000-000	Penalties and Interest on Taxes	(\$3,546.83)	\$0.00	(\$3,546.83)	\$0.00	\$3,546.83
01-1-01190-000-000	Other Taxes	(\$25.00)	\$0.00	(\$25.00)	\$0.00	\$25.00
01-1-01510-000-000	INTEREST	(\$170.38)	\$0.00	(\$170.38)	\$0.00	\$170.38
01-1-01800-000-000	COMMUNITY SERVICE ACTIVITIES	(\$2,886.00)	\$0.00	(\$2,886.00)	\$0.00	\$2,886.00
01-1-01911-000-000	LOCAL LICENSE FEES	(\$378.43)	\$0.00	(\$378.43)	\$0.00	\$378.43
01-1-01920-000-000	CONTRIBUTIONS AND DONATIONS	(\$468.99)	\$0.00	(\$468.99)	\$0.00	\$468.99
01-1-01960-000-000	Miscellaneous Revenues from Other Local Governmental Units	(\$3,377.12)	\$0.00	(\$3,377.12)	\$0.00	\$3,377.12
01-1-01980-000-000	Refund of Prior Year?s Expenditures	(\$675.00)	\$0.00	(\$675.00)	\$0.00	\$675.00
01-1-01990-000-000	OTHER LOCAL RECEIPTS	(\$6,458.61)	\$0.00	(\$6,458.61)	\$0.00	\$6,458.61
01-1-02110-000-000	COUNTY FINES AND LICENSE FEES	(\$575.23)	\$0.00	(\$575.23)	\$0.00	\$575.23
01-1-02130-000-000	OTHER COUNTY RECEIPTS	(\$2,211.20)	\$0.00	(\$2,211.20)	\$0.00	\$2,211.20
01-1-03110-000-000	STATE AID	(\$49,180.00)	\$0.00	(\$49,180.00)	\$0.00	\$49,180.00
01-1-03120-000-000	SPECIAL EDUCATION PROGRAMS	(\$41,258.00)	\$0.00	(\$41,258.00)	\$0.00	\$41,258.00
01-1-03180-000-000	PRO-RATE MOTOR VEHICLE	(\$2,578.88)	\$0.00	(\$2,578.88)	\$0.00	\$2,578.88
01-1-03535-000-000	PAYMENTS FOR HIGH ABILITY LEARNERS	(\$3,164.00)	\$0.00	(\$3,164.00)	\$0.00	\$3,164.00
01-1-04509-000-000	TITLE II, PART A NCLB TEACHER QUALITY GRANTS	(\$9,042.87)	\$0.00	(\$9,042.87)	\$0.00	\$9,042.87
01-1-04516-000-000	IDEA PRESCHOOL(619) BASE/IDEA FNROI I MFNT/POVERTY	(\$56,717.00)	\$0.00	(\$56,717.00)	\$0.00	\$56,717.00
01-1-04708-000-000	MEDICAID IN PUBLIC SCHOOLS	(\$994.03)	\$0.00	(\$994.03)	\$0.00	\$994.03
01-2-01100-111-001	REGULAR INSTRUCTIONAL PROGRAMS	\$267,120.90	\$0.00	\$267,120.90	\$0.00	(\$267,120.90)
01-2-01100-111-002	REGULAR INSTRUCTIONAL PROGRAMS	\$171,322.86	\$0.00	\$171,322.86	\$0.00	(\$171,322.86)
01-2-01100-112-002	REGULAR INSTRUCTIONAL PROGRAMS	\$16,803.14	\$0.00	\$16,803.14	\$0.00	(\$16,803.14)
01-2-01100-113-001	REGULAR INSTRUCTIONAL PROGRAMS	\$5,217.00	\$0.00	\$5,217.00	\$0.00	(\$5,217.00)
01-2-01100-113-002	REGULAR INSTRUCTIONAL PROGRAMS	\$5,217.00	\$0.00	\$5,217.00	\$0.00	(\$5,217.00)
01-2-01100-123-001	REGULAR INSTRUCTIONAL PROGRAMS	\$6,828.00	\$0.00	\$6,828.00	\$0.00	(\$6,828.00)
01-2-01100-123-002	REGULAR INSTRUCTIONAL PROGRAMS	\$10,368.00	\$0.00	\$10,368.00	\$0.00	(\$10,368.00)
01-2-01100-151-001	REGULAR INSTRUCTIONAL PROGRAMS	\$33,376.63	\$0.00	\$33,376.63	\$0.00	(\$33,376.63)
01-2-01100-151-002	REGULAR INSTRUCTIONAL PROGRAMS	\$1,382.50	\$0.00	\$1,382.50	\$0.00	(\$1,382.50)
01-2-01100-156-001	REGULAR INSTRUCTIONAL PROGRAMS	\$8,628.32	\$0.00	\$8,628.32	\$0.00	(\$8,628.32)
01-2-01100-211-001	REGULAR INSTRUCTIONAL PROGRAMS	\$79,827.29	\$0.00	\$79,827.29	\$0.00	(\$79,827.29)
01-2-01100-211-002	REGULAR INSTRUCTIONAL PROGRAMS	\$34,510.61	\$0.00	\$34,510.61	\$0.00	(\$34,510.61)
01-2-01100-221-001	REGULAR INSTRUCTIONAL PROGRAMS	\$24,179.25	\$0.00	\$24,179.25	\$0.00	(\$24,179.25)
01-2-01100-221-002	REGULAR INSTRUCTIONAL PROGRAMS	\$13,018.85	\$0.00	\$13,018.85	\$0.00	(\$13,018.85)

01-2-01100-222-002	REGULAR INSTRUCTIONAL PROGRAMS	\$1,265.29	\$0.00	\$1,265.29	\$0.00	(\$1,265.29)
01-2-01100-223-001	REGULAR INSTRUCTIONAL PROGRAMS	\$917.09	\$0.00	\$917.09	\$0.00	(\$917.09)
01-2-01100-223-002	REGULAR INSTRUCTIONAL PROGRAMS	\$1,187.59	\$0.00	\$1,187.59	\$0.00	(\$1,187.59)
01-2-01100-225-000	REGULAR INSTRUCTIONAL PROGRAMS	\$3.12	\$0.00	\$3.12	\$0.00	(\$3.12)
01-2-01100-226-001	REGULAR INSTRUCTIONAL PROGRAMS	\$660.04	\$0.00	\$660.04	\$0.00	(\$660.04)
01-2-01100-231-001	REGULAR INSTRUCTIONAL PROGRAMS	\$28,468.03	\$0.00	\$28,468.03	\$0.00	(\$28,468.03)
01-2-01100-231-002	REGULAR INSTRUCTIONAL PROGRAMS	\$17,059.54	\$0.00	\$17,059.54	\$0.00	(\$17,059.54)
01-2-01100-232-002	REGULAR INSTRUCTIONAL PROGRAMS	\$1,659.79	\$0.00	\$1,659.79	\$0.00	(\$1,659.79)
01-2-01100-233-001	REGULAR INSTRUCTIONAL PROGRAMS	\$515.34	\$0.00	\$515.34	\$0.00	(\$515.34)
01-2-01100-233-002	REGULAR INSTRUCTIONAL PROGRAMS	\$515.34	\$0.00	\$515.34	\$0.00	(\$515.34)
01-2-01100-270-000	Regular Instruction-Worker?s Compensation Paid for Non-Instructional	\$8,173.00	\$0.00	\$8,173.00	\$0.00	(\$8,173.00)
01-2-01100-271-000	Regular Instruction-Worker?s Compensation Paid for Teachers/Professional Staff	\$6,323.00	\$0.00	\$6,323.00	\$0.00	(\$6,323.00)
01-2-01100-272-000	Regular Instruction-Worker?s Compensation Paid for Instructional Aides or Assistants	\$3,603.00	\$0.00	\$3,603.00	\$0.00	(\$3,603.00)
01-2-01100-275-000	Regular Instruction-Worker?s Compensation for Suerintendents	\$2,120.00	\$0.00	\$2,120.00	\$0.00	(\$2,120.00)
01-2-01100-281-001	REGULAR INSTRUCTIONAL PROGRAMS	\$18,000.00	\$0.00	\$18,000.00	\$0.00	(\$18,000.00)
01-2-01100-330-001	REGULAR INSTRUCTIONAL PROGRAMS	\$405.00	\$0.00	\$405.00	\$0.00	(\$405.00)
01-2-01100-330-002	REGULAR INSTRUCTIONAL PROGRAMS	\$160.00	\$0.00	\$160.00	\$0.00	(\$160.00)
01-2-01100-382-000	REGULAR INSTRUCTIONAL PROGRAMS	\$1,816.43	\$0.00	\$1,816.43	\$0.00	(\$1,816.43)
01-2-01100-580-001	REGULAR INSTRUCTIONAL PROGRAMS	\$116.18	\$0.00	\$116.18	\$0.00	(\$116.18)
01-2-01100-610-000	REGULAR INSTRUCTIONAL PROGRAMS	\$6,220.67	\$0.00	\$6,220.67	\$0.00	(\$6,220.67)
01-2-01100-610-001	REGULAR INSTRUCTIONAL PROGRAMS	\$7,571.61	\$0.00	\$7,571.61	\$0.00	(\$7,571.61)
01-2-01100-610-002	REGULAR INSTRUCTIONAL PROGRAMS	\$4,971.11	\$0.00	\$4,971.11	\$0.00	(\$4,971.11)
01-2-01100-640-001	REGULAR INSTRUCTIONAL PROGRAMS	\$3,053.46	\$0.00	\$3,053.46	\$0.00	(\$3,053.46)
01-2-01100-640-002	REGULAR INSTRUCTIONAL PROGRAMS	\$1,474.69	\$0.00	\$1,474.69	\$0.00	(\$1,474.69)
01-2-01100-641-001	REGULAR INSTRUCTIONAL PROGRAMS	\$1,644.02	\$0.00	\$1,644.02	\$0.00	(\$1,644.02)
01-2-01100-643-001	REGULAR INSTRUCTIONAL PROGRAMS	\$80.00	\$0.00	\$80.00	\$0.00	(\$80.00)
01-2-01100-733-002	Regular Instruction-Furniture and Fixtures-Elem	\$964.29	\$0.00	\$964.29	\$0.00	(\$964.29)
01-2-01100-810-001	Regular Instruction-Dues and Fees-Sec	\$139.75	\$0.00	\$139.75	\$0.00	(\$139.75)
01-2-01100-890-002	Regular Instruction-Miscellaneous Expenditures- Elem	\$1,999.32	\$0.00	\$1,999.32	\$0.00	(\$1,999.32)
01-2-01190-111-002	Early Childhood Educational Programs-Salaries of Regular Employees Paid to Teachers/Professional Staff- Elem	\$80,559.96	\$0.00	\$80,559.96	\$0.00	(\$80,559.96)
01-2-01190-112-002	Early Childhood Educational Programs-Salaries of Regular Employees Paid to Instructional Aides and Assicantns- Elem	\$8,912.54	\$0.00	\$8,912.54	\$0.00	(\$8,912.54)
01-2-01190-113-002	Early Childhood Educational Programs-Salaries of Regular Employees Paid to Substitute Teachers- Elem	\$3,000.00	\$0.00	\$3,000.00	\$0.00	(\$3,000.00)
01-2-01190-211-002	Early Childhood Educational Programs-Group Insurance for Teachers/Professional Staff- Elem	\$25,050.62	\$0.00	\$25,050.62	\$0.00	(\$25,050.62)
01-2-01190-221-002	Early Childhood Educational Programs-Social Security Payments for Teachers/Professional Staff- Elem	\$5,471.73	\$0.00	\$5,471.73	\$0.00	(\$5,471.73)
01-2-01190-222-002	Early Childhood Educational Programs-Social Security Payments for Instructional Aides or Assicantns- Elem	\$681.82	\$0.00	\$681.82	\$0.00	(\$681.82)

01-2-01190-223-002	Early Childhood Educational Programs-Social Security Payments for Substitute Teachers-Flem	\$229.50	\$0.00	\$229.50	\$0.00	(\$229.50)
01-2-01190-231-002	Early Childhood Educational Programs-Retirement Contributions for Teachers/Professional Staff-Flem	\$7,957.56	\$0.00	\$7,957.56	\$0.00	(\$7,957.56)
01-2-01190-232-002	Early Childhood Educational Programs-Retirement Contributions for Instructional Aides or Assistants-Flem	\$880.36	\$0.00	\$880.36	\$0.00	(\$880.36)
01-2-01190-330-002	Early Childhood Educational Programs-Employee Training and Development Services-Flem	\$50.00	\$0.00	\$50.00	\$0.00	(\$50.00)
01-2-01190-610-002	Early Childhood Educational Programs-General Supplies-Flem	\$2,018.61	\$0.00	\$2,018.61	\$0.00	(\$2,018.61)
01-2-01200-111-001	Special Education Instructional Programs - School Age-Salaries of Regular Employees Paid to Teachers/Professional Staff-Sec	\$28,120.02	\$0.00	\$28,120.02	\$0.00	(\$28,120.02)
01-2-01200-111-002	Special Education Instructional Programs - School Age-Salaries of Regular Employees Paid to Teachers/Professional Staff-Flem	\$19,000.02	\$0.00	\$19,000.02	\$0.00	(\$19,000.02)
01-2-01200-112-001	Special Education Instructional Programs - School Age-Salaries of Regular Employees Paid to Instructional Aides and Assistants-Sec	\$12,962.76	\$0.00	\$12,962.76	\$0.00	(\$12,962.76)
01-2-01200-112-002	Special Education Instructional Programs - School Age-Salaries of Regular Employees Paid to Instructional Aides and Assistants-Flem	\$15,270.60	\$0.00	\$15,270.60	\$0.00	(\$15,270.60)
01-2-01200-211-001	Special Education Instructional Programs - School Age-Group Insurance for Teachers/Professional Staff-Sec	\$12,848.48	\$0.00	\$12,848.48	\$0.00	(\$12,848.48)
01-2-01200-211-002	Special Education Instructional Programs - School Age-Group Insurance for Teachers/Professional Staff-Flem	\$83.28	\$0.00	\$83.28	\$0.00	(\$83.28)
01-2-01200-221-001	Special Education Instructional Programs - School Age-Social Security Payments for Teachers/Professional Staff-Sec	\$1,638.26	\$0.00	\$1,638.26	\$0.00	(\$1,638.26)
01-2-01200-221-002	Special Education Instructional Programs - School Age-Social Security Payments for Teachers/Professional Staff-Flem	\$1,454.07	\$0.00	\$1,454.07	\$0.00	(\$1,454.07)
01-2-01200-222-001	Special Education Instructional Programs - School Age-Social Security Payments for Instructional Aides or Assistants-Sec	\$975.01	\$0.00	\$975.01	\$0.00	(\$975.01)
01-2-01200-222-002	Special Education Instructional Programs - School Age-Social Security Payments for Instructional Aides or Assistants-Flem	\$1,096.40	\$0.00	\$1,096.40	\$0.00	(\$1,096.40)
01-2-01200-231-001	Special Education Instructional Programs - School Age-Retirement Contributions for Teachers/Professional Staff-Sec	\$2,777.64	\$0.00	\$2,777.64	\$0.00	(\$2,777.64)
01-2-01200-231-002	Special Education Instructional Programs - School Age-Retirement Contributions for Teachers/Professional Staff-Flem	\$1,876.80	\$0.00	\$1,876.80	\$0.00	(\$1,876.80)
01-2-01200-232-001	Special Education Instructional Programs - School Age-Retirement Contributions for Instructional Aides or Assistants-Sec	\$1,280.43	\$0.00	\$1,280.43	\$0.00	(\$1,280.43)
01-2-01200-232-002	Special Education Instructional Programs - School Age-Retirement Contributions for Instructional Aides or Assistants-Flem	\$1,508.40	\$0.00	\$1,508.40	\$0.00	(\$1,508.40)
01-2-01200-330-001	Special Education Instructional Programs - School Age-Employee Training and Development Services-Sec	\$200.00	\$0.00	\$200.00	\$0.00	(\$200.00)
01-2-01200-330-002	Special Education Instructional Programs - School Age-Employee Training and Development Services-Flem	\$40.00	\$0.00	\$40.00	\$0.00	(\$40.00)

01-2-01200-591-001	Special Education Instructional Programs - School Age-Services Purchased From Another School District or Educational Services Agency Within the State-Sec	\$4,798.80	\$0.00	\$4,798.80	\$0.00	(\$4,798.80)
01-2-01200-591-002	Special Education Instructional Programs - School Age-Services Purchased From Another School District or Educational Services Agency Within the State-Sec	\$4,798.80	\$0.00	\$4,798.80	\$0.00	(\$4,798.80)
01-2-01200-610-002	Special Education Instructional Programs - School Age-General Supplies-Elem	\$961.74	\$0.00	\$961.74	\$0.00	(\$961.74)
01-2-01200-733-002	Special Education Instructional Programs - School Age-Furniture and Fixtures-Elem	\$93.99	\$0.00	\$93.99	\$0.00	(\$93.99)
01-2-01300-111-002	Summer School-Salaries of Regular Employees Paid to Teachers/Professional Staff-Elem	\$1,225.00	\$0.00	\$1,225.00	\$0.00	(\$1,225.00)
01-2-01300-221-002	Summer School-Social Security Payments for Teachers/Professional Staff-Elem	\$93.42	\$0.00	\$93.42	\$0.00	(\$93.42)
01-2-01300-231-002	Summer School-Retirement Contributions for Teachers/Professional Staff-Elem	\$121.00	\$0.00	\$121.00	\$0.00	(\$121.00)
01-2-02120-111-001	Guidance Services-Salaries of Regular Employees Paid to Teachers/Professional Staff-Sec	\$16,340.04	\$0.00	\$16,340.04	\$0.00	(\$16,340.04)
01-2-02120-111-002	Guidance Services-Salaries of Regular Employees Paid to Teachers/Professional Staff-Elem	\$16,339.98	\$0.00	\$16,339.98	\$0.00	(\$16,339.98)
01-2-02120-151-001	Guidance Services-Additional Compensation Paid to Teachers/Professional Staff-Sec	\$895.14	\$0.00	\$895.14	\$0.00	(\$895.14)
01-2-02120-151-002	Guidance Services-Additional Compensation Paid to Teachers/Professional Staff-Elem	\$895.20	\$0.00	\$895.20	\$0.00	(\$895.20)
01-2-02120-211-001	Guidance Services-Group Insurance for Teachers/Professional Staff-Sec	\$6,429.88	\$0.00	\$6,429.88	\$0.00	(\$6,429.88)
01-2-02120-211-002	Guidance Services-Group Insurance for Teachers/Professional Staff-Elem	\$6,429.82	\$0.00	\$6,429.82	\$0.00	(\$6,429.82)
01-2-02120-221-001	Guidance Services-Social Security Payments for Teachers/Professional Staff-Sec	\$1,239.49	\$0.00	\$1,239.49	\$0.00	(\$1,239.49)
01-2-02120-221-002	Guidance Services-Social Security Payments for Teachers/Professional Staff-Elem	\$1,239.54	\$0.00	\$1,239.54	\$0.00	(\$1,239.54)
01-2-02120-231-001	Guidance Services-Retirement Contributions for Teachers/Professional Staff-Sec	\$1,702.44	\$0.00	\$1,702.44	\$0.00	(\$1,702.44)
01-2-02120-231-002	Guidance Services-Retirement Contributions for Teachers/Professional Staff-Elem	\$1,702.44	\$0.00	\$1,702.44	\$0.00	(\$1,702.44)
01-2-02120-330-000	Guidance Services-Employee Training and Development Services	\$22.50	\$0.00	\$22.50	\$0.00	(\$22.50)
01-2-02120-330-001	Guidance Services-Employee Training and Development Services-Sec	\$70.00	\$0.00	\$70.00	\$0.00	(\$70.00)
01-2-02120-330-002	Guidance Services-Employee Training and Development Services-Elem	\$50.00	\$0.00	\$50.00	\$0.00	(\$50.00)
01-2-02120-565-001	Guidance Services-Tuition to Postsecondary Schools-Sec	\$246.50	\$0.00	\$246.50	\$0.00	(\$246.50)
01-2-02120-610-001	Guidance Services-General Supplies-Sec	\$86.02	\$0.00	\$86.02	\$0.00	(\$86.02)
01-2-02120-610-002	Guidance Services-General Supplies-Elem	\$86.01	\$0.00	\$86.01	\$0.00	(\$86.01)
01-2-02120-810-000	Guidance Services-Dues and Fees	\$126.00	\$0.00	\$126.00	\$0.00	(\$126.00)
01-2-02140-320-001	Psychological Services-Professional Educational Services-Sec	\$3,072.00	\$0.00	\$3,072.00	\$0.00	(\$3,072.00)
01-2-02141-591-001	Psychological Services - SPED - School Age-Services Purchased From Another School District or Educational Services Agency Within the State-Sec	\$12,444.00	\$0.00	\$12,444.00	\$0.00	(\$12,444.00)
01-2-02141-591-002	Psychological Services - SPED - School Age-Services Purchased From Another School District or Educational Services Agency Within the State-Elem	\$12,444.00	\$0.00	\$12,444.00	\$0.00	(\$12,444.00)

01-2-02151-591-001	Speech Pathology and Audiology Services - SPED - School Age-Services Purchased From Another School District or Educational Services Agency Within the State Sec	\$3,687.00	\$0.00	\$3,687.00	\$0.00	(\$3,687.00)
01-2-02151-591-002	Speech Pathology and Audiology Services - SPED - School Age-Services Purchased From Another School District or Educational Services Agency Within the State Elem	\$17,127.00	\$0.00	\$17,127.00	\$0.00	(\$17,127.00)
01-2-02152-334-002	Speech Pathology and Audiology Services - SPED - Ages 3-5--Elem	\$268.08	\$0.00	\$268.08	\$0.00	(\$268.08)
01-2-02152-591-002	Speech Pathology and Audiology Services - SPED - Ages 3-5-Services Purchased From Another School District or Educational Services Agency Within the State Elem	\$140.36	\$0.00	\$140.36	\$0.00	(\$140.36)
01-2-02161-334-000	Occupational Therapy-Related Services - SPED - School Age-	\$2,030.22	\$0.00	\$2,030.22	\$0.00	(\$2,030.22)
01-2-02161-591-002	Occupational Therapy-Related Services - SPED - School Age-Services Purchased From Another School District or Educational Services Agency Within the State Elem	\$7,537.65	\$0.00	\$7,537.65	\$0.00	(\$7,537.65)
01-2-02171-334-000	Physical Therapy-Related Services - SPED - School Age-	\$186.20	\$0.00	\$186.20	\$0.00	(\$186.20)
01-2-02171-591-002	Physical Therapy-Related Services - SPED - School Age-Services Purchased From Another School District or Educational Services Agency Within the State Elem	\$874.00	\$0.00	\$874.00	\$0.00	(\$874.00)
01-2-02181-591-002	Visually Impaired or Vision Services - SPED - School Age-Services Purchased From Another School District or Educational Services Agency Within the State Elem	\$3,294.09	\$0.00	\$3,294.09	\$0.00	(\$3,294.09)
01-2-02190-110-000	OTHER PUPIL SUPPORT SERVICES	\$387.60	\$0.00	\$387.60	\$0.00	(\$387.60)
01-2-02190-220-000	OTHER PUPIL SUPPORT SERVICES	\$29.31	\$0.00	\$29.31	\$0.00	(\$29.31)
01-2-02190-230-000	Support Services - Student - Other-Retirement Contributions for Non-Instructional	\$38.28	\$0.00	\$38.28	\$0.00	(\$38.28)
01-2-02210-810-000	Improvement of Instruction-Dues and Fees	\$2,405.00	\$0.00	\$2,405.00	\$0.00	(\$2,405.00)
01-2-02213-330-001	Instructional Staff Training-Employee Training and Development Services--Sec	\$425.00	\$0.00	\$425.00	\$0.00	(\$425.00)
01-2-02220-111-002	Library or Media Services-Salaries of Regular Employees Paid to Teachers/Professional Staff-Elem	\$20,748.00	\$0.00	\$20,748.00	\$0.00	(\$20,748.00)
01-2-02220-211-002	SCHOOL LIBRARY SERVICES	\$89.64	\$0.00	\$89.64	\$0.00	(\$89.64)
01-2-02220-221-002	Library or Media Services-Social Security Payments for Teachers/Professional Staff-Elem	\$1,591.07	\$0.00	\$1,591.07	\$0.00	(\$1,591.07)
01-2-02220-231-002	SCHOOL LIBRARY SERVICES	\$2,049.43	\$0.00	\$2,049.43	\$0.00	(\$2,049.43)
01-2-02220-330-001	Library or Media Services-Employee Training and Development Services--Sec	\$150.00	\$0.00	\$150.00	\$0.00	(\$150.00)
01-2-02220-610-001	Library or Media Services-General Supplies--Sec	\$896.93	\$0.00	\$896.93	\$0.00	(\$896.93)
01-2-02220-610-002	Library or Media Services-General Supplies-Elem	\$928.14	\$0.00	\$928.14	\$0.00	(\$928.14)
01-2-02220-640-001	Library or Media Services-Books and Periodical--Sec	\$7,382.90	\$0.00	\$7,382.90	\$0.00	(\$7,382.90)
01-2-02220-640-002	Library or Media Services-Books and Periodical-Elem	\$753.87	\$0.00	\$753.87	\$0.00	(\$753.87)
01-2-02220-643-001	Library or Media Services-Web/Cloud Based Software--Sec	\$125.00	\$0.00	\$125.00	\$0.00	(\$125.00)
01-2-02220-643-002	Library or Media Services-Web/Cloud Based Software-Elem	\$125.00	\$0.00	\$125.00	\$0.00	(\$125.00)
01-2-02220-735-000	Library or Media Services-Technology Software	\$744.83	\$0.00	\$744.83	\$0.00	(\$744.83)
01-2-02230-530-000	Instruction-Related Technology-Communications	\$1,672.24	\$0.00	\$1,672.24	\$0.00	(\$1,672.24)

01-2-02230-591-000	Instruction-Related Technology-Services Purchased From Another School District or Educational Services Agency Within the State	\$45,000.00	\$0.00	\$45,000.00	\$0.00	(\$45,000.00)
01-2-02230-643-000	Instruction-Related Technology-Web/Cloud Based Software	\$8,232.00	\$0.00	\$8,232.00	\$0.00	(\$8,232.00)
01-2-02230-734-001	Instruction-Related Technology-Technology-Related Hardware-Sec	\$7,000.00	\$0.00	\$7,000.00	\$0.00	(\$7,000.00)
01-2-02310-310-000	BOARD OF EDUCATION	\$75.00	\$0.00	\$75.00	\$0.00	(\$75.00)
01-2-02310-330-000	Board of Education-Employee Training and Development Services	\$50.00	\$0.00	\$50.00	\$0.00	(\$50.00)
01-2-02310-531-000	Board of Education-Postage	\$1,811.25	\$0.00	\$1,811.25	\$0.00	(\$1,811.25)
01-2-02310-540-000	Board of Education-Advertising	\$1,843.66	\$0.00	\$1,843.66	\$0.00	(\$1,843.66)
01-2-02310-610-000	Board of Education-General Supplies	\$765.48	\$0.00	\$765.48	\$0.00	(\$765.48)
01-2-02310-810-000	Board of Education-Dues and Fees	\$7,206.00	\$0.00	\$7,206.00	\$0.00	(\$7,206.00)
01-2-02320-105-000	EXECUTIVE ADMINISTRATION SERVICES	\$58,710.00	\$0.00	\$58,710.00	\$0.00	(\$58,710.00)
01-2-02320-215-000	Executive Administration-Group Insurance for Superintendents	\$12,948.20	\$0.00	\$12,948.20	\$0.00	(\$12,948.20)
01-2-02320-225-000	Executive Administration-Social Security Payments for Superintendents	\$4,437.66	\$0.00	\$4,437.66	\$0.00	(\$4,437.66)
01-2-02320-235-000	Executive Administration-Retirement Contributions for Superintendents	\$5,799.24	\$0.00	\$5,799.24	\$0.00	(\$5,799.24)
01-2-02320-310-000	EXECUTIVE ADMINISTRATION SERVICES	\$45.00	\$0.00	\$45.00	\$0.00	(\$45.00)
01-2-02320-330-000	Executive Administration-Employee Training and Development Services	\$300.00	\$0.00	\$300.00	\$0.00	(\$300.00)
01-2-02320-330-001	Executive Administration-Employee Training and Development Services-Sec	\$532.82	\$0.00	\$532.82	\$0.00	(\$532.82)
01-2-02320-382-000	EXECUTIVE ADMINISTRATION SERVICES	\$300.00	\$0.00	\$300.00	\$0.00	(\$300.00)
01-2-02320-520-000	Executive Administration-Insurance (Other Than Employee Benefits)	\$989.73	\$0.00	\$989.73	\$0.00	(\$989.73)
01-2-02320-580-000	Executive Administration-Travel	\$140.99	\$0.00	\$140.99	\$0.00	(\$140.99)
01-2-02320-580-001	Executive Administration-Travel-Sec	\$28.06	\$0.00	\$28.06	\$0.00	(\$28.06)
01-2-02320-810-000	Executive Administration-Dues and Fees	\$89.00	\$0.00	\$89.00	\$0.00	(\$89.00)
01-2-02330-317-000	District Legal Services-Contracted Legal Services	\$6,103.84	\$0.00	\$6,103.84	\$0.00	(\$6,103.84)
01-2-02410-110-000	OFFICE OF THE PRINCIPAL	\$15,208.90	\$0.00	\$15,208.90	\$0.00	(\$15,208.90)
01-2-02410-111-001	Office of the Principal-Salaries of Regular Employees Paid to Teachers/Professional Staff-Sec	\$19,312.68	\$0.00	\$19,312.68	\$0.00	(\$19,312.68)
01-2-02410-111-002	Office of the Principal-Salaries of Regular Employees Paid to Teachers/Professional Staff-Elem	\$19,312.62	\$0.00	\$19,312.62	\$0.00	(\$19,312.62)
01-2-02410-211-001	Office of the Principal-Group Insurance for Teachers/Professional Staff-Sec	\$6,146.36	\$0.00	\$6,146.36	\$0.00	(\$6,146.36)
01-2-02410-211-002	Office of the Principal-Group Insurance for Teachers/Professional Staff-Elem	\$6,146.31	\$0.00	\$6,146.31	\$0.00	(\$6,146.31)
01-2-02410-220-000	OFFICE OF THE PRINCIPAL	\$1,163.43	\$0.00	\$1,163.43	\$0.00	(\$1,163.43)
01-2-02410-221-001	Office of the Principal-Social Security Payments for Teachers/Professional Staff-Sec	\$1,450.73	\$0.00	\$1,450.73	\$0.00	(\$1,450.73)
01-2-02410-221-002	Office of the Principal-Social Security Payments for Teachers/Professional Staff-Elem	\$1,450.74	\$0.00	\$1,450.74	\$0.00	(\$1,450.74)
01-2-02410-230-000	OFFICE OF THE PRINCIPAL	\$1,502.32	\$0.00	\$1,502.32	\$0.00	(\$1,502.32)
01-2-02410-231-001	Office of the Principal-Retirement Contributions for Teachers/Professional Staff-Sec	\$1,907.69	\$0.00	\$1,907.69	\$0.00	(\$1,907.69)
01-2-02410-231-002	Office of the Principal-Retirement Contributions for Teachers/Professional Staff-Elem	\$1,907.65	\$0.00	\$1,907.65	\$0.00	(\$1,907.65)
01-2-02410-330-000	Office of the Principal-Employee Training and Development Services	\$657.50	\$0.00	\$657.50	\$0.00	(\$657.50)

01-2-02410-330-001	Office of the Principal-Employee Training and Development Services-Sec	\$342.82	\$0.00	\$342.82	\$0.00	(\$342.82)
01-2-02410-330-002	Office of the Principal-Employee Training and Development Services-Elem	\$95.00	\$0.00	\$95.00	\$0.00	(\$95.00)
01-2-02410-382-000	OFFICE OF THE PRINCIPAL	\$300.00	\$0.00	\$300.00	\$0.00	(\$300.00)
01-2-02410-580-000	Office of the Principal-Travel	\$15.28	\$0.00	\$15.28	\$0.00	(\$15.28)
01-2-02410-580-002	Office of the Principal-Travel-Elem	\$69.08	\$0.00	\$69.08	\$0.00	(\$69.08)
01-2-02510-110-000	SUPPORT SERVICES - BUSINESS	\$20,055.22	\$0.00	\$20,055.22	\$0.00	(\$20,055.22)
01-2-02510-210-000	SUPPORT SERVICES - BUSINESS	\$76.98	\$0.00	\$76.98	\$0.00	(\$76.98)
01-2-02510-220-000	SUPPORT SERVICES - BUSINESS	\$1,520.41	\$0.00	\$1,520.41	\$0.00	(\$1,520.41)
01-2-02510-230-000	SUPPORT SERVICES - BUSINESS	\$1,981.01	\$0.00	\$1,981.01	\$0.00	(\$1,981.01)
01-2-02510-315-000	SUPPORT SERVICES - BUSINESS	\$9,463.50	\$0.00	\$9,463.50	\$0.00	(\$9,463.50)
01-2-02510-610-000	Fiscal Services-General Supplies	\$594.62	\$0.00	\$594.62	\$0.00	(\$594.62)
01-2-02510-643-000	Fiscal Services-Web/Cloud Based Software	\$1,559.87	\$0.00	\$1,559.87	\$0.00	(\$1,559.87)
01-2-02510-810-000	Fiscal Services-Dues and Fees	\$20.00	\$0.00	\$20.00	\$0.00	(\$20.00)
01-2-02520-734-000	Purchasing, Warehousing, and Distributing Services-Technology-Related Hardware	\$3,000.00	\$0.00	\$3,000.00	\$0.00	(\$3,000.00)
01-2-02530-550-000	Printing, Publishing, and Duplicating Services-Printing and Binding	\$5,752.02	\$0.00	\$5,752.02	\$0.00	(\$5,752.02)
01-2-02570-810-000	Personnel Services-Dues and Fees	\$300.00	\$0.00	\$300.00	\$0.00	(\$300.00)
01-2-02580-432-000	Administrative Technology Service-Technology-Related Repairs and Maintenance	\$257.90	\$0.00	\$257.90	\$0.00	(\$257.90)
01-2-02580-432-001	Administrative Technology Service-Technology-Related Repairs and Maintenance-Sec	\$17.10	\$0.00	\$17.10	\$0.00	(\$17.10)
01-2-02580-610-000	Administrative Technology Service-General Supplies	\$300.00	\$0.00	\$300.00	\$189.78	(\$489.78)
01-2-02580-643-000	Administrative Technology Service-Web/Cloud Based Software	\$4,427.84	\$0.00	\$4,427.84	\$0.00	(\$4,427.84)
01-2-02580-650-000	Administrative Technology Service-Supplies-Technology Related	\$16.98	\$0.00	\$16.98	\$0.00	(\$16.98)
01-2-02580-735-000	Administrative Technology Service-Technology Software	\$783.20	\$0.00	\$783.20	\$0.00	(\$783.20)
01-2-02610-110-000	SUPPORT SERVICES - OPERATION OF BUILDING	\$26,084.58	\$0.00	\$26,084.58	\$0.00	(\$26,084.58)
01-2-02610-220-000	SUPPORT SERVICES - OPERATION OF BUILDING	\$1,995.49	\$0.00	\$1,995.49	\$0.00	(\$1,995.49)
01-2-02610-230-000	SUPPORT SERVICES - OPERATION OF BUILDING	\$2,576.58	\$0.00	\$2,576.58	\$0.00	(\$2,576.58)
01-2-02610-382-000	SUPPORT SERVICES - OPERATION OF BUILDING	\$3,336.02	\$0.00	\$3,336.02	\$0.00	(\$3,336.02)
01-2-02610-410-000	SUPPORT SERVICES - OPERATION OF BUILDING	\$22,984.46	\$0.00	\$22,984.46	\$0.00	(\$22,984.46)
01-2-02610-431-000	Operation of Buildings-Non-Technology-Related Repairs and Maintenance	\$563.49	\$0.00	\$563.49	\$0.00	(\$563.49)
01-2-02610-441-000	Operation of Buildings-Rentals of Land and Buildings	\$363.99	\$0.00	\$363.99	\$0.00	(\$363.99)
01-2-02610-520-000	Operation of Buildings-Insurance (Other Than Employee Benefits)	\$27,052.62	\$0.00	\$27,052.62	\$0.00	(\$27,052.62)
01-2-02610-580-000	Operation of Buildings-Travel	\$35.10	\$0.00	\$35.10	\$0.00	(\$35.10)
01-2-02610-610-000	Operation of Buildings-General Supplies	\$16,215.47	\$0.00	\$16,215.47	\$0.00	(\$16,215.47)
01-2-02610-621-000	Operation of Buildings-Natural Gas	\$5,413.80	\$0.00	\$5,413.80	\$0.00	(\$5,413.80)
01-2-02620-110-000	MAINTENANCE OF BUILDING	\$1,304.28	\$0.00	\$1,304.28	\$0.00	(\$1,304.28)
01-2-02620-220-000	Maintenance of Buildings-Social Security Payments for Non-Instructional	\$99.78	\$0.00	\$99.78	\$0.00	(\$99.78)

01-2-02620-230-000	Maintenance of Buildings-Retirement Contributions for Non-Instructional	\$128.82	\$0.00	\$128.82	\$0.00	(\$128.82)
01-2-02620-431-000	Maintenance of Buildings-Non-Technology-Related Repairs and Maintenance	\$1,869.40	\$0.00	\$1,869.40	\$0.00	(\$1,869.40)
01-2-02630-110-000	Care and Upkeep of Grounds-Salaries of Regular Employees Paid to Non-Instructional	\$2,330.20	\$0.00	\$2,330.20	\$0.00	(\$2,330.20)
01-2-02630-220-000	Care and Upkeep of Grounds-Social Security Payments for Non-Instructional	\$178.25	\$0.00	\$178.25	\$0.00	(\$178.25)
01-2-02630-230-000	Care and Upkeep of Grounds-Retirement Contributions for Non-Instructional	\$230.17	\$0.00	\$230.17	\$0.00	(\$230.17)
01-2-02630-431-000	Care and Upkeep of Grounds-Non-Technology-Related Repairs and Maintenance	\$415.00	\$0.00	\$415.00	\$0.00	(\$415.00)
01-2-02630-626-000	Care and Upkeep of Grounds-Gasoline	\$2,702.66	\$0.00	\$2,702.66	\$0.00	(\$2,702.66)
01-2-02710-110-000	REGULAR PUPIL TRANSPORTATION	\$16,743.76	\$0.00	\$16,743.76	\$0.00	(\$16,743.76)
01-2-02710-110-001	REGULAR PUPIL TRANSPORTATION	\$8,344.70	\$0.00	\$8,344.70	\$0.00	(\$8,344.70)
01-2-02710-110-002	REGULAR PUPIL TRANSPORTATION	\$8,813.16	\$0.00	\$8,813.16	\$0.00	(\$8,813.16)
01-2-02710-111-000	Vehicle Operation and Purchasing - Regular Education-Salaries of Regular Employees Paid to Teachers/Professional Staff	\$61.92	\$0.00	\$61.92	\$0.00	(\$61.92)
01-2-02710-111-001	Vehicle Operation and Purchasing - Regular Education-Salaries of Regular Employees Paid to Teachers/Professional Staff Sec	\$5,301.32	\$0.00	\$5,301.32	\$0.00	(\$5,301.32)
01-2-02710-111-002	Vehicle Operation and Purchasing - Regular Education-Salaries of Regular Employees Paid to Teachers/Professional Staff.Flem	\$6,105.00	\$0.00	\$6,105.00	\$0.00	(\$6,105.00)
01-2-02710-211-000	Vehicle Operation and Purchasing - Regular Education-Group Insurance for Teachers/Professional Staff	\$17.24	\$0.00	\$17.24	\$0.00	(\$17.24)
01-2-02710-211-001	Vehicle Operation and Purchasing - Regular Education-Group Insurance for Teachers/Professional Staff Sec	\$1,420.74	\$0.00	\$1,420.74	\$0.00	(\$1,420.74)
01-2-02710-211-002	Vehicle Operation and Purchasing - Regular Education-Group Insurance for Teachers/Professional Staff.Flem	\$1,653.87	\$0.00	\$1,653.87	\$0.00	(\$1,653.87)
01-2-02710-220-000	REGULAR PUPIL TRANSPORTATION	\$902.28	\$0.00	\$902.28	\$0.00	(\$902.28)
01-2-02710-220-001	REGULAR PUPIL TRANSPORTATION	\$638.37	\$0.00	\$638.37	\$0.00	(\$638.37)
01-2-02710-220-002	REGULAR PUPIL TRANSPORTATION	\$674.20	\$0.00	\$674.20	\$0.00	(\$674.20)
01-2-02710-221-000	Vehicle Operation and Purchasing - Regular Education-Social Security Payments for Teachers/Professional Staff	\$4.59	\$0.00	\$4.59	\$0.00	(\$4.59)
01-2-02710-221-001	Vehicle Operation and Purchasing - Regular Education-Social Security Payments for Teachers/Professional Staff Sec	\$392.74	\$0.00	\$392.74	\$0.00	(\$392.74)
01-2-02710-221-002	Vehicle Operation and Purchasing - Regular Education-Social Security Payments for Teachers/Professional Staff.Flem	\$452.09	\$0.00	\$452.09	\$0.00	(\$452.09)
01-2-02710-230-000	REGULAR PUPIL TRANSPORTATION	\$1,165.10	\$0.00	\$1,165.10	\$0.00	(\$1,165.10)
01-2-02710-230-001	Vehicle Operation and Purchasing - Regular Education-Retirement Contributions for Non-Instructional Sec	\$824.28	\$0.00	\$824.28	\$0.00	(\$824.28)
01-2-02710-230-002	REGULAR PUPIL TRANSPORTATION	\$870.52	\$0.00	\$870.52	\$0.00	(\$870.52)
01-2-02710-231-000	Vehicle Operation and Purchasing - Regular Education-Retirement Contributions for Teachers/Professional Staff	\$6.12	\$0.00	\$6.12	\$0.00	(\$6.12)
01-2-02710-231-001	Vehicle Operation and Purchasing - Regular Education-Retirement Contributions for Teachers/Professional Staff Sec	\$523.65	\$0.00	\$523.65	\$0.00	(\$523.65)

01-2-02710-231-002	Vehicle Operation and Purchasing - Regular Education-Retirement Contributions for Teachers/Professional Staff-Elem	\$603.04	\$0.00	\$603.04	\$0.00	(\$603.04)
01-2-02710-340-000	Vehicle Operation and Purchasing - Regular Education-Other Professional Services	\$304.00	\$0.00	\$304.00	\$0.00	(\$304.00)
01-2-02710-382-000	REGULAR PUPIL TRANSPORTATION	\$750.00	\$0.00	\$750.00	\$0.00	(\$750.00)
01-2-02710-580-000	Vehicle Operation and Purchasing - Regular Education-Travel	\$327.84	\$0.00	\$327.84	\$0.00	(\$327.84)
01-2-02710-626-000	Vehicle Operation and Purchasing - Regular Education-Gasoline	\$11,312.05	\$0.00	\$11,312.05	\$0.00	(\$11,312.05)
01-2-02730-431-000	Vehicle Servicing and Maintenance - Regular Education-Non-Technology-Related Repairs and Maintenance	\$19,723.47	\$0.00	\$19,723.47	\$0.00	(\$19,723.47)
01-2-02732-431-000	Vehicle Servicing and Maintenance - School Age SPED-Non-Technology-Related Repairs and Maintenance	\$200.00	\$0.00	\$200.00	\$0.00	(\$200.00)
01-2-02900-810-000	Other Support Services-Dues and Fees	\$2,684.75	\$0.00	\$2,684.75	\$0.00	(\$2,684.75)
01-2-03300-122-002	Community Services Operations-Salaries of Temporary Employees Paid to Instructional Aides and Assistants-Elem	\$1,475.50	\$0.00	\$1,475.50	\$0.00	(\$1,475.50)
01-2-03300-222-002	Community Services Operations-Social Security Payments for Instructional Aides or Assistants-Elem	\$107.88	\$0.00	\$107.88	\$0.00	(\$107.88)
01-2-03300-232-002	Community Services Operations-Retirement Contributions for Instructional Aides or Assistants-Elem	\$47.17	\$0.00	\$47.17	\$0.00	(\$47.17)
01-2-06200-111-002	Federal Services - Title I, Part A ESSA Improving Basic Programs Operated by Local Educational Agencies-Salaries of Regular Employees Paid to Teachers/Professional Staff-Elem	\$31,920.00	\$0.00	\$31,920.00	\$0.00	(\$31,920.00)
01-2-06200-211-002	Federal Services - Title I, Part A ESSA Improving Basic Programs Operated by Local Educational Agencies-Group Insurance for Teachers/Professional Staff-Elem	\$12,255.12	\$0.00	\$12,255.12	\$0.00	(\$12,255.12)
01-2-06200-221-002	Federal Services - Title I, Part A ESSA Improving Basic Programs Operated by Local Educational Agencies-Social Security Payments for Teachers/Professional Staff-Elem	\$2,336.52	\$0.00	\$2,336.52	\$0.00	(\$2,336.52)
01-2-06200-231-002	Federal Services - Title I, Part A ESSA Improving Basic Programs Operated by Local Educational Agencies-Retirement Contributions for Teachers/Professional Staff-Elem	\$3,153.00	\$0.00	\$3,153.00	\$0.00	(\$3,153.00)
01-2-06200-330-002	Federal Services - Title I, Part A ESSA Improving Basic Programs Operated by Local Educational Agencies-Employee Training and Development Services-Elem	\$65.00	\$0.00	\$65.00	\$0.00	(\$65.00)
01-2-06200-610-002	Federal Services - Title I, Part A ESSA Improving Basic Programs Operated by Local Educational Agencies-General Supplies-Elem	\$37.24	\$0.00	\$37.24	\$0.00	(\$37.24)
01-2-06408-591-002	IDEA Part B (611) Base & Enrollment Poverty Allocation Ages 0-21-Services Purchased From Another School District or Educational Services Agency-Within the State-Elem	\$11,718.73	\$0.00	\$11,718.73	\$0.00	(\$11,718.73)
01-2-06997-610-000	ESSERS 2-General Supplies	\$18,350.36	\$0.00	\$18,350.36	\$0.00	(\$18,350.36)
01-2-06997-734-000	ESSERS 2-Technology-Related Hardware	\$3,099.00	\$0.00	\$3,099.00	\$0.00	(\$3,099.00)
02-2-02610-410-000	Operation of Buildings-Utility Services	\$5,073.10	\$0.00	\$5,073.10	\$0.00	(\$5,073.10)
02-2-02900-430-000	Other Support Services-Repairs and Maintenance Services	\$356.93	\$0.00	\$356.93	\$0.00	(\$356.93)
02-2-02900-610-000	Other Support Services-General Supplies	\$5,380.00	\$0.00	\$5,380.00	\$0.00	(\$5,380.00)

05-1-01510-000-000	Interest	(\$94.60)	\$0.00	(\$94.60)	\$0.00	\$94.60
05-1-01710-000-000	Admissions	(\$22,566.27)	\$0.00	(\$22,566.27)	\$0.00	\$22,566.27
05-1-01730-000-000	Dues	(\$2,599.69)	\$0.00	(\$2,599.69)	\$0.00	\$2,599.69
05-1-01740-000-000	Fees	(\$124.00)	\$0.00	(\$124.00)	\$0.00	\$124.00
05-1-01790-000-000	Misc.	(\$41,747.82)	\$0.00	(\$41,747.82)	\$0.00	\$41,747.82
05-1-01920-000-000	Donation	(\$2,598.00)	\$0.00	(\$2,598.00)	\$0.00	\$2,598.00
05-2-02900-352-001	Refs	\$6,760.00	\$0.00	\$6,760.00	\$0.00	(\$6,760.00)
05-2-02900-441-001	Rental	\$3,500.00	\$0.00	\$3,500.00	\$0.00	(\$3,500.00)
05-2-02900-580-001	Travel Costs	\$3,752.85	\$0.00	\$3,752.85	\$0.00	(\$3,752.85)
05-2-02900-580-002	Other Support Services-Travel-Elem	\$208.00	\$0.00	\$208.00	\$0.00	(\$208.00)
05-2-02900-610-000	Other Support Services-General Supplies	\$30,601.34	\$0.00	\$30,601.34	\$0.00	(\$30,601.34)
05-2-02900-610-001	supplies	\$19,454.31	\$0.00	\$19,454.31	\$0.00	(\$19,454.31)
05-2-02900-610-002	Other Support Services-General Supplies-Elem	\$1,087.40	\$0.00	\$1,087.40	\$0.00	(\$1,087.40)
05-2-02900-810-000	Other Support Services-Dues and Fees	\$4,800.21	\$0.00	\$4,800.21	\$0.00	(\$4,800.21)
05-2-02900-810-001	Other Support Services-Dues and Fees-Sec	\$14,529.81	\$0.00	\$14,529.81	\$0.00	(\$14,529.81)
05-2-02900-810-002	Other Support Services-Dues and Fees-Elem	\$732.33	\$0.00	\$732.33	\$0.00	(\$732.33)
06-1-01611-000-000	Daily Sales?School Lunch Program	(\$3,262.40)	\$0.00	(\$3,262.40)	\$0.00	\$3,262.40
06-1-04210-000-000	Federal Nutrition Programs	(\$63,421.98)	\$0.00	(\$63,421.98)	\$0.00	\$63,421.98
06-2-03100-110-000	Food Services Operations-Salaries of Regular Employees Paid to Non-Instructional	\$33,219.19	\$0.00	\$33,219.19	\$0.00	(\$33,219.19)
06-2-03100-210-000	Food Services Operations-Group Insurance for Non-Instructional	\$31.26	\$0.00	\$31.26	\$0.00	(\$31.26)
06-2-03100-220-000	Food Services Operations-Social Security Payments for Non-Instructional	\$2,528.68	\$0.00	\$2,528.68	\$0.00	(\$2,528.68)
06-2-03100-230-000	Food Services Operations-Retirement Contributions for Non-Instructional	\$3,274.65	\$0.00	\$3,274.65	\$0.00	(\$3,274.65)
06-2-03100-610-000	Food Services Operations-General Supplies	\$152.24	\$0.00	\$152.24	\$0.00	(\$152.24)
06-2-03100-630-000	Food Services Operations-School Nutrition Food	\$57,060.22	\$0.00	\$57,060.22	\$0.00	(\$57,060.22)
06-2-03100-810-000	Food Services Operations-Dues and Fees	\$54.00	\$0.00	\$54.00	\$0.00	(\$54.00)
07-1-01100-000-000	Taxes Levied/Assessed by the School District	(\$79,018.12)	\$0.00	(\$79,018.12)	\$0.00	\$79,018.12
07-1-01115-000-000	CARLINE TAXES	(\$84.29)	\$0.00	(\$84.29)	\$0.00	\$84.29
07-1-01140-000-000	Penalties and Interest on Taxes	(\$207.86)	\$0.00	(\$207.86)	\$0.00	\$207.86
07-1-03180-000-000	PRO-RATE MOTOR VEHICLE	(\$150.57)	\$0.00	(\$150.57)	\$0.00	\$150.57
07-2-05000-831-000	Debt Service-Redemption of Principal	\$160,000.00	\$0.00	\$160,000.00	\$0.00	(\$160,000.00)
07-2-05000-832-000	Debt Service-Interest on Long-Term Debt	\$8,693.75	\$0.00	\$8,693.75	\$0.00	(\$8,693.75)
07-2-05000-890-000	Debt Service-Miscellaneous Expenditures	\$200.00	\$0.00	\$200.00	\$0.00	(\$200.00)
08-1-01100-000-000	Taxes Levied/Assessed by the School District	(\$42,451.16)	\$0.00	(\$42,451.16)	\$0.00	\$42,451.16
08-1-01115-000-000	CARLINE TAXES	(\$44.83)	\$0.00	(\$44.83)	\$0.00	\$44.83
08-1-01140-000-000	Penalties and Interest on Taxes	(\$114.83)	\$0.00	(\$114.83)	\$0.00	\$114.83
08-1-03130-000-000	HOMESTEAD EXEMPTION	(\$24.61)	\$0.00	(\$24.61)	\$0.00	\$24.61
08-1-03180-000-000	PRO-RATE MOTOR VEHICLE	(\$56.85)	\$0.00	(\$56.85)	\$0.00	\$56.85
09-1-01100-000-000	Taxes Levied/Assessed by the School District	(\$32,349.35)	\$0.00	(\$32,349.35)	\$0.00	\$32,349.35
09-1-01115-000-000	CARLINE TAXES	(\$35.12)	\$0.00	(\$35.12)	\$0.00	\$35.12
09-1-01140-000-000	Penalties and Interest on Taxes	(\$88.05)	\$0.00	(\$88.05)	\$0.00	\$88.05
09-1-03180-000-000	PRO-RATE MOTOR VEHICLE	(\$60.82)	\$0.00	(\$60.82)	\$0.00	\$60.82
09-2-05000-831-000	Debt Service-Redemption of Principal	\$65,000.00	\$0.00	\$65,000.00	\$0.00	(\$65,000.00)

09-2-05000-832-000	Debt Service-Interest on Long-Term Debt	\$3,018.75	\$0.00	\$3,018.75	\$0.00	(\$3,018.75)
09-2-05000-890-000	Debt Service-Miscellaneous Expenditures	\$200.00	\$0.00	\$200.00	\$0.00	(\$200.00)
10-1-01360-000-000	Adult Education Tuition and Fees	(\$14,546.35)	\$0.00	(\$14,546.35)	\$0.00	\$14,546.35
10-2-01100-111-001	Regular Instruction-Salaries of Regular Employees Paid to Teachers/Professional Staff-Sec	\$9,348.12	\$0.00	\$9,348.12	\$0.00	(\$9,348.12)
10-2-01100-211-001	Regular Instruction-Group Insurance for Teachers/Professional Staff-Sec	\$3,675.84	\$0.00	\$3,675.84	\$0.00	(\$3,675.84)
10-2-01100-221-001	Regular Instruction-Social Security Payments for Teachers/Professional Staff-Sec	\$689.51	\$0.00	\$689.51	\$0.00	(\$689.51)
10-2-01100-231-001	Regular Instruction-Retirement Contributions for Teachers/Professional Staff-Sec	\$923.40	\$0.00	\$923.40	\$0.00	(\$923.40)
12-1-01740-000-000	Fees	(\$11.00)	\$0.00	(\$11.00)	\$0.00	\$11.00
12-2-01100-610-000	Regular Instruction-General Supplies	\$168.31	\$0.00	\$168.31	\$0.00	(\$168.31)
Sub Total		\$329,950.13	\$0.00	\$329,950.13	\$189.78	(\$330,139.91)

Sterling Public Schools

Check Listing Report

Accounting Cycle: FY21/22; Begin Date: 01/13/2022; End Date: 02/14/2022; Bank: First National Bank; Sort By Element: Rev_Exp; Account Expression: [All]; Created On: 2/

Voucher Number	Bank Name	Account Number	Check Number
655	First National Bank	8065050	15016
Vendor	PO Number	Invoice #	Account Code
CORPORATE PAYMENT SYSTEMS		Activity Credit Card pmt January	05-2-02900-810-001
Sub Total			
Voucher Number	Bank Name	Account Number	Check Number
655	First National Bank	8065050	15017
Vendor	PO Number	Invoice #	Account Code
Heusman, Brent J		Brent Activity Reimb.	05-2-02900-810-000
Sub Total			
Voucher Number	Bank Name	Account Number	Check Number
655	First National Bank	8065050	15018
Vendor	PO Number	Invoice #	Account Code
Kevin Kroon		5057	05-2-02900-610-000
Sub Total			
Voucher Number	Bank Name	Account Number	Check Number
655	First National Bank	8065050	15019
Vendor	PO Number	Invoice #	Account Code
Mahaska-Pepsi		Jan 13th concession soda	05-2-02900-610-000
Sub Total			
Voucher Number	Bank Name	Account Number	Check Number
656	First National Bank	8065050	15020
Vendor	PO Number	Invoice #	Account Code
Book, P J		01-18-22 ref checks	05-2-02900-352-001
Sub Total			
Voucher Number	Bank Name	Account Number	Check Number
656	First National Bank	8065050	15021
Vendor	PO Number	Invoice #	Account Code
Cash-wa Distribution		13230560	05-2-02900-610-000
Sub Total			
Voucher Number	Bank Name	Account Number	Check Number
656	First National Bank	8065050	15022

Vendor	PO Number	Invoice #	Account Code
Champion TEAMWEAR	22-0010	0011372236	05-2-02900-610-001
Sub Total			
Voucher Number 656	Bank Name First National Bank	Account Number 8065050	Check Number 15023
Vendor	PO Number	Invoice #	Account Code
Freeman Public Schools Activity Account		1.20.22 JHGBB	05-2-02900-810-000
Sub Total			
Voucher Number 656	Bank Name First National Bank	Account Number 8065050	Check Number 15024
Vendor	PO Number	Invoice #	Account Code
Harris, Steve		Ref checks 01-17-22	05-2-02900-352-001
Sub Total			
Voucher Number 656	Bank Name First National Bank	Account Number 8065050	Check Number 15025
Vendor	PO Number	Invoice #	Account Code
Hauff Mid America Sports		96050, 97188	05-2-02900-610-001
Hauff Mid America Sports		96050, 97188	05-2-02900-610-001
Sub Total			
Voucher Number 656	Bank Name First National Bank	Account Number 8065050	Check Number 15026
Vendor	PO Number	Invoice #	Account Code
Heavican, Kellen		01-18-22 ref checks	05-2-02900-352-001
Sub Total			
Voucher Number 656	Bank Name First National Bank	Account Number 8065050	Check Number 15027
Vendor	PO Number	Invoice #	Account Code
Jeff Bracht		1-18-22 ref checks	05-2-02900-352-001
Sub Total			
Voucher Number 656	Bank Name First National Bank	Account Number 8065050	Check Number 15028
Vendor	PO Number	Invoice #	Account Code
PSC MATH CLUB		03.18.22 Math Day	05-2-02900-810-001
Sub Total			
Voucher Number 657	Bank Name First National Bank	Account Number 8065050	Check Number 15029
Vendor	PO Number	Invoice #	Account Code

First Bank of Nebraska		G/B BB/concessions 01.18.22	05-2-02900-610-001
Sub Total			
Voucher Number 658	Bank Name First National Bank	Account Number 8065050	Check Number 15030
Vendor Travel With Barb	PO Number	Invoice # 21-22 Band Trip	Account Code 05-2-02900-580-001
Sub Total			
Voucher Number 659	Bank Name First National Bank	Account Number 8065050	Check Number 15031
Vendor Chase Bryant	PO Number	Invoice # 1.21.22 ref check	Account Code 05-2-02900-352-001
Sub Total			
Voucher Number 659	Bank Name First National Bank	Account Number 8065050	Check Number 15032
Vendor First Bank of Nebraska	PO Number	Invoice # G/B BB 01.21.22 gate/conc	Account Code 05-2-02900-610-000
Sub Total			
Voucher Number 659	Bank Name First National Bank	Account Number 8065050	Check Number 15033
Vendor Isaak Russell	PO Number	Invoice # G/B bb 01.20.22 ref	Account Code 05-2-02900-352-001
Sub Total			
Voucher Number 659	Bank Name First National Bank	Account Number 8065050	Check Number 15034
Vendor Meyer, Devan	PO Number	Invoice # 1.21.22 ref check	Account Code 05-2-02900-352-001
Sub Total			
Voucher Number 660	Bank Name First National Bank	Account Number 8065050	Check Number 15035
Vendor First Bank of Nebraska	PO Number	Invoice # gate and concessions 01-25-22	Account Code 05-2-02900-610-001
Sub Total			
Voucher Number 660	Bank Name First National Bank	Account Number 8065050	Check Number 15036
Vendor Heise, Connor	PO Number	Invoice # ref check 1-25-22	Account Code 05-2-02900-352-001
Sub Total			

Voucher Number	Bank Name	Account Number	Check Number
660	First National Bank	8065050	15037
Vendor	PO Number	Invoice #	Account Code
Justin Pavich		01-25-22 ref checks	05-2-02900-352-001
Sub Total			
Voucher Number	Bank Name	Account Number	Check Number
660	First National Bank	8065050	15038
Vendor	PO Number	Invoice #	Account Code
Kosch, John		Pioneer music conference	05-2-02900-810-001
Sub Total			
Voucher Number	Bank Name	Account Number	Check Number
661	First National Bank	8065050	15040
Vendor	PO Number	Invoice #	Account Code
Zabel, Brody		01-25-22 ref checks	05-2-02900-352-001
Sub Total			
Voucher Number	Bank Name	Account Number	Check Number
662	First National Bank	8065050	15041
Vendor	PO Number	Invoice #	Account Code
Auburn Design Shop LLC		3635	05-2-02900-610-000
Sub Total			
Voucher Number	Bank Name	Account Number	Check Number
662	First National Bank	8065050	15042
Vendor	PO Number	Invoice #	Account Code
Cash-wa Distribution		13237953	05-2-02900-610-000
Sub Total			
Voucher Number	Bank Name	Account Number	Check Number
662	First National Bank	8065050	15043
Vendor	PO Number	Invoice #	Account Code
Gossard, Derrick J		HS STUCO	05-2-02900-610-000
Sub Total			
Voucher Number	Bank Name	Account Number	Check Number
662	First National Bank	8065050	15044
Vendor	PO Number	Invoice #	Account Code
Hauff Mid America Sports		100638	05-2-02900-610-000
Sub Total			
Voucher Number	Bank Name	Account Number	Check Number

662	First National Bank	8065050	15045
Vendor	PO Number	Invoice #	Account Code
Mahaska-Pepsi		01-27-22	05-2-02900-610-000
Sub Total			
Voucher Number	Bank Name	Account Number	Check Number
663	First National Bank	8065050	15046
Vendor	PO Number	Invoice #	Account Code
First Bank of Nebraska		JH G BB	05-2-02900-610-000
Sub Total			
Voucher Number	Bank Name	Account Number	Check Number
665	First National Bank	8065050	15047
Vendor	PO Number	Invoice #	Account Code
Country Meats		339200	05-2-02900-610-001
Sub Total			
Voucher Number	Bank Name	Account Number	Check Number
665	First National Bank	8065050	15048
Vendor	PO Number	Invoice #	Account Code
Crossroad Designs LLC		ag flowers	05-2-02900-610-000
Sub Total			
Voucher Number	Bank Name	Account Number	Check Number
665	First National Bank	8065050	15049
Vendor	PO Number	Invoice #	Account Code
First Bank of Nebraska		CRUSH Grams HS STUCO	05-2-02900-610-000
Sub Total			
Voucher Number	Bank Name	Account Number	Check Number
665	First National Bank	8065050	15050
Vendor	PO Number	Invoice #	Account Code
Travel With Barb		Music trip 2nd payment	05-2-02900-810-001
Sub Total			
Voucher Number	Bank Name	Account Number	Check Number
666	First National Bank	8065050	15051
Vendor	PO Number	Invoice #	Account Code
Meridian Activity Fund		02-07-2022 JH girls tournament	05-2-02900-810-001
Sub Total			
Voucher Number	Bank Name	Account Number	Check Number
667	First National Bank	8065050	15052
Vendor	PO Number	Invoice #	Account Code

First Bank of Nebraska		BBB Gate	05-2-02900-610-001
Sub Total			
Voucher Number	Bank Name	Account Number	Check Number
668	First National Bank	8065050	15053
Vendor	PO Number	Invoice #	Account Code
First Bank of Nebraska		gbb/concessions	05-2-02900-610-001
Sub Total			
Voucher Number	Bank Name	Account Number	Check Number
669	First National Bank	8065050	15054
Vendor	PO Number	Invoice #	Account Code
Brian Reese		GBB ref	05-2-02900-352-001
Sub Total			
Voucher Number	Bank Name	Account Number	Check Number
669	First National Bank	8065050	15055
Vendor	PO Number	Invoice #	Account Code
Chuck Taylor		GBB ref	05-2-02900-352-001
Sub Total			
Voucher Number	Bank Name	Account Number	Check Number
669	First National Bank	8065050	15056
Vendor	PO Number	Invoice #	Account Code
Troy Hayes		GBB ref	05-2-02900-352-001
Sub Total			
Voucher Number	Bank Name	Account Number	Check Number
670	First National Bank	8065050	15057
Vendor	PO Number	Invoice #	Account Code
Aaron Williams		ref check	05-2-02900-352-001
Sub Total			
Voucher Number	Bank Name	Account Number	Check Number
670	First National Bank	8065050	15058
Vendor	PO Number	Invoice #	Account Code
First Bank of Nebraska		G/B BB and concessions	05-2-02900-610-001
Sub Total			
Voucher Number	Bank Name	Account Number	Check Number
670	First National Bank	8065050	15059
Vendor	PO Number	Invoice #	Account Code
Harris, Steve		Ref checks	05-2-02900-352-001
Sub Total			

Voucher Number	Bank Name	Account Number	Check Number
670	First National Bank	8065050	15060
Vendor	PO Number	Invoice #	Account Code
Lauren Harms		refund FBLA	05-2-02900-810-001
Sub Total			
Voucher Number	Bank Name	Account Number	Check Number
670	First National Bank	8065050	15061
Vendor	PO Number	Invoice #	Account Code
Lyle Ziems		ref check	05-2-02900-352-001
Sub Total			
Voucher Number	Bank Name	Account Number	Check Number
670	First National Bank	8065050	15062
Vendor	PO Number	Invoice #	Account Code
Menards		77146	05-2-02900-610-000
Sub Total			
Voucher Number	Bank Name	Account Number	Check Number
670	First National Bank	8065050	15063
Vendor	PO Number	Invoice #	Account Code
NE SKILLS USA		M353831	05-2-02900-810-001
NE SKILLS USA		S83487	05-2-02900-810-001
NE SKILLS USA		S83595	05-2-02900-810-001
NE SKILLS USA		S83597	05-2-02900-810-001
Sub Total			
Voucher Number	Bank Name	Account Number	Check Number
670	First National Bank	8065050	15064
Vendor	PO Number	Invoice #	Account Code
Scholastic Book Fairs		B5213552F3	05-2-02900-810-002
Sub Total			
Voucher Number	Bank Name	Account Number	Check Number
672	First National Bank	8065050	15065
Vendor	PO Number	Invoice #	Account Code
Falls City Sacred Heart		Live stream	05-2-02900-810-001
Sub Total			
Voucher Number	Bank Name	Account Number	Check Number
672	First National Bank	8065050	15066
Vendor	PO Number	Invoice #	Account Code
NATIONAL FFA ORGANIZATION		MDS255528 FFA	05-2-02900-610-001

Sub Total			
Voucher Number 672	Bank Name First National Bank	Account Number 8065050	Check Number 15067
Vendor Sterling Community Association	PO Number	Invoice # 1st half of the year	Account Code 05-2-02900-441-001
Sub Total			
Voucher Number 672	Bank Name First National Bank	Account Number 8065050	Check Number 15068
Vendor University of Nebraska-Lincoln	PO Number	Invoice # Math day	Account Code 05-2-02900-810-001
Sub Total			
Voucher Number cc, ebbers	Bank Name First National Bank	Account Number 8059655	Check Number 31324
Vendor CORPORATE PAYMENT SYSTEMS	PO Number	Invoice # January 2022 bill	Account Code 01-2-01100-580-001
CORPORATE PAYMENT SYSTEMS		January 2022 bill	01-2-01100-610-001
CORPORATE PAYMENT SYSTEMS		January 2022 bill	01-2-01100-610-002
CORPORATE PAYMENT SYSTEMS		January 2022 bill	01-2-02220-610-002
CORPORATE PAYMENT SYSTEMS		January 2022 bill	01-2-02310-531-000
CORPORATE PAYMENT SYSTEMS		January 2022 bill	01-2-02320-580-000
CORPORATE PAYMENT SYSTEMS		January 2022 bill	01-2-02580-643-000
CORPORATE PAYMENT SYSTEMS		January 2022 bill	01-2-02610-610-000
Sub Total			
Voucher Number cc, ebbers	Bank Name First National Bank	Account Number 8059655	Check Number 31325
Vendor EBBERS, JASON	PO Number	Invoice # 01/24/2021	Account Code 01-2-02730-431-000
Sub Total			
Voucher Number Jan/Feb Bills	Bank Name First National Bank	Account Number 8059655	Check Number 31341
Vendor ADAMS SUPER FOODS	PO Number	Invoice # 01/31/2022	Account Code 06-2-03100-630-000
Sub Total			
Voucher Number Jan/Feb Bills	Bank Name First National Bank	Account Number 8059655	Check Number 31342
Vendor Allen, Adrian W	PO Number	Invoice # January cellphone	Account Code 01-2-02320-382-000
Sub Total			

Voucher Number	Bank Name	Account Number	Check Number
Jan/Feb Bills	First National Bank	8059655	31343
Vendor	PO Number	Invoice #	Account Code
Alm, Kim L		reimbursement	01-2-02510-610-000
Sub Total			
Voucher Number	Bank Name	Account Number	Check Number
Jan/Feb Bills	First National Bank	8059655	31344
Vendor	PO Number	Invoice #	Account Code
Amazon Capital Services		multiple	01-2-01100-610-000
Amazon Capital Services		multiple	01-2-01100-610-000
Amazon Capital Services		multiple	01-2-01100-610-000
Amazon Capital Services		multiple	01-2-01100-610-000
Amazon Capital Services		multiple	01-2-01100-610-000
Amazon Capital Services		multiple	01-2-01100-610-000
Amazon Capital Services		16dr-cj1c-jmdc	01-2-01100-610-002
Amazon Capital Services		1xrm-rrlm-16cf	01-2-01100-640-002
Amazon Capital Services		17xm-716h-kxjy	01-2-01190-610-002
Sub Total			
Voucher Number	Bank Name	Account Number	Check Number
Jan/Feb Bills	First National Bank	8059655	31345
Vendor	PO Number	Invoice #	Account Code
Beatrice Mechanical Service Inc		210579	02-2-02610-410-000
Sub Total			
Voucher Number	Bank Name	Account Number	Check Number
Jan/Feb Bills	First National Bank	8059655	31346
Vendor	PO Number	Invoice #	Account Code
Blick art material	22-0017	60013	01-2-01100-610-001
Blick art material	22-0017	60013	01-2-01100-610-001
Sub Total			
Voucher Number	Bank Name	Account Number	Check Number
Jan/Feb Bills	First National Bank	8059655	31347
Vendor	PO Number	Invoice #	Account Code
Boden, Ronald R		Jan cellphone	01-2-02710-382-000
Sub Total			
Voucher Number	Bank Name	Account Number	Check Number
Jan/Feb Bills	First National Bank	8059655	31348

Vendor	PO Number	Invoice #	Account Code
Boldt, Luke M		Jan Cell	01-2-02710-382-000
Sub Total			
Voucher Number	Bank Name	Account Number	Check Number
Jan/Feb Bills	First National Bank	8059655	31349
Vendor	PO Number	Invoice #	Account Code
Boslau, Dennis R		jan cellphone	01-2-02710-382-000
Sub Total			
Voucher Number	Bank Name	Account Number	Check Number
Jan/Feb Bills	First National Bank	8059655	31350
Vendor	PO Number	Invoice #	Account Code
Buss Pest Control		01/24/22	01-2-02620-431-000
Sub Total			
Voucher Number	Bank Name	Account Number	Check Number
Jan/Feb Bills	First National Bank	8059655	31351
Vendor	PO Number	Invoice #	Account Code
CAPITAL BUSINESS SYSTEMS, INC		30907674	01-2-02530-550-000
Sub Total			
Voucher Number	Bank Name	Account Number	Check Number
Jan/Feb Bills	First National Bank	8059655	31352
Vendor	PO Number	Invoice #	Account Code
Cash-wa Distribution		C13235353	06-2-03100-610-000
Cash-wa Distribution		13231531	06-2-03100-630-000
Cash-wa Distribution		13249726	06-2-03100-630-000
Cash-wa Distribution		13256655	06-2-03100-630-000
Cash-wa Distribution		13262756, A13257613	06-2-03100-630-000
Cash-wa Distribution		C13235353	06-2-03100-630-000
Cash-wa Distribution		C13233614	06-2-03100-630-000
Sub Total			
Voucher Number	Bank Name	Account Number	Check Number
Jan/Feb Bills	First National Bank	8059655	31353
Vendor	PO Number	Invoice #	Account Code
CULLIGAN OF LINCOLN		192946	01-2-02610-410-000
Sub Total			
Voucher Number	Bank Name	Account Number	Check Number
Jan/Feb Bills	First National Bank	8059655	31354
Vendor	PO Number	Invoice #	Account Code
DAS State Accounting - Central Finance		1300534	01-2-01100-382-000

DAS State Accounting - Central Finance		1304755	01-2-01100-382-000
Sub Total			
Voucher Number Jan/Feb Bills	Bank Name First National Bank	Account Number 8059655	Check Number 31355
Vendor DAVENPORT, JACOB M	PO Number	Invoice # January cellphone	Account Code 01-2-02410-382-000
Sub Total			
Voucher Number Jan/Feb Bills	Bank Name First National Bank	Account Number 8059655	Check Number 31356
Vendor Dunn, Mary R	PO Number	Invoice # reimbursement	Account Code 05-2-02900-610-000
Sub Total			
Voucher Number Jan/Feb Bills	Bank Name First National Bank	Account Number 8059655	Check Number 31357
Vendor EDGERTON EXPLORIT CENTER	PO Number	Invoice # SR21058	Account Code 01-2-01100-890-002
Sub Total			
Voucher Number Jan/Feb Bills	Bank Name First National Bank	Account Number 8059655	Check Number 31358
Vendor EGAN SUPPLY CO	PO Number	Invoice # 346479A	Account Code 01-2-02610-610-000
Vendor EGAN SUPPLY CO		Invoice # 347562	Account Code 01-2-02610-610-000
Sub Total			
Voucher Number Jan/Feb Bills	Bank Name First National Bank	Account Number 8059655	Check Number 31359
Vendor ESU #4	PO Number	Invoice # 9768	Account Code 01-2-02120-330-000
Vendor ESU #4		Invoice # 9768	Account Code 01-2-02120-330-000
Vendor ESU #4		Invoice # 9747 network admin 2nd half	Account Code 01-2-02230-591-000
Vendor ESU #4		Invoice # 9768	Account Code 01-2-02410-330-000
Vendor ESU #4		Invoice # 9768	Account Code 01-2-02410-330-000
Sub Total			
Voucher Number Jan/Feb Bills	Bank Name First National Bank	Account Number 8059655	Check Number 31360
Vendor ESU #6	PO Number	Invoice # 16452	Account Code 01-2-02230-643-000
Sub Total			

Sub Total			
Voucher Number Jan/Feb Bills	Bank Name First National Bank	Account Number 8059655	Check Number 31367
Vendor JET STOP INC.	PO Number	Invoice # 5018	Account Code 01-2-02710-626-000
Sub Total			
Voucher Number Jan/Feb Bills	Bank Name First National Bank	Account Number 8059655	Check Number 31368
Vendor Johnson County Hospital	PO Number	Invoice # January 2022 OT	Account Code 01-2-02161-334-000
Johnson County Hospital		January 2022 OT	01-2-02161-591-002
Johnson County Hospital		January 2022 PT	01-2-02171-334-000
Johnson County Hospital		January 2022 PT	01-2-02171-591-002
Johnson County Hospital		Dennis Boslau Physical	01-2-02710-340-000
Johnson County Hospital		Luke Boldt Physical	01-2-02710-340-000
Sub Total			
Voucher Number Jan/Feb Bills	Bank Name First National Bank	Account Number 8059655	Check Number 31369
Vendor Journey Ed	PO Number 22-0024	Invoice # 10473408	Account Code 01-2-02580-643-000
Sub Total			
Voucher Number Jan/Feb Bills	Bank Name First National Bank	Account Number 8059655	Check Number 31370
Vendor JW PEPPER & SON, INC	PO Number	Invoice # 364029038, 364028742	Account Code 01-2-01100-610-001
Sub Total			
Voucher Number Jan/Feb Bills	Bank Name First National Bank	Account Number 8059655	Check Number 31371
Vendor KLEIN HARDWARE HEATING & AIR	PO Number	Invoice # 3325	Account Code 02-2-02610-410-000
Sub Total			
Voucher Number Jan/Feb Bills	Bank Name First National Bank	Account Number 8059655	Check Number 31372
Vendor KnowBe4	PO Number 22-0022	Invoice # 170821	Account Code 01-2-02580-735-000
Sub Total			

Voucher Number	Bank Name	Account Number	Check Number
Jan/Feb Bills	First National Bank	8059655	31373
Vendor	PO Number	Invoice #	Account Code
KSB SCHOOL LAW		11443	01-2-02330-317-000
Sub Total			
Voucher Number	Bank Name	Account Number	Check Number
Jan/Feb Bills	First National Bank	8059655	31374
Vendor	PO Number	Invoice #	Account Code
Laffman Hot Rod Garage		245, 235, 200	01-2-02630-431-000
Laffman Hot Rod Garage		245, 235, 200	01-2-02730-431-000
Laffman Hot Rod Garage		245, 235, 200	01-2-02730-431-000
Sub Total			
Voucher Number	Bank Name	Account Number	Check Number
Jan/Feb Bills	First National Bank	8059655	31375
Vendor	PO Number	Invoice #	Account Code
Logston, Steven		reimb.	01-2-02610-580-000
Sub Total			
Voucher Number	Bank Name	Account Number	Check Number
Jan/Feb Bills	First National Bank	8059655	31376
Vendor	PO Number	Invoice #	Account Code
MARSHALL KATIE B		01/31/2022	01-2-01200-610-002
Sub Total			
Voucher Number	Bank Name	Account Number	Check Number
Jan/Feb Bills	First National Bank	8059655	31377
Vendor	PO Number	Invoice #	Account Code
Matheson Trigas DBA Linweld		51908185	01-2-02610-610-000
Sub Total			
Voucher Number	Bank Name	Account Number	Check Number
Jan/Feb Bills	First National Bank	8059655	31378
Vendor	PO Number	Invoice #	Account Code
Menards		75895	01-2-02610-610-000
Sub Total			
Voucher Number	Bank Name	Account Number	Check Number
Jan/Feb Bills	First National Bank	8059655	31379
Vendor	PO Number	Invoice #	Account Code
Mike's Welding		5765	01-2-01100-610-001
Sub Total			

Voucher Number	Bank Name	Account Number	Check Number
Jan/Feb Bills	First National Bank	8059655	31380
Vendor	PO Number	Invoice #	Account Code
Nasco		WOB3JR0	01-2-01100-610-001
Nasco	22-0016	W0B5G10	01-2-01100-610-001
Sub Total			
Voucher Number	Bank Name	Account Number	Check Number
Jan/Feb Bills	First National Bank	8059655	31381
Vendor	PO Number	Invoice #	Account Code
NCECBVI		o-891	01-2-02181-591-002
NCECBVI		O-911	01-2-02181-591-002
Sub Total			
Voucher Number	Bank Name	Account Number	Check Number
Jan/Feb Bills	First National Bank	8059655	31382
Vendor	PO Number	Invoice #	Account Code
Nebraska Association Of Scbd		22/23 dues	01-2-02310-810-000
Sub Total			
Voucher Number	Bank Name	Account Number	Check Number
Jan/Feb Bills	First National Bank	8059655	31383
Vendor	PO Number	Invoice #	Account Code
Nebraska Public Power Distric		January 14th Bill	01-2-02610-410-000
Sub Total			
Voucher Number	Bank Name	Account Number	Check Number
Jan/Feb Bills	First National Bank	8059655	31384
Vendor	PO Number	Invoice #	Account Code
NRCSA		LF 0037	01-2-02310-330-000
NRCSA		LF 0037	01-2-02320-330-001
Sub Total			
Voucher Number	Bank Name	Account Number	Check Number
Jan/Feb Bills	First National Bank	8059655	31385
Vendor	PO Number	Invoice #	Account Code
OverDrive Education	22-0013	4193	01-2-02220-643-001
OverDrive Education	22-0013	4193	01-2-02220-643-002
Sub Total			
Voucher Number	Bank Name	Account Number	Check Number
Jan/Feb Bills	First National Bank	8059655	31386
Vendor	PO Number	Invoice #	Account Code

PANKO		2239	01-2-02730-431-000
Sub Total			
Voucher Number Jan/Feb Bills	Bank Name First National Bank	Account Number 8059655	Check Number 31387
Vendor PSAT/NMSQT	PO Number	Invoice # 382292904A	Account Code 01-2-02120-810-000
Sub Total			
Voucher Number Jan/Feb Bills	Bank Name First National Bank	Account Number 8059655	Check Number 31388
Vendor School Health	PO Number 22-0012	Invoice # 1000265249	Account Code 01-2-01100-610-001
Sub Total			
Voucher Number Jan/Feb Bills	Bank Name First National Bank	Account Number 8059655	Check Number 31389
Vendor Staples	PO Number 22-0023	Invoice # 02/08/2022	Account Code 01-2-01100-610-000
Sub Total			
Voucher Number Jan/Feb Bills	Bank Name First National Bank	Account Number 8059655	Check Number 31390
Vendor Striv, Inc	PO Number	Invoice # 3563	Account Code 01-2-02900-810-000
Sub Total			
Voucher Number Jan/Feb Bills	Bank Name First National Bank	Account Number 8059655	Check Number 31391
Vendor Symmetry Energy Solutions, LLC	PO Number	Invoice # 12538284	Account Code 01-2-02610-621-000
Sub Total			
Voucher Number Jan/Feb Bills	Bank Name First National Bank	Account Number 8059655	Check Number 31392
Vendor SYSCO OF LINCOLN	PO Number	Invoice # 461078827, 461089483, 461100197,	Account Code 06-2-03100-630-000
Sub Total			
Voucher Number Jan/Feb Bills	Bank Name First National Bank	Account Number 8059655	Check Number 31393
Vendor T.O. Haas	PO Number	Invoice # 753, 748, 278	Account Code 01-2-02730-431-000

T.O. Haas		753, 748, 278	01-2-02730-431-000
Sub Total			
Voucher Number	Bank Name	Account Number	Check Number
Jan/Feb Bills	First National Bank	8059655	31394
Vendor	PO Number	Invoice #	Account Code
Tecumseh Chieftain		4609	01-2-02310-540-000
Sub Total			
Voucher Number	Bank Name	Account Number	Check Number
Jan/Feb Bills	First National Bank	8059655	31395
Vendor	PO Number	Invoice #	Account Code
The Home Depot Pro		662462191	01-2-02610-610-000
Sub Total			
Voucher Number	Bank Name	Account Number	Check Number
Jan/Feb Bills	First National Bank	8059655	31396
Vendor	PO Number	Invoice #	Account Code
UNITE PRIVATE NETWORKS, LLC		SI-22-004559	01-2-02230-530-000
Sub Total			
Voucher Number	Bank Name	Account Number	Check Number
Jan/Feb Bills	First National Bank	8059655	31397
Vendor	PO Number	Invoice #	Account Code
United States Postal Service		postage	01-2-02310-531-000
Sub Total			
Voucher Number	Bank Name	Account Number	Check Number
Jan/Feb Bills	First National Bank	8059655	31398
Vendor	PO Number	Invoice #	Account Code
Village Of Sterling		18732	01-2-02610-410-000
Village Of Sterling		6205	01-2-02610-410-000
Sub Total			
Voucher Number	Bank Name	Account Number	Check Number
Jan/Feb Bills	First National Bank	8059655	31399
Vendor	PO Number	Invoice #	Account Code
WageWorks, Inc		INV3337405	01-2-02900-810-000
Sub Total			
Voucher Number	Bank Name	Account Number	Check Number
Jan/Feb Bills	First National Bank	8059655	31400
Vendor	PO Number	Invoice #	Account Code
Waymire Well Drilling, Inc.		22R32	01-2-02610-431-000

Sub Total			
Voucher Number Jan/Feb Bills	Bank Name First National Bank	Account Number 8059655	Check Number 31401
Vendor WINDSTREAM COMMUNICATIONS, INC	PO Number	Invoice # 01/31/2022	Account Code 01-2-02610-382-000
WINDSTREAM COMMUNICATIONS, INC		1753791T059	01-2-02610-382-000
Sub Total			
Voucher Number Jan/Feb Bills	Bank Name First National Bank	Account Number 8059655	Check Number 31402
Vendor Wirthele, Cheri J	PO Number	Invoice # january cellphone	Account Code 01-2-02710-382-000
Sub Total			
Voucher Number Jan/Feb Bills	Bank Name First National Bank	Account Number 8059655	Check Number 31403
Vendor WUSK ELECTRIC	PO Number	Invoice # 418	Account Code 01-2-02610-431-000
Sub Total			
Grand Total			

/17/2022 12:30:10 PM

Payee	Amount	Type
CORPORATE PAYMENT SYSTEMS	\$900.00	Accounts Payable
Description	Issue Date	Amount
Hudl		\$900.00
		\$900.00
Payee	Amount	Type
Heusman, Brent J	\$27.21	Accounts Payable
Description	Issue Date	Amount
		\$27.21
		\$27.21
Payee	Amount	Type
Kevin Kroon	\$110.00	Accounts Payable
Description	Issue Date	Amount
		\$110.00
		\$110.00
Payee	Amount	Type
Mahaska-Pepsi	\$260.40	Accounts Payable
Description	Issue Date	Amount
soda-pop		\$260.40
		\$260.40
Payee	Amount	Type
Book, P J	\$125.00	Accounts Payable
Description	Issue Date	Amount
		\$125.00
		\$125.00
Payee	Amount	Type
Cash-wa Distribution	\$976.07	Accounts Payable
Description	Issue Date	Amount
		\$976.07
		\$976.07
Payee	Amount	Type
Champion TEAMWEAR	\$26.94	Accounts Payable

Description	Issue Date	Amount
ladies heritage DK skirt-large	01/07/2022	\$26.94
		\$26.94
Payee	Amount	Type
Freeman Public Schools Activity Account	\$125.00	Accounts Payable
Description	Issue Date	Amount
		\$125.00
		\$125.00
Payee	Amount	Type
Harris, Steve	\$75.00	Accounts Payable
Description	Issue Date	Amount
		\$75.00
		\$75.00
Payee	Amount	Type
Hauff Mid America Sports	\$1,000.74	Accounts Payable
Description	Issue Date	Amount
g/b bb		\$746.14
JH BB		\$254.60
		\$1,000.74
Payee	Amount	Type
Heavican, Kellen	\$125.00	Accounts Payable
Description	Issue Date	Amount
		\$125.00
		\$125.00
Payee	Amount	Type
Jeff Bracht	\$125.00	Accounts Payable
Description	Issue Date	Amount
		\$125.00
		\$125.00
Payee	Amount	Type
PSC MATH CLUB	\$50.00	Accounts Payable
Description	Issue Date	Amount
		\$50.00
		\$50.00
Payee	Amount	Type
First Bank of Nebraska	\$770.00	Accounts Payable
Description	Issue Date	Amount

		\$770.00
		\$770.00
Payee	Amount	Type
Travel With Barb	\$3,752.85	Accounts Payable
Description	Issue Date	Amount
		\$3,752.85
		\$3,752.85
Payee	Amount	Type
Chase Bryant	\$125.00	Accounts Payable
Description	Issue Date	Amount
		\$125.00
		\$125.00
Payee	Amount	Type
First Bank of Nebraska	\$770.00	Accounts Payable
Description	Issue Date	Amount
		\$770.00
		\$770.00
Payee	Amount	Type
Isaak Russell	\$125.00	Accounts Payable
Description	Issue Date	Amount
		\$125.00
		\$125.00
Payee	Amount	Type
Meyer, Devan	\$125.00	Accounts Payable
Description	Issue Date	Amount
		\$125.00
		\$125.00
Payee	Amount	Type
First Bank of Nebraska	\$770.00	Accounts Payable
Description	Issue Date	Amount
		\$770.00
		\$770.00
Payee	Amount	Type
Heise, Connor	\$125.00	Accounts Payable
Description	Issue Date	Amount
		\$125.00
		\$125.00

Payee	Amount	Type
Justin Pavich	\$125.00	Accounts Payable
Description	Issue Date	Amount
		\$125.00
		\$125.00
Payee	Amount	Type
Kosch, John	\$291.00	Accounts Payable
Description	Issue Date	Amount
		\$291.00
		\$291.00
Payee	Amount	Type
Zabel, Brody	\$125.00	Accounts Payable
Description	Issue Date	Amount
		\$125.00
		\$125.00
Payee	Amount	Type
Auburn Design Shop LLC	\$66.00	Accounts Payable
Description	Issue Date	Amount
		\$66.00
		\$66.00
Payee	Amount	Type
Cash-wa Distribution	\$598.90	Accounts Payable
Description	Issue Date	Amount
		\$598.90
		\$598.90
Payee	Amount	Type
Gossard, Derrick J	\$50.00	Accounts Payable
Description	Issue Date	Amount
		\$50.00
		\$50.00
Payee	Amount	Type
Hauff Mid America Sports	\$96.00	Accounts Payable
Description	Issue Date	Amount
		\$96.00
		\$96.00
Payee	Amount	Type

Mahaska-Pepsi	\$433.44	Accounts Payable
Description	Issue Date	Amount
		\$433.44
		\$433.44
Payee	Amount	Type
First Bank of Nebraska	\$200.00	Accounts Payable
Description	Issue Date	Amount
		\$200.00
		\$200.00
Payee	Amount	Type
Country Meats	\$354.00	Accounts Payable
Description	Issue Date	Amount
FFA		\$354.00
		\$354.00
Payee	Amount	Type
Crossroad Designs LLC	\$12.50	Accounts Payable
Description	Issue Date	Amount
		\$12.50
		\$12.50
Payee	Amount	Type
First Bank of Nebraska	\$150.00	Accounts Payable
Description	Issue Date	Amount
HS STUCO Crush Grams		\$150.00
		\$150.00
Payee	Amount	Type
Travel With Barb	\$3,200.00	Accounts Payable
Description	Issue Date	Amount
2nd payment for Music Trip		\$3,200.00
		\$3,200.00
Payee	Amount	Type
Meridian Activity Fund	\$50.00	Accounts Payable
Description	Issue Date	Amount
Girls JH tournament		\$50.00
		\$50.00
Payee	Amount	Type
First Bank of Nebraska	\$200.00	Accounts Payable
Description	Issue Date	Amount

		\$200.00
		\$200.00
Payee	Amount	Type
First Bank of Nebraska	\$770.00	Accounts Payable
Description	Issue Date	Amount
		\$770.00
		\$770.00
Payee	Amount	Type
Brian Reese	\$125.00	Accounts Payable
Description	Issue Date	Amount
		\$125.00
		\$125.00
Payee	Amount	Type
Chuck Taylor	\$125.00	Accounts Payable
Description	Issue Date	Amount
		\$125.00
		\$125.00
Payee	Amount	Type
Troy Hayes	\$125.00	Accounts Payable
Description	Issue Date	Amount
		\$125.00
		\$125.00
Payee	Amount	Type
Aaron Williams	\$125.00	Accounts Payable
Description	Issue Date	Amount
		\$125.00
		\$125.00
Payee	Amount	Type
First Bank of Nebraska	\$770.00	Accounts Payable
Description	Issue Date	Amount
		\$770.00
		\$770.00
Payee	Amount	Type
Harris, Steve	\$125.00	Accounts Payable
Description	Issue Date	Amount
		\$125.00
		\$125.00

Payee	Amount	Type
Lauren Harms	\$22.00	Accounts Payable
Description	Issue Date	Amount
		\$22.00
		\$22.00
Payee	Amount	Type
Lyle Ziems	\$125.00	Accounts Payable
Description	Issue Date	Amount
		\$125.00
		\$125.00
Payee	Amount	Type
Menards	\$250.56	Accounts Payable
Description	Issue Date	Amount
Skills supplies		\$250.56
		\$250.56
Payee	Amount	Type
NE SKILLS USA	\$2,076.00	Accounts Payable
Description	Issue Date	Amount
		\$16.00
		\$1,760.00
		\$275.00
		\$25.00
		\$2,076.00
Payee	Amount	Type
Scholastic Book Fairs	\$530.83	Accounts Payable
Description	Issue Date	Amount
		\$530.83
		\$530.83
Payee	Amount	Type
Falls City Sacred Heart	\$75.00	Accounts Payable
Description	Issue Date	Amount
		\$75.00
		\$75.00
Payee	Amount	Type
NATIONAL FFA ORGANIZATION	\$179.00	Accounts Payable
Description	Issue Date	Amount
		\$179.00

		\$179.00
Payee	Amount	Type
Sterling Community Association	\$3,500.00	Accounts Payable
Description	Issue Date	Amount
		\$3,500.00
		\$3,500.00
Payee	Amount	Type
University of Nebraska-Lincoln	\$40.00	Accounts Payable
Description	Issue Date	Amount
Math Day		\$40.00
		\$40.00
Payee	Amount	Type
CORPORATE PAYMENT SYSTEMS	\$2,893.09	Accounts Payable
Description	Issue Date	Amount
Brents card-travel costs		\$85.30
		\$335.34
spelling bee/supplies		\$392.99
demco-library		\$98.13
postage for newsletter		\$127.80
Ade travel meal		\$12.00
Mosyle_tech		\$1,787.40
maint.		\$54.13
		\$2,893.09
Payee	Amount	Type
EBBERS, JASON	\$500.00	Accounts Payable
Description	Issue Date	Amount
		\$500.00
		\$500.00
Payee	Amount	Type
ADAMS SUPER FOODS	\$25.45	Accounts Payable
Description	Issue Date	Amount
		\$25.45
		\$25.45
Payee	Amount	Type
Allen, Adrian W	\$50.00	Accounts Payable
Description	Issue Date	Amount
		\$50.00
		\$50.00

Payee	Amount	Type
Alm, Kim L	\$112.18	Accounts Payable
Description	Issue Date	Amount
		\$112.18
		\$112.18
Payee	Amount	Type
Amazon Capital Services	\$472.52	Accounts Payable
Description	Issue Date	Amount
17vd-yrtf-r6dx office supplies		\$85.19
17yh-cm6j-7fh7		\$20.00
1qw9-1m4-k7pp office supplies		\$16.70
ik1t-149d-9v4k		\$69.48
office supplies		\$13.98
17xm-7l6h-kxiv office supplies		\$147.75
1lr4-ldaw-t3k4 elementary supplies		\$60.86
		\$11.59
preschool supplies		\$46.97
		\$472.52
Payee	Amount	Type
Beatrice Mechanical Service Inc	\$2,735.17	Accounts Payable
Description	Issue Date	Amount
		\$2,735.17
		\$2,735.17
Payee	Amount	Type
Blick art material	\$127.69	Accounts Payable
Description	Issue Date	Amount
Crayola Broad Line Markers - Assorted Colors, Set of 256 Blick Art Materials	01/19/2022	\$83.99
Xiem Silicone Rib - Soft 5 Blick Art Materials	01/19/2022	\$43.70
		\$127.69
Payee	Amount	Type
Boden, Ronald R	\$25.00	Accounts Payable
Description	Issue Date	Amount
		\$25.00
		\$25.00
Payee	Amount	Type
Boldt, Luke M	\$25.00	Accounts Payable

Description	Issue Date	Amount
		\$25.00
		\$25.00
Payee	Amount	Type
Boslau, Dennis R	\$25.00	Accounts Payable
Description	Issue Date	Amount
		\$25.00
		\$25.00
Payee	Amount	Type
Buss Pest Control	\$70.00	Accounts Payable
Description	Issue Date	Amount
		\$70.00
		\$70.00
Payee	Amount	Type
CAPITAL BUSINESS SYSTEMS, INC	\$934.43	Accounts Payable
Description	Issue Date	Amount
		\$934.43
		\$934.43
Payee	Amount	Type
Cash-wa Distribution	\$4,777.93	Accounts Payable
Description	Issue Date	Amount
plastic spoons 1000 ct		\$38.49
		\$314.00
		\$1,806.27
		\$591.43
		\$1,530.72
		\$476.41
soymilk		\$20.61
		\$4,777.93
Payee	Amount	Type
CULLIGAN OF LINCOLN	\$137.00	Accounts Payable
Description	Issue Date	Amount
		\$137.00
		\$137.00
Payee	Amount	Type
DAS State Accounting - Central Finance	\$518.98	Accounts Payable
Description	Issue Date	Amount
		\$259.49

		\$259.49
		\$518.98
Payee	Amount	Type
DAVENPORT, JACOB M	\$50.00	Accounts Payable
Description	Issue Date	Amount
		\$50.00
		\$50.00
Payee	Amount	Type
Dunn, Mary R	\$24.00	Accounts Payable
Description	Issue Date	Amount
		\$24.00
		\$24.00
Payee	Amount	Type
EDGERTON EXPLORIT CENTER	\$1,999.32	Accounts Payable
Description	Issue Date	Amount
		\$1,999.32
		\$1,999.32
Payee	Amount	Type
EGAN SUPPLY CO	\$734.30	Accounts Payable
Description	Issue Date	Amount
		\$9.35
		\$724.95
		\$734.30
Payee	Amount	Type
ESU #4	\$22,545.00	Accounts Payable
Description	Issue Date	Amount
		\$15.00
heusman		\$7.50
		\$22,500.00
		\$15.00
Davenport		\$7.50
		\$22,545.00
Payee	Amount	Type
ESU #6	\$61.00	Accounts Payable
Description	Issue Date	Amount
		\$61.00
		\$61.00

Payee	Amount	Type
First Bank of Nebraska	\$20.00	Accounts Payable
Description	Issue Date	Amount
		\$20.00
		\$20.00
Payee	Amount	Type
FOLLETT SCHOOL SOLUTIONS INC	\$1,429.50	Accounts Payable
Description	Issue Date	Amount
High School	01/21/2022	\$675.63
Elementary	01/21/2022	\$753.87
		\$1,429.50
Payee	Amount	Type
Glaser Ceramics	\$478.45	Accounts Payable
Description	Issue Date	Amount
Stroke & Coat Kit 2 (pint) and Lowfire White Clay 25 lb. blocks	01/13/2022	\$478.45
		\$478.45
Payee	Amount	Type
Hancock Lumber, LLC	\$24.14	Accounts Payable
Description	Issue Date	Amount
		\$24.14
		\$24.14
Payee	Amount	Type
Heusman, Brent J	\$25.00	Accounts Payable
Description	Issue Date	Amount
		\$25.00
		\$25.00
Payee	Amount	Type
HILAND DAIRY	\$1,811.29	Accounts Payable
Description	Issue Date	Amount
953490		\$370.66
953561		\$193.80
953601		\$257.27
953683		\$210.63
953684		(\$60.03)
953727		\$242.06
953809		\$257.94
953855		\$145.16
953938		\$193.80

		\$1,811.29
Payee	Amount	Type
JET STOP INC.	\$2,208.15	Accounts Payable
Description	Issue Date	Amount
		\$2,208.15
		\$2,208.15
Payee	Amount	Type
Johnson County Hospital	\$1,954.95	Accounts Payable
Description	Issue Date	Amount
		\$224.79
		\$1,251.36
		\$16.80
		\$158.00
		\$152.00
		\$1,954.95
Payee	Amount	Type
Journey Ed	\$1,222.40	Accounts Payable
Description	Issue Date	Amount
microsoft office	02/08/2022	\$1,222.40
		\$1,222.40
Payee	Amount	Type
JW PEPPER & SON, INC	\$67.99	Accounts Payable
Description	Issue Date	Amount
		\$67.99
		\$67.99
Payee	Amount	Type
KLEIN HARDWARE HEATING & AIR	\$863.52	Accounts Payable
Description	Issue Date	Amount
		\$863.52
		\$863.52
Payee	Amount	Type
KnowBe4	\$783.20	Accounts Payable
Description	Issue Date	Amount
KnowBe4 Security Awareness Training Subscription Gold	01/25/2022	\$783.20
		\$783.20

Payee	Amount	Type
KSB SCHOOL LAW	\$154.00	Accounts Payable
Description	Issue Date	Amount
		\$154.00
		\$154.00
Payee	Amount	Type
Laffman Hot Rod Garage	\$233.20	Accounts Payable
Description	Issue Date	Amount
snow removal		\$140.00
		\$18.00
oil change lof truck		\$75.20
		\$233.20
Payee	Amount	Type
Logston, Steven	\$35.10	Accounts Payable
Description	Issue Date	Amount
		\$35.10
		\$35.10
Payee	Amount	Type
MARSHALL KATIE B	\$105.18	Accounts Payable
Description	Issue Date	Amount
pre-k sped supplies		\$105.18
		\$105.18
Payee	Amount	Type
Matheson Trigas DBA Linweld	\$34.62	Accounts Payable
Description	Issue Date	Amount
		\$34.62
		\$34.62
Payee	Amount	Type
Menards	\$60.68	Accounts Payable
Description	Issue Date	Amount
		\$60.68
		\$60.68
Payee	Amount	Type
Mike's Welding	\$532.51	Accounts Payable
Description	Issue Date	Amount
Shop		\$532.51
		\$532.51

Payee	Amount	Type
Nasco	\$119.95	Accounts Payable
Description	Issue Date	Amount
		\$35.50
Ceramic Bisque Tiles - 4-1/4 in. x 4-1/4 in. - Box of 80	01/19/2022	\$84.45
		\$119.95
Payee	Amount	Type
NCECBVI	\$1,095.60	Accounts Payable
Description	Issue Date	Amount
		\$547.80
cooper pella		\$547.80
		\$1,095.60
Payee	Amount	Type
Nebraska Association Of Scbd	\$3,406.00	Accounts Payable
Description	Issue Date	Amount
Annual membership dues		\$3,406.00
		\$3,406.00
Payee	Amount	Type
Nebraska Public Power Distric	\$2,332.03	Accounts Payable
Description	Issue Date	Amount
		\$2,332.03
		\$2,332.03
Payee	Amount	Type
NRCSA	\$130.00	Accounts Payable
Description	Issue Date	Amount
john harms 2022 nrdsa legislative forum reigstration		\$50.00
2022 NRCSA legislative forum registration		\$80.00
		\$130.00
Payee	Amount	Type
OverDrive Education	\$250.00	Accounts Payable
Description	Issue Date	Amount
Digital book	01/13/2022	\$125.00
Digital book	01/13/2022	\$125.00
		\$250.00
Payee	Amount	Type
PANKO	\$4,063.75	Accounts Payable
Description	Issue Date	Amount

		\$4,063.75
		\$4,063.75
Payee	Amount	Type
PSAT/NMSQT	\$126.00	Accounts Payable
Description	Issue Date	Amount
		\$126.00
		\$126.00
Payee	Amount	Type
School Health	\$51.71	Accounts Payable
Description	Issue Date	Amount
Econoline American Foam, 12" x 44" x 1/4" Item # 29110	01/13/2022	\$51.71
		\$51.71
Payee	Amount	Type
Staples	\$225.12	Accounts Payable
Description	Issue Date	Amount
3M™ Dual Laminate Refill Cartridge (DL951)	02/08/2022	\$225.12
		\$225.12
Payee	Amount	Type
Striv, Inc	\$1,975.00	Accounts Payable
Description	Issue Date	Amount
		\$1,975.00
		\$1,975.00
Payee	Amount	Type
Symmetry Energy Solutions, LLC	\$887.30	Accounts Payable
Description	Issue Date	Amount
		\$887.30
		\$887.30
Payee	Amount	Type
SYSCO OF LINCOLN	\$5,017.47	Accounts Payable
Description	Issue Date	Amount
		\$5,017.47
		\$5,017.47
Payee	Amount	Type
T.O. Haas	\$2,923.38	Accounts Payable
Description	Issue Date	Amount
bus tires		\$2,880.18

labor-tire		\$43.20
		\$2,923.38
Payee	Amount	Type
Tecumseh Chieftain	\$51.60	Accounts Payable
Description	Issue Date	Amount
		\$51.60
		\$51.60
Payee	Amount	Type
The Home Depot Pro	\$39.02	Accounts Payable
Description	Issue Date	Amount
		\$39.02
		\$39.02
Payee	Amount	Type
UNITE PRIVATE NETWORKS, LLC	\$556.43	Accounts Payable
Description	Issue Date	Amount
		\$556.43
		\$556.43
Payee	Amount	Type
United States Postal Service	\$20.85	Accounts Payable
Description	Issue Date	Amount
		\$20.85
		\$20.85
Payee	Amount	Type
Village Of Sterling	\$222.00	Accounts Payable
Description	Issue Date	Amount
		\$172.00
		\$50.00
		\$222.00
Payee	Amount	Type
WageWorks, Inc	\$86.75	Accounts Payable
Description	Issue Date	Amount
		\$86.75
		\$86.75
Payee	Amount	Type
Waymire Well Drilling, Inc.	\$32.35	Accounts Payable
Description	Issue Date	Amount
		\$32.35

		\$32.35
Payee	Amount	Type
WINDSTREAM COMMUNICATIONS, INC	\$1,060.82	Accounts Payable
Description	Issue Date	Amount
		\$391.78
		\$669.04
		\$1,060.82
Payee	Amount	Type
Wirthele, Cheri J	\$25.00	Accounts Payable
Description	Issue Date	Amount
		\$25.00
		\$25.00
Payee	Amount	Type
WUSK ELECTRIC	\$354.84	Accounts Payable
Description	Issue Date	Amount
		\$354.84
		\$354.84
		\$101,344.35

Sterling Public Schools

Check Listing Report

Accounting Cycle: FY21/22; Begin Date: 01/13/2022; End Date: 02/14/2022; Bank: First National Bank; Sort By Element: Rev_Exp; Account Expression: [All];
Created On: 2/17/2022 12:30:11 PM

Check Date	Check Number	Payee	Type	Amount
01/13/2022	15016	CORPORATE PAYMENT SYSTEMS	Accounts Payable	\$900.00
01/13/2022	15017	Heusman, Brent J	Accounts Payable	\$27.21
01/13/2022	15018	Kevin Kroon	Accounts Payable	\$110.00
01/13/2022	15019	Mahaska-Pepsi	Accounts Payable	\$260.40
01/17/2022	15020	Book, P J	Accounts Payable	\$125.00
01/17/2022	15021	Cash-wa Distribution	Accounts Payable	\$976.07
01/17/2022	15022	Champion TEAMWEAR	Accounts Payable	\$26.94
01/17/2022	15023	Freeman Public Schools Activity Account	Accounts Payable	\$125.00
01/17/2022	15024	Harris, Steve	Accounts Payable	\$75.00
01/17/2022	15025	Hauff Mid America Sports	Accounts Payable	\$1,000.74
01/17/2022	15026	Heavican, Kellen	Accounts Payable	\$125.00
01/17/2022	15027	Jeff Bracht	Accounts Payable	\$125.00
01/17/2022	15028	PSC MATH CLUB	Accounts Payable	\$50.00
01/18/2022	15029	First Bank of Nebraska	Accounts Payable	\$770.00
01/19/2022	15030	Travel With Barb	Accounts Payable	\$3,752.85
01/20/2022	15031	Chase Bryant	Accounts Payable	\$125.00
01/20/2022	15032	First Bank of Nebraska	Accounts Payable	\$770.00
01/20/2022	15033	Isaak Russell	Accounts Payable	\$125.00
01/20/2022	15034	Meyer, Devan	Accounts Payable	\$125.00
01/24/2022	15035	First Bank of Nebraska	Accounts Payable	\$770.00
01/24/2022	15036	Heise, Connor	Accounts Payable	\$125.00
01/24/2022	15037	Justin Pavich	Accounts Payable	\$125.00
01/24/2022	15038	Kosch, John	Accounts Payable	\$291.00
01/25/2022	15040	Zabel, Brody	Accounts Payable	\$125.00
01/28/2022	15041	Auburn Design Shop LLC	Accounts Payable	\$66.00
01/28/2022	15042	Cash-wa Distribution	Accounts Payable	\$598.90
01/28/2022	15043	Gossard, Derrick J	Accounts Payable	\$50.00
01/28/2022	15044	Hauff Mid America Sports	Accounts Payable	\$96.00
01/28/2022	15045	Mahaska-Pepsi	Accounts Payable	\$433.44
01/31/2022	15046	First Bank of Nebraska	Accounts Payable	\$200.00
02/01/2022	31324	CORPORATE PAYMENT SYSTEMS	Accounts Payable	\$2,893.09
02/01/2022	31325	EBBERS, JASON	Accounts Payable	\$500.00
02/03/2022	15047	Country Meats	Accounts Payable	\$354.00
02/03/2022	15048	Crossroad Designs LLC	Accounts Payable	\$12.50
02/03/2022	15049	First Bank of Nebraska	Accounts Payable	\$150.00
02/03/2022	15050	Travel With Barb	Accounts Payable	\$3,200.00
02/03/2022	15051	Meridian Activity Fund	Accounts Payable	\$50.00

02/07/2022	15052	First Bank of Nebraska	Accounts Payable	\$200.00
02/08/2022	15053	First Bank of Nebraska	Accounts Payable	\$770.00
02/08/2022	15054	Brian Reese	Accounts Payable	\$125.00
02/08/2022	15055	Chuck Taylor	Accounts Payable	\$125.00
02/08/2022	15056	Troy Hayes	Accounts Payable	\$125.00
02/10/2022	15057	Aaron Williams	Accounts Payable	\$125.00
02/10/2022	15058	First Bank of Nebraska	Accounts Payable	\$770.00
02/10/2022	15059	Harris, Steve	Accounts Payable	\$125.00
02/10/2022	15060	Lauren Harms	Accounts Payable	\$22.00
02/10/2022	15061	Lyle Ziems	Accounts Payable	\$125.00
02/10/2022	15062	Menards	Accounts Payable	\$250.56
02/10/2022	15063	NE SKILLS USA	Accounts Payable	\$2,076.00
02/10/2022	15064	Scholastic Book Fairs	Accounts Payable	\$530.83
02/14/2022	15065	Falls City Sacred Heart	Accounts Payable	\$75.00
02/14/2022	15066	NATIONAL FFA ORGANIZATION	Accounts Payable	\$179.00
02/14/2022	15067	Sterling Community Association	Accounts Payable	\$3,500.00
02/14/2022	15068	University of Nebraska-Lincoln	Accounts Payable	\$40.00
02/14/2022	31341	ADAMS SUPER FOODS	Accounts Payable	\$25.45
02/14/2022	31342	Allen, Adrian W	Accounts Payable	\$50.00
02/14/2022	31343	Alm, Kim L	Accounts Payable	\$112.18
02/14/2022	31344	Amazon Capital Services	Accounts Payable	\$472.52
02/14/2022	31345	Beatrice Mechanical Service Inc	Accounts Payable	\$2,735.17
02/14/2022	31346	Blick art material	Accounts Payable	\$127.69
02/14/2022	31347	Boden, Ronald R	Accounts Payable	\$25.00
02/14/2022	31348	Boldt, Luke M	Accounts Payable	\$25.00
02/14/2022	31349	Boslau, Dennis R	Accounts Payable	\$25.00
02/14/2022	31350	Buss Pest Control	Accounts Payable	\$70.00
02/14/2022	31351	CAPITAL BUSINESS SYSTEMS, INC	Accounts Payable	\$934.43
02/14/2022	31352	Cash-wa Distribution	Accounts Payable	\$4,777.93
02/14/2022	31353	CULLIGAN OF LINCOLN	Accounts Payable	\$137.00
02/14/2022	31354	DAS State Accounting - Central Finance	Accounts Payable	\$518.98
02/14/2022	31355	DAVENPORT, JACOB M	Accounts Payable	\$50.00
02/14/2022	31356	Dunn, Mary R	Accounts Payable	\$24.00
02/14/2022	31357	EDGERTON EXPLORIT CENTER	Accounts Payable	\$1,999.32
02/14/2022	31358	EGAN SUPPLY CO	Accounts Payable	\$734.30
02/14/2022	31359	ESU #4	Accounts Payable	\$22,545.00
02/14/2022	31360	ESU #6	Accounts Payable	\$61.00
02/14/2022	31361	First Bank of Nebraska	Accounts Payable	\$20.00
02/14/2022	31362	FOLLETT SCHOOL SOLUTIONS INC	Accounts Payable	\$1,429.50
02/14/2022	31363	Glaser Ceramics	Accounts Payable	\$478.45
02/14/2022	31364	Hancock Lumber, LLC	Accounts Payable	\$24.14
02/14/2022	31365	Heusman, Brent J	Accounts Payable	\$25.00
02/14/2022	31366	HILAND DAIRY	Accounts Payable	\$1,811.29
02/14/2022	31367	JET STOP INC.	Accounts Payable	\$2,208.15

02/14/2022	31368	Johnson County Hospital	Accounts Payable	\$1,954.95
02/14/2022	31369	Journey Ed	Accounts Payable	\$1,222.40
02/14/2022	31370	JW PEPPER & SON, INC	Accounts Payable	\$67.99
02/14/2022	31371	KLEIN HARDWARE HEATING & AIR	Accounts Payable	\$863.52
02/14/2022	31372	KnowBe4	Accounts Payable	\$783.20
02/14/2022	31373	KSB SCHOOL LAW	Accounts Payable	\$154.00
02/14/2022	31374	Laffman Hot Rod Garage	Accounts Payable	\$233.20
02/14/2022	31375	Logston, Steven	Accounts Payable	\$35.10
02/14/2022	31376	MARSHALL KATIE B	Accounts Payable	\$105.18
02/14/2022	31377	Matheson Trigas DBA Linweld	Accounts Payable	\$34.62
02/14/2022	31378	Menards	Accounts Payable	\$60.68
02/14/2022	31379	Mike's Welding	Accounts Payable	\$532.51
02/14/2022	31380	Nasco	Accounts Payable	\$119.95
02/14/2022	31381	NCECBVI	Accounts Payable	\$1,095.60
02/14/2022	31382	Nebraska Association Of Scbd	Accounts Payable	\$3,406.00
02/14/2022	31383	Nebraska Public Power Distric	Accounts Payable	\$2,332.03
02/14/2022	31384	NRCSA	Accounts Payable	\$130.00
02/14/2022	31385	OverDrive Education	Accounts Payable	\$250.00
02/14/2022	31386	PANKO	Accounts Payable	\$4,063.75
02/14/2022	31387	PSAT/NMSQT	Accounts Payable	\$126.00
02/14/2022	31388	School Health	Accounts Payable	\$51.71
02/14/2022	31389	Staples	Accounts Payable	\$225.12
02/14/2022	31390	Striv, Inc	Accounts Payable	\$1,975.00
02/14/2022	31391	Symmetry Energy Solutions, LLC	Accounts Payable	\$887.30
02/14/2022	31392	SYSCO OF LINCOLN	Accounts Payable	\$5,017.47
02/14/2022	31393	T.O. Haas	Accounts Payable	\$2,923.38
02/14/2022	31394	Tecumseh Chieftain	Accounts Payable	\$51.60
02/14/2022	31395	The Home Depot Pro	Accounts Payable	\$39.02
02/14/2022	31396	UNITE PRIVATE NETWORKS, LLC	Accounts Payable	\$556.43
02/14/2022	31397	United States Postal Service	Accounts Payable	\$20.85
02/14/2022	31398	Village Of Sterling	Accounts Payable	\$222.00
02/14/2022	31399	WageWorks, Inc	Accounts Payable	\$86.75
02/14/2022	31400	Waymire Well Drilling, Inc.	Accounts Payable	\$32.35
02/14/2022	31401	WINDSTREAM COMMUNICATIONS, INC	Accounts Payable	\$1,060.82
02/14/2022	31402	Wirthele, Cheri J	Accounts Payable	\$25.00
02/14/2022	31403	WUSK ELECTRIC	Accounts Payable	\$354.84
Sub Total				\$101,344.35

Sterling Public Schools

Check Listing Report

Accounting Cycle: FY21/22; Begin Date: 01/13/2022; End Date: 02/14/2022; Bank: First National Bank; Sort By Element: Rev_Exp; Account Expression: [All]; Created On: 2/17/2022 1.

Check Date	Check Number	Payee	Description	Type
02/10/2022	15057	Aaron Williams	Inv: ref check	Accounts Payable
02/14/2022	31341	ADAMS SUPER FOODS	Inv: 01/31/2022	Accounts Payable
02/14/2022	31342	Allen, Adrian W	Inv: January cellphone	Accounts Payable
02/14/2022	31343	Alm, Kim L	Inv: reimbursement	Accounts Payable
02/14/2022	31344	Amazon Capital Services	Inv: 16dr-cj1c-jmdc	Accounts Payable
02/14/2022	31344	Amazon Capital Services	Inv: 17xm-7l6h-kxjy	Accounts Payable
02/14/2022	31344	Amazon Capital Services	Inv: 1xrm-rrlm-16cf	Accounts Payable
02/14/2022	31344	Amazon Capital Services	Inv: multiple	Accounts Payable
01/28/2022	15041	Auburn Design Shop LLC	Inv: 3635	Accounts Payable
02/14/2022	31345	Beatrice Mechanical Service Inc	Inv: 210579	Accounts Payable
02/14/2022	31346	Blick art material	Xiem Silicone Rib - Soft 5, Crayola Broad Line Markers - Assorted Colors Set of 256	Accounts Payable
02/14/2022	31347	Boden, Ronald R	Inv: Jan cellphone	Accounts Payable
02/14/2022	31348	Boldt, Luke M	Inv: Jan Cell	Accounts Payable
01/17/2022	15020	Book, P J	Inv: 01-18-22 ref checks	Accounts Payable
02/14/2022	31349	Boslau, Dennis R	Inv: jan cellphone	Accounts Payable
02/08/2022	15054	Brian Reese	Inv: GBB ref	Accounts Payable
02/14/2022	31350	Buss Pest Control	Inv: 01/24/22	Accounts Payable
02/14/2022	31351	CAPITAL BUSINESS SYSTEMS, INC	Inv: 30907674	Accounts Payable
01/17/2022	15021	Cash-wa Distribution	Inv: 13230560	Accounts Payable
01/28/2022	15042	Cash-wa Distribution	Inv: 13237953	Accounts Payable
02/14/2022	31352	Cash-wa Distribution	Inv: 13231531	Accounts Payable
02/14/2022	31352	Cash-wa Distribution	Inv: 13249726	Accounts Payable
02/14/2022	31352	Cash-wa Distribution	Inv: 13256655	Accounts Payable
02/14/2022	31352	Cash-wa Distribution	Inv: 13262756, A13257613	Accounts Payable
02/14/2022	31352	Cash-wa Distribution	Inv: C13233614	Accounts Payable
02/14/2022	31352	Cash-wa Distribution	Inv: C13235353	Accounts Payable
01/17/2022	15022	Champion TEAMWEAR	Inv: 0011372236	Accounts Payable
01/20/2022	15031	Chase Bryant	Inv: 1.21.22 ref check	Accounts Payable
02/08/2022	15055	Chuck Taylor	Inv: GBB ref	Accounts Payable
01/13/2022	15016	CORPORATE PAYMENT SYSTEMS	Inv: Activity Credit Card pmt January	Accounts Payable
02/01/2022	31324	CORPORATE PAYMENT SYSTEMS	Inv: January 2022 bill	Accounts Payable
02/03/2022	15047	Country Meats	FFA	Accounts Payable
02/03/2022	15048	Crossroad Designs LLC	Inv: ag flowers	Accounts Payable
02/14/2022	31353	CULLIGAN OF LINCOLN	Inv: 192946	Accounts Payable
02/14/2022	31354	DAS State Accounting - Central Finance	Inv: 1300534	Accounts Payable
02/14/2022	31354	DAS State Accounting - Central Finance	Inv: 1304755	Accounts Payable
02/14/2022	31355	DAVENPORT, JACOB M	Inv: January cellphone	Accounts Payable

02/14/2022	31356	Dunn, Mary R	Inv: reimbursement	Accounts Payable
02/01/2022	31325	EBBERS, JASON	Inv: 01/24/2021	Accounts Payable
02/14/2022	31357	EDGERTON EXPLORIT CENTER	Inv: SR21058	Accounts Payable
02/14/2022	31358	EGAN SUPPLY CO	Inv: 346479A	Accounts Payable
02/14/2022	31358	EGAN SUPPLY CO	Inv: 347562	Accounts Payable
02/14/2022	31359	ESU #4	Inv: 9747 network admin 2nd half	Accounts Payable
02/14/2022	31359	ESU #4	Inv: 9768	Accounts Payable
02/14/2022	31360	ESU #6	Inv: 16452	Accounts Payable
02/14/2022	15065	Falls City Sacred Heart	Inv: Live stream	Accounts Payable
01/18/2022	15029	First Bank of Nebraska	Inv: G/B BB/concessions 01.18.22	Accounts Payable
01/20/2022	15032	First Bank of Nebraska	Inv: G/B BB 01.21.22 gate/conc	Accounts Payable
01/24/2022	15035	First Bank of Nebraska	Inv: gate and concessions 01-25-22	Accounts Payable
01/31/2022	15046	First Bank of Nebraska	Inv: JH G BB	Accounts Payable
02/03/2022	15049	First Bank of Nebraska	Inv: CRUSH Grams HS STUCO	Accounts Payable
02/07/2022	15052	First Bank of Nebraska	Inv: BBB Gate	Accounts Payable
02/08/2022	15053	First Bank of Nebraska	Inv: gbb/concessions	Accounts Payable
02/10/2022	15058	First Bank of Nebraska	Inv: G/B BB and concessions	Accounts Payable
02/14/2022	31361	First Bank of Nebraska	Inv: 2021 safe deposit box rental	Accounts Payable
02/14/2022	31362	FOLLETT SCHOOL SOLUTIONS INC	Mid Year books and supplies request	Accounts Payable
01/17/2022	15023	Freeman Public Schools Activity Account	Inv: 1.20.22 JHGGB	Accounts Payable
02/14/2022	31363	Glaser Ceramics	glaze and clay	Accounts Payable
01/28/2022	15043	Gossard, Derrick J	Inv: HS STUCO	Accounts Payable
02/14/2022	31364	Hancock Lumber, LLC	Inv: 1172	Accounts Payable
01/17/2022	15024	Harris, Steve	Inv: Ref checks 01-17-22	Accounts Payable
02/10/2022	15059	Harris, Steve	Inv: Ref checks	Accounts Payable
01/17/2022	15025	Hauff Mid America Sports	Inv: 96050, 97188	Accounts Payable
01/28/2022	15044	Hauff Mid America Sports	Inv: 100638	Accounts Payable
01/17/2022	15026	Heavican, Kellen	Inv: 01-18-22 ref checks	Accounts Payable
01/24/2022	15036	Heise, Connor	Inv: ref check 1-25-22	Accounts Payable
01/13/2022	15017	Heusman, Brent J	Inv: Brent Activity Reimb.	Accounts Payable
02/14/2022	31365	Heusman, Brent J	Inv: January cell phone	Accounts Payable
02/14/2022	31366	HILAND DAIRY	Inv: 953490, 953561, 953601, 953683,	Accounts Payable
01/20/2022	15033	Isaak Russell	Inv: G/B bb 01.20.22 ref	Accounts Payable
01/17/2022	15027	Jeff Bracht	Inv: 1-18-22 ref checks	Accounts Payable
02/14/2022	31367	JET STOP INC.	Inv: 5018	Accounts Payable
02/14/2022	31368	Johnson County Hospital	Inv: Dennis Boslau Physical	Accounts Payable
02/14/2022	31368	Johnson County Hospital	Inv: January 2022 OT	Accounts Payable
02/14/2022	31368	Johnson County Hospital	Inv: January 2022 PT	Accounts Payable
02/14/2022	31368	Johnson County Hospital	Inv: Luke Boldt Physical	Accounts Payable
02/14/2022	31369	Journey Ed	Microsoft office	Accounts Payable
01/24/2022	15037	Justin Pavich	Inv: 01-25-22 ref checks	Accounts Payable
02/14/2022	31370	JW PEPPER & SON, INC	Inv: 364029038, 364028742	Accounts Payable
01/13/2022	15018	Kevin Kroon	Inv: 5057	Accounts Payable
02/14/2022	31371	KLEIN HARDWARE HEATING & AIR	Inv: 3325	Accounts Payable

02/14/2022	31372	KnowBe4	12 month term	Accounts Payable
01/24/2022	15038	Kosch, John	Inv: Pioneer music conference	Accounts Payable
02/14/2022	31373	KSB SCHOOL LAW	Inv: 11443	Accounts Payable
02/14/2022	31374	Laffman Hot Rod Garage	Inv: 245, 235, 200	Accounts Payable
02/10/2022	15060	Lauren Harms	Inv: refund FBLA	Accounts Payable
02/14/2022	31375	Logston, Steven	Inv: reimb.	Accounts Payable
02/10/2022	15061	Lyle Ziems	Inv: ref check	Accounts Payable
01/13/2022	15019	Mahaska-Pepsi	Inv: Jan 13th concession soda	Accounts Payable
01/28/2022	15045	Mahaska-Pepsi	Inv: 01-27-22	Accounts Payable
02/14/2022	31376	MARSHALL KATIE B	Inv: 01/31/2022	Accounts Payable
02/14/2022	31377	Matheson Trigas DBA Linweld	Inv: 51908185	Accounts Payable
02/10/2022	15062	Menards	Inv: 77146	Accounts Payable
02/14/2022	31378	Menards	Inv: 75895	Accounts Payable
02/03/2022	15051	Meridian Activity Fund	Inv: 02-07-2022 JH girls tournament	Accounts Payable
01/20/2022	15034	Meyer, Devan	Inv: 1.21.22 ref check	Accounts Payable
02/14/2022	31379	Mike's Welding	Inv: 5765	Accounts Payable
02/14/2022	31380	Nasco	Ceramic Bisque Tiles - 4-1/4 in. x 4-1/4 in. - Box of 80	Accounts Payable
02/14/2022	31380	Nasco	Inv: WOB3JR0	Accounts Payable
02/14/2022	15066	NATIONAL FFA ORGANIZATION	Inv: MDS255528 FFA	Accounts Payable
02/14/2022	31381	NCECBVI	Inv: o-891	Accounts Payable
02/14/2022	31381	NCECBVI	Inv: O-911	Accounts Payable
02/10/2022	15063	NE SKILLS USA	Beau Kastars entry fee	Accounts Payable
02/10/2022	15063	NE SKILLS USA	Nebraska Leadership Conference	Accounts Payable
02/10/2022	15063	NE SKILLS USA	Nebraska Middle School West Conference	Accounts Payable
02/10/2022	15063	NE SKILLS USA	Nebraska Middle School West Conference Mr. Helmherner	Accounts Payable
02/14/2022	31382	Nebraska Association Of Scbd	Inv: 22/23 dues	Accounts Payable
02/14/2022	31383	Nebraska Public Power Distric	Inv: January 14th Bill	Accounts Payable
02/14/2022	31384	NRCSA	Inv: LF 0037	Accounts Payable
02/14/2022	31385	OverDrive Education	Inv: 4193	Accounts Payable
02/14/2022	31386	PANKO	Inv: 2239	Accounts Payable
02/14/2022	31387	PSAT/NMSQT	AI282240	Accounts Payable
01/17/2022	15028	PSC MATH CLUB	Inv: 03.18.22 Math Day	Accounts Payable
02/10/2022	15064	Scholastic Book Fairs	Inv: B5213552F3	Accounts Payable
02/14/2022	31388	School Health	athletic foam	Accounts Payable
02/14/2022	31389	Staples	3M™ Dual Laminate Refill Cartridge (DL951)	Accounts Payable
02/14/2022	15067	Sterling Community Association	Inv: 1st half of the year	Accounts Payable
02/14/2022	31390	Striv, Inc	2021-2022 Bronze Package	Accounts Payable
02/14/2022	31391	Symmetry Energy Solutions, LLC	Inv: 12538284	Accounts Payable
02/14/2022	31392	SYSCO OF LINCOLN	Inv: 461078827, 461089483, 461100197,	Accounts Payable
02/14/2022	31393	T.O. Haas	Inv: 753, 748, 278	Accounts Payable
02/14/2022	31394	Tecumseh Chieftain	Inv: 4609	Accounts Payable
02/14/2022	31395	The Home Depot Pro	Inv: 662462191	Accounts Payable
01/19/2022	15030	Travel With Barb	Inv: 21-22 Band Trip	Accounts Payable

02/03/2022	15050	Travel With Barb	Inv: Music trip 2nd payment	Accounts Payable
02/08/2022	15056	Troy Hayes	Inv: GBB ref	Accounts Payable
02/14/2022	31396	UNITE PRIVATE NETWORKS, LLC	Inv: SI-22-004559	Accounts Payable
02/14/2022	31397	United States Postal Service	Inv: postage	Accounts Payable
02/14/2022	15068	University of Nebraska-Lincoln	math day	Accounts Payable
02/14/2022	31398	Village Of Sterling	Inv: 18732	Accounts Payable
02/14/2022	31398	Village Of Sterling	Inv: 6205	Accounts Payable
02/14/2022	31399	WageWorks, Inc	Inv: INV3337405	Accounts Payable
02/14/2022	31400	Waymire Well Drilling, Inc.	Inv: 22R32	Accounts Payable
02/14/2022	31401	WINDSTREAM COMMUNICATIONS, INC	Inv: 01/31/2022	Accounts Payable
02/14/2022	31401	WINDSTREAM COMMUNICATIONS, INC	Inv: 1753791T059	Accounts Payable
02/14/2022	31402	Wirthele, Cheri J	Inv: january cellphone	Accounts Payable
02/14/2022	31403	WUSK ELECTRIC	Inv: 418	Accounts Payable
01/25/2022	15040	Zabel, Brody	Inv: 01-25-22 ref checks	Accounts Payable
Sub Total				

2:30:11 PM

Amount
\$125.00
\$25.45
\$50.00
\$112.18
\$60.86
\$46.97
\$11.59
\$353.10
\$66.00
\$2,735.17
\$127.69
\$25.00
\$25.00
\$125.00
\$25.00
\$125.00
\$70.00
\$934.43
\$976.07
\$598.90
\$314.00
\$1,806.27
\$591.43
\$1,530.72
\$20.61
\$514.90
\$26.94
\$125.00
\$125.00
\$900.00
\$2,893.09
\$354.00
\$12.50
\$137.00
\$259.49
\$259.49
\$50.00

\$24.00
\$500.00
\$1,999.32
\$9.35
\$724.95
\$22,500.00
\$45.00
\$61.00
\$75.00
\$770.00
\$770.00
\$770.00
\$200.00
\$150.00
\$200.00
\$770.00
\$770.00
\$20.00
\$1,429.50
\$125.00
\$478.45
\$50.00
\$24.14
\$75.00
\$125.00
\$1,000.74
\$96.00
\$125.00
\$125.00
\$27.21
\$25.00
\$1,811.29
\$125.00
\$125.00
\$2,208.15
\$152.00
\$1,476.15
\$174.80
\$152.00
\$1,222.40
\$125.00
\$67.99
\$110.00
\$863.52

\$783.20
\$291.00
\$154.00
\$233.20
\$22.00
\$35.10
\$125.00
\$260.40
\$433.44
\$105.18
\$34.62
\$250.56
\$60.68
\$50.00
\$125.00
\$532.51
\$84.45
\$35.50
\$179.00
\$547.80
\$547.80
\$16.00
\$1,760.00
\$275.00
\$25.00
\$3,406.00
\$2,332.03
\$130.00
\$250.00
\$4,063.75
\$126.00
\$50.00
\$530.83
\$51.71
\$225.12
\$3,500.00
\$1,975.00
\$887.30
\$5,017.47
\$2,923.38
\$51.60
\$39.02
\$3,752.85

\$3,200.00
\$125.00
\$556.43
\$20.85
\$40.00
\$172.00
\$50.00
\$86.75
\$32.35
\$391.78
\$669.04
\$25.00
\$354.84
\$125.00
\$101,344.35

Sterling Public Schools General Fund February 2020-2021 Financial Report

TOTAL RECEIPTS		February 2021		February 2022			
1100	Regular Education	\$126,632.51	\$805,574.24	\$130,839.20	\$813,692.23	\$4,206.69	3.32%
1190	Early Childhood	\$15,072.94	\$98,388.53	\$21,770.55	\$134,812.70	\$6,697.61	44.43%
1200	SPED	\$18,332.28	\$143,520.33	\$17,883.22	\$11,785.50	-\$449.06	-2.45%
1300	Summer School	\$25.96	\$129.80	\$0.00	\$1,439.42	-\$25.96	-100.00%
2120	Guidance Services	\$8,213.22	\$54,523.82	\$8,602.96	\$53,901.00	\$389.74	4.75%
2140/2041	SPED Psychological Services	\$0.00	\$22,506.46	\$11,425.50	\$57,127.50	\$11,425.50	#DIV/0!
2151	SPED Speech Path & Audiology	\$0.00	\$24,009.00	\$0.00	\$21,222.44	\$0.00	#DIV/0!
2161/2162	SPED - Occupational Services	\$1,018.48	\$6,107.19	\$1,476.15	\$9,567.87	\$457.67	44.94%
2171	SPED - Physical Therapy	\$0.00	\$266.66	\$174.80	\$1,060.20	\$174.80	#DIV/0!
2181	SPED - Visually Impaired	\$0.00	\$1,436.90	\$1,095.60	\$2,600.00	\$1,095.60	#DIV/0!
2190	Support Services	\$303.81	\$1,162.35	\$93.96	\$2,045.00	-\$209.85	-69.07%
2213	Instructional Staff Training	\$100.00	\$350.00	\$0.00	\$4,540.50	-\$100.00	-100.00%
2220	Library Services	\$5,484.44	\$24,885.00	\$5,857.06	\$35,584.81	\$372.62	6.79%
2230	Instructional-Related Technology	\$20,636.83	\$52,527.46	\$23,117.43	\$61,904.24	\$2,480.60	12.02%
2290	Other Support Services	\$0.00	\$638.03	\$0.00	\$907.11	\$0.00	#DIV/0!
2310	Board of Education	\$101.91	\$5,845.24	\$3,656.25	\$11,751.39	\$3,554.34	3487.72%
2320	Executive Administration	\$12,951.84	\$79,263.00	\$13,376.93	\$84,320.70	\$425.09	3.28%
2330	District Legal Services	\$334.00	\$3,778.28	\$154.00	\$6,103.84	-\$180.00	-53.89%
2410	Office of the Principal	\$11,546.32	\$74,485.84	\$12,727.80	\$76,989.11	\$1,181.48	10.23%
2510	Fiscal Services	\$3,308.19	\$30,989.74	\$4,228.00	\$35,271.61	\$919.81	27.80%
2530	Printing, Publishing, & Duplicating Services	\$1,333.05	\$8,701.00	\$934.43	\$5,752.02	-\$398.62	-29.90%
2570	Personnel Services	\$0.00	\$170.00	\$0.00	\$300.00	\$0.00	#DIV/0!
2580	Administrative Technology Service	\$750.00	\$6,097.58	\$3,793.00	\$5,803.02	\$3,043.00	405.73%
2610	Operation of Buildings	\$17,628.25	\$91,861.81	\$12,332.68	\$111,694.70	-\$5,295.57	-30.04%
2620	Maintenance of Buildings	\$589.08	\$8,926.30	\$325.48	\$3,402.28	-\$263.60	-44.75%
2630/2640	Care and Upkeep of Grounds	\$426.87	\$3,066.27	\$525.58	\$5,856.28	\$98.71	23.12%
2660	Security	\$449.99	\$449.99	\$0.00	\$0.00	-\$449.99	0.00%
2710	Vehicle Operation & Purchasing	\$7,447.16	\$131,085.21	\$11,678.23	\$68,212.58	\$4,231.07	56.81%
2712	Vehicle Operation & Purchasing - SPED SA	\$202.29	\$951.13	\$0.00	\$0.00	-\$202.29	-100.00%
2730	Vehicle Servicing & Maintenance	\$304.35	\$7,846.44	\$7,580.33	\$19,723.47	\$7,275.98	2390.66%
2732	Vehicle Servicing & Maintenance - SPED SA	\$0.00	\$200.00	\$0.00	\$200.00	\$0.00	#DIV/0!
2790	Other Student Transportation Services	\$0.00	\$200.00	\$0.00	\$0.00	\$0.00	#DIV/0!
2792	Other Student Transportation Services - SPED SA	\$0.00	\$749.36	\$0.00	\$0.00	\$0.00	#DIV/0!
2900	Other Support Services	\$5,817.75	\$66,583.88	\$16,715.64	\$93,847.93	\$10,897.89	187.32%
3100	Food Services Operations	\$13,058.72	\$86,085.99	\$19,941.67	\$96,847.93	\$6,882.95	52.71%
3535	High Ability Learners			\$0.00	\$5,225.00	\$0.00	#DIV/0!
5000	Debt Services	\$0.00	\$228,918.75	\$0.00	\$237,115.50	\$0.00	#DIV/0!
6200	Federal Services - Title I	\$8,034.53	\$48,316.13	\$8,277.44	\$49,766.88	\$242.91	3.02%
6210	Federal Services - Title I	\$0.00	\$10,765.00	\$0.00	\$0.00	\$0.00	#DIV/0!
6406	Federal Services - IDEA PreSchool					\$0.00	
6408	Federal Services - IDEA	\$0.00	\$26,097.32		\$11,718.73	\$0.00	#DIV/0!
6992	Federal Services - REAP	\$0.00	\$23,939.00	\$0.00	\$24,481.00	\$0.00	#DIV/0!
6997	Federal Services - ESSERS II				\$21,449.00		
8000	Transfers	\$0.00	\$0.00	\$0.00	\$0.00	\$0.00	#DIV/0!
		\$280,104.77	\$2,181,399.03	\$321,158.52	\$2,188,023.49	\$41,053.75	14.66%

STERLING PUBLIC SCHOOLS MONTH BOARD REPORT 2021-2022

	2020-2021	2021-2022	2020-2021	2019-2020
Sept. 2021 Gross Payroll	\$ 273,126.60	\$ 236,589.74	\$ 225,348.31	
Sept. 2021 EOM Expenditures	\$ 89,790.25	\$ 84,209.59	\$ 63,144.76	
Total Sept. 2020 Expenditures w/ adjustments	\$ 362,916.85	\$ 320,799.33	\$ 288,493.07	\$ -
Year to Date Total	7.37%	6.30%	\$ 2,472,338.35	\$ 2,124,757.60
			50.20%	41.75%
Oct. 2020 Gross Payroll	\$ 231,460.38	\$ 244,127.60	\$ 227,239.40	
Oct. 2020 EOM Expenditures	\$ 80,244.55	\$ 84,357.17	\$ 89,558.12	
Total Oct. 2020 Expenditures w/ adjustments	\$ 311,704.93	\$ 328,484.77	\$ 316,797.52	\$ -
Year to Date Total	13.70%	12.76%	\$ 2,789,135.87	\$ 2,124,757.60
			56.63%	41.75%
Nov. 2020 Gross Payroll	\$ 234,617.84	\$ 239,019.65	\$ 233,200.52	
Nov. 2020 EOM Expenditures	\$ 389,631.83	\$ 78,753.02	\$ 71,929.81	
Total Nov. 2020 Expenditures w/ adjustments	\$ 624,249.67	\$ 317,772.67	\$ 305,130.33	\$ -
Year to Date Total	26.37%	19.00%	\$ 3,094,266.20	\$ 2,124,757.60
			62.82%	41.75%
Dec. 2020 Gross Payroll	\$ 227,931.38	\$ 239,509.74	\$ 211,708.30	
Dec. 2020 EOM Expenditures	\$ 74,662.64	\$ 312,422.40	\$ 76,071.54	
Total Dec. 2020 Expenditures w/ adjustments	\$ 302,594.02	\$ 551,932.14	\$ 287,779.84	\$ -
Year to Date Total	\$ 1,601,465.47	\$ 1,518,988.91	\$ 3,382,046.04	\$ 2,124,757.60
	32.51%	29.85%	68.67%	41.75%
Jan. 2020 Gross Payroll	\$ 230,093.46	\$ 235,751.02	\$ 192,563.98	
Jan. 2020 EOM Expenditures	\$ 72,210.81	\$ 61,063.87	\$ 77,176.02	
Total Jan. 2020 Expenditures w/ adjustments	\$ 302,304.27	\$ 296,814.89	\$ 269,740.00	\$ -
Year to Date Total	\$ 1,903,769.74	\$ 1,815,803.80	\$ 3,651,786.04	\$ 2,124,757.60
	38.65%	35.68%	74.14%	41.75%
Feb. 2020 Gross Payroll	\$ 222,315.24	\$ 236,666.47	\$ 200,501.29	
Feb. 2020 EOM Expenditures	\$ 57,760.30	\$ 72,287.33	\$ 108,471.72	
Total Feb. 2020 Expenditures w/ adjustments	\$ 280,075.54	\$ 308,953.80	\$ 308,973.01	\$ -
Year to Date Total	\$ 2,183,845.28	\$ 2,124,757.60	\$ 3,960,759.05	\$ 2,124,757.60
	44.34%	41.75%	80.42%	41.75%

2020/21 Budget	2021/22 Budget
\$4,925,347.00	\$5,089,019.00
\$3,910,830.00	\$3,951,894.00

Total Operation Budget

\$330,063.25

SUPERINTENDENT'S CONTRACT OF EMPLOYMENT STERLING PUBLIC SCHOOLS

THIS CONTRACT is made by and between the **Board of Education of Sterling Public Schools**, legally known as **Johnson County School District No. 49-0033**, and referred to as "the Board" and "the School District" respectively, and **Adrian Allen**, referred to herein as "the Superintendent". In accordance with its action taken and recorded in the minutes of a duly advertised board meeting, the Board agrees to employ the Superintendent, and the Superintendent agrees to accept such employment, subject to the terms and conditions set forth herein.

Section 1. Term of Contract. The Superintendent shall be employed for a period of two (2) year(s) beginning on July 1, 2020, and expiring on June 30, 2022. References to "contract year" shall mean the period from July 1st through June 30th and shall consist of all days except Saturdays and Sundays and any holidays or leave days listed in Section 11.

Section 2. Renewal of Contract. If a Board representative does not inform the Superintendent in writing on or before **the seventh day after the regular December board meeting** of the Board's intention to consider the nonrenewal or amendment of this contract, the contract will automatically renew for a period of **one year** from and after the expiration date provided in Section 1 of this contract. The Superintendent shall remind the Board in writing of this provision no later than **its regular November meeting** of each year of this contract and shall make the renewal of his employment contract an agenda item for the regular **December** board meeting during each year of this contract. At the time of each contract renewal and/or amendment, the Superintendent shall be responsible for taking all necessary steps to insure that the district has complied with the Superintendent Pay Transparency Act.

Section 3. Salary. The Superintendent's annual salary for the contract year shall be \$117,420.00 which shall be paid in 12 equal monthly installments beginning in the month of August 2021. The Board shall not reduce the Superintendent's salary during the term of the contract, but may increase it and/or the benefits during the term of this contract, as an amendment to the contract, without the amendment constituting a new contract, requiring a hearing, or extending the term of this contract.

Section 4. Deductions. This contract shall conform to the statutes and regulations governing deductions from compensation and shall be subject to the School Employees Retirement Act. The Superintendent authorizes the District to deduct or withhold from each and every period of pay any amounts necessary to offset any damages caused by the

Superintendent or the value of property or money entrusted to the Superintendent or owed by the Superintendent to the District during the course of or as a result of the Superintendent's employment, if such property or money have not properly been returned to the District. The school district shall withhold other deductions as the Superintendent and Board may agree.

Section 5. Professional Status. The Superintendent affirms that he is not under contract with any other board of education covering any part or all of the term provided in this contract. Throughout the contract term, he will hold a valid and appropriate certificate to act as a superintendent of schools in the State of Nebraska which he will register and maintain on file in the school district's central administrative office. This contract shall not be valid and the Board will not compensate the Superintendent for any service performed prior to the date that he registers his certificate. The Superintendent represents that: (1) all information he provided in connection with his application for employment with the District was true and accurate at the time of application, and if there is or has been a material change in such information, he will advise the Board immediately; (2) he has never been convicted of or plead no contest to, a felony as defined in Title 92, Chapter 21, Sections 003.11 and 003.13 of the Nebraska Administrative Code ("Rule 21"), or any offense involving moral turpitude, abuse, neglect, or sexual misconduct, as defined in Title 92, Chapter 21, Sections 003.12 and 003.13 of the Nebraska Administrative Code; and (3) he has not had any professional licenses or certificates suspended or revoked.

Section 6. Superintendent's Duties. The Superintendent's duties shall be as prescribed by statute and by Board policies, rules, regulations, and directives. The Superintendent agrees to devote his time, skill, labor, and attention to his duties throughout the contract term. He shall be subject to the direction and control of the Board at all times and shall perform such administrative duties as the Board assigns to him. By agreement with the Board, he may undertake consultative work, speaking engagements, writing, lecturing, or other professional duties and obligations as long as they do not interfere with carrying out his duties and obligations to the school district.

Section 7. Board-Superintendent Relationship. The Board shall be primarily responsible for formulating and adopting policy. The Superintendent shall be the chief administrative officer for the district and shall be responsible for implementing Board policy. He shall organize the administrative and supervisory staff, and select, place, and transfer personnel with the concurrence of the Board. He is responsible for administering the instruction of students and the business affairs of the school district. The Board members agree, individually and collectively, to promptly refer all criticisms, complaints, and suggestions called to their

attention to the Superintendent for action, study, and/or recommendation, as appropriate.

Section 8. Cancellation or Mid-Term Amendment. The Board may cancel or amend this contract during its term for any of the following reasons: (a) the cancellation, termination, revocation, or suspension of the Superintendent's certificate (Nebraska Administrative and Supervisory Certificate, or the Nebraska Professional Administrative and Supervisory Certificate) by the State Board of Education; (b) any of the reasons set forth in this contract; (c) the breach of any of the material provisions of this contract; (d) incompetence; (e) neglect of duty; (f) unprofessional conduct; (g) insubordination; (h) conduct involving moral turpitude; (i) physical or mental incapacity; (j) immorality; (k) conviction of a felony; (l) any conduct that substantially interferes with the Superintendent's continued performance of his duties; (m) any arrest, criminal charge, or criminal conviction of Superintendent or the failure to report the same; (n) any filing against the Superintendent under Neb. Rev. Stat. Section 43-247 or any other provision of the Nebraska Juvenile Code for child abuse and/or neglect or the failure to report the same; (o) knowingly falsifying school district records or documents; (p) misrepresentation of fact to the district and its personnel in the conduct of the district's official business; (q) the use or possession of illegal drugs or controlled substances except as prescribed by a physician; or (r) being under the influence of illegal drugs, controlled substances, or alcohol while on school grounds, at school events, or in a vehicle owned, leased or contracted by the district except as prescribed by a physician. The procedures for cancellation or amendment shall be in accordance with state statutes. The parties agree that the Superintendent's failure to comply with his duties under Section 2 (Renewal of Contract) or Section 15 (Evaluation) shall constitute a material breach of this contract.

Section 9. Disability. If the Superintendent is unable to perform his duties by reason of illness, accident or other disability beyond his control, and the disability continues for a period of more than sixty (60) days or if the disability is permanent, irreparable, or of such a nature as to make performance of his duties impossible, the Board may initiate action to cancel this contract, whereupon the respective rights, duties and obligations of the parties hereunder shall terminate, with the exception of any benefits to be paid to the Superintendent under any insurance coverage furnished by the district.

Section 10. Transportation. The Board shall provide the Superintendent with transportation or reimburse him for mileage required in the performance of his official duties at the rate approved by the Board.

Section 11. Fringe Benefits. The Board shall provide the Superintendent with the following fringe benefits:

- a. Health Insurance.** Family health insurance that is provided to certificated staff through the District's health insurance carrier.
- b. Dental Insurance.** Single (employee-only) dental insurance that is available to certificated staff through the District's health insurance carrier.
- c. Sick Leave.** The Superintendent shall be entitled to ten (10) days of sick leave per year which may accumulate to a total of forty-five (45) days. Sick leave may only be used when the Superintendent is unable to perform assigned duties due to the illness or temporary disability of the Superintendent or the Superintendent's need to care for a member of the Superintendent's Immediate Family who is ill or has a serious health condition. For purposes of this sick leave, "Immediate Family" shall mean "Family and Extended Family" as defined in the Certified Employee Handbook. If the Superintendent qualifies for disability pay under the long-term disability policy, he shall be required to take the disability pay instead of sick leave pay. The Superintendent shall keep complete and accurate records of his sick days and shall provide the Board of Education with a report of his accumulated sick days at least quarterly. The Superintendent shall not be compensated for unused days of sick leave upon the ending of his employment with the District.
- d. Disability Insurance.** The Superintendent shall purchase short-term and long-term disability insurance from the school district's carrier at his own expense. The Board will increase his salary by the amount of the premium cost.
- e. Vacation.** The Superintendent shall have twenty-five (25) vacation days for the 2020-21 contract year which he may use at times he chooses so long as his absence does not interfere with the proper performance of his duties. Any extended vacation period while school is in session will require advance approval by the Board, and the parties will cooperate in arranging vacation time so as to cause the least inconvenience to the normal operation of the District. After the 2020-21 contract year, the Board shall give the

Superintendent the number of days necessary to restore his total to twenty-five (25) days. For example, if he uses 12 days of vacation one year, the board will provide him with 12 days the following year to bring his total to 25 days. The Superintendent shall develop a system for recording his use of vacation days and shall keep such records current and on file in the District's central office. The Superintendent shall keep complete and accurate records of his vacation days and shall provide the Board of Education with a report of his accumulated vacation days at least quarterly. The Board may require him to use his vacation days and shall compensate him for unused vacation days, at the rate of two hundred fifty dollars (\$250.00) per unused vacation day, upon the conclusion of his employment

- f. Professional Development.** The Superintendent is expected to continue his professional development and to participate in relevant learning experiences. With the approval of the Board, he may attend appropriate professional meetings at the local, state, regional and national level; and the Board will pay for valid expenses of attendance. If the Superintendent attends a national convention and does not return following the initial year of employment as Superintendent, the Superintendent agrees to repay the District in full for national convention expenses paid by the District.
- g. Professional Dues.** The School District will pay the annual dues for the Superintendent's membership in the following organizations: the American Association of School Administrators and the Nebraska Council of School Administrators.
- h. Physical Examination.** The Superintendent may voluntarily undergo a physical examination. The Superintendent agrees that he will authorize the physician performing each such examination to provide the Board with all records, results, and medical judgments of the examination.
- i. Bereavement Leave.** The Superintendent shall be permitted bereavement leave as provided in the Certified Employee Handbook.

- j. Holidays.** The Superintendent shall receive the following paid holidays: New Year's Day, Memorial Day, Fourth of July, Labor Day, Thanksgiving Day, the day following Thanksgiving Day, and Christmas Day.
- k. Cell Phone.** The Superintendent shall be required to purchase and maintain a cellular phone so that he can be reached at all times for work-related emergencies or while away from school grounds during the workday. The School District will reimburse the Superintendent up to a maximum of fifty dollars (\$50.00) per month for the actual cost of a cellular phone service plan.
- l. Expense Reimbursement.** The Board shall pay or reimburse the Superintendent for expenses that are actually, necessarily, and reasonably incurred in attending educational seminars, conventions, and workshops; conferences; training programs; official school functions, hearings or meetings, provided that (1) such payment or expense is authorized by the Local Government Miscellaneous Expenditures Act (Neb. Rev. Stat. § 13-2201 *et seq.*) or some other provision of law, and (2) the Superintendent shall secure the prior approval of the Board before incurring any such expense when the anticipated aggregate expense of any single event is \$.00 or more.
- m. Moving Expenses.** The Board shall reimburse the Superintendent for the actual, reasonable, and necessary costs of moving the Superintendent's domicile and principal residence within the boundaries of the District in an amount not to exceed the total sum of Two Thousand Dollars (\$2,000.00), with such reimbursement to be made upon presentation to the Board of receipts and itemization for such costs provided that Superintendent establishes his domicile and principal residences within the boundaries of the District no later than September 1, 2021.

Section 12. Residence/Domicile in School District. The Superintendent shall have his domicile and principal residence within the boundaries of the District as they exist on the first duty day for the Superintendent under the terms of this contract; and, the Superintendent shall maintain his domicile and residence within the boundaries of the District during the term of this agreement, or any renewal, amendment, or

continuation thereof, except as otherwise provided herein. If the Superintendent is in his first two years of employment with the District and does not have his domicile and principal place of residence within the District at the time of his initial employment, the Superintendent shall move his domicile and principal place of residence into the corporate limits of the District no later than September 1, 2021, or be able to demonstrate definite and concrete plans for establishing his domicile and principal residence within the District within a reasonable period of time thereafter. It is the purpose of this paragraph to require the Superintendent to, at all times during such employment, live and maintain his domicile and principal place of residence in the District to encourage the Superintendent: (1) to be highly motivated and deeply committed to the District's educational system; (2) to speak to and vote on ballot issues affecting the district as a legal voter of the school district; (3) to be involved in school and community activities bringing him in contact with parents and community leaders and be committed to the future of the district and its schools; (4) to be accessible to parents and students, and allow parents and students to become personally acquainted with the Superintendent; and, (5) to gain sympathy and understanding for the cultural basis of the community, and the social, economic, and environmental problems of the children of the school community and are thus less likely to be considered isolated from the community in which he is the educational leader.

Section 13. No Penalty for Release or Resignation. There shall not be a penalty for the release or resignation of the Superintendent from this contract; provided no resignation shall become effective until the expiration of the contract unless it is accepted by the Board, and the Board shall fix the date at which the resignation shall take effect.

Section 14. Compensation Upon Termination and Credit for Accrued Vacation. Upon lawful termination of this contract for any reason, the compensation to be paid hereunder shall be an amount which bears the same ratio to the annual salary specified as the number of months or fraction thereof to the date of such termination bears to the twelve (12) months in the annual salary period in which termination occurs. The Superintendent shall refund any portion of the salary he was paid but had not earned prior to the date of termination of this contract. He shall be paid for any unused vacation days at the daily compensation rate then in effect at the termination of employment.

Section 15. Evaluation. The Board shall evaluate the Superintendent twice during his first year of employment and at least once each year thereafter. The first evaluation during the first year of employment and the yearly evaluations after the first year of employment shall occur no later than the **regular December meeting**. The

Superintendent shall: remind the Board members in writing of this provision no later than its **regular November meeting**; make his evaluation an agenda item for the regular **December** board meeting during each year of this contract; and provide them with the written evaluation instrument that is on file with the Nebraska Department of Education.

Section 16. Legal Actions. The Board will support the Superintendent if there is a legal dispute caused by him carrying out his duties properly. If a legal action, including a professional practice complaint, is threatened or filed against the Superintendent as a result of his performance of his duties or his position as Superintendent of the district, the Board will provide him with a legal defense to the maximum extent permitted by law so long as he acted in good faith and in a manner which he reasonably believes to be in or not opposed to the best interests of the district and, with respect to any criminal action or proceeding, had no reasonable cause to believe that his conduct was unlawful.

Section 17. Physical or Mental Examination. The Superintendent agrees that, at the request of the Board, he will have a comprehensive physical and/or mental examination performed by one or more licensed physicians or psychologists of the Board's choosing during the term of this Contract. In deference to the requirements of the Americans with Disabilities Act and HIPAA, the physician's report to the Board must address whether the Superintendent is able to perform the "essential functions" of his position.

Section 18. Disciplinary Action. The parties agree that the Board president may place the Superintendent on paid leave by delivering written notice of the same when the Board president determines it is in the best interests of the school district to do so. The paid leave shall continue unless and until a majority of the Board determines otherwise at a duly convened meeting. The Board may suspend the Superintendent without pay for a period not to exceed thirty (30) working days. Prior to suspending the Superintendent without pay, the Board president or secretary shall deliver a written notice to the Superintendent advising him of the alleged reasons for the proposed action and provided the opportunity to present his version of the facts. Within seven calendar days after receipt of such notice, the Superintendent may make a written request to the secretary of the school board for a formal due process hearing under section 79-832. If such a request is not delivered within such time, the action of the Board shall become final.

Section 19. Governing Laws. The parties shall be governed by all applicable Nebraska and federal laws, rules, and regulations in performance of their respective duties and obligations under this contact.

Section 20. Amendments to be in Writing. This contract may be modified or amended only by a writing duly authorized and executed by the Superintendent and the Board.

Section 21. Severability. If any portion of this contract is declared invalid or unenforceable by a court of competent jurisdiction, such declaration shall not affect the validity or enforcement of the remaining provisions of this contract.

IN WITNESS WHEREOF, the parties have executed this contract on the dates indicated below.

Executed by the Board this ____ day of _____, 2020.

President, Board of Education

Secretary, Board of Education

Executed by the Superintendent this ____ day of _____, 2020.

Superintendent



1706 N 203rd St
Elkhorn, NE 68022
hrcroof.com

HEARTLAND ANNUAL SERVICE AGREEMENT
FOR EXISTING ROOFS

OWNER: Sterling Public Schools

<u>BLDG DESCRIPTION</u>	<u>ADDRESS</u>	<u>ROOF AREA</u>	<u>ROOF SYSTEM TYPE</u>
Shelby Public School	250 Main St. Sterling NE	35,347 Sq Ft	Mixed Roof System

Initial Contract term will be for five (5) years beginning on March 01, 2022 and expiring on Feb 28, 2027. The contract will be billed quarterly. Any additional square feet added will be billed at the Service Agreement Rate of \$.07/sq. ft.

TOTAL SQUARE FEET OF ROOFING IN REGION: 35,347 Sq. Ft.

SERVICE AGREEMENT RATE: \$.07/SQ. FT. (+IRS published mileage rate for appropriate sites)

ANNUAL SERVICE AGREEMENT PRICE: \$2,474.29

ACCEPTANCE

HEARTLAND ROOFING CONSULTANTS

By: Zach Williams
Zach Williams

By: _____

Its: Owner

Its: _____

Date: 10 Feb 2022

Date: _____



HEARTLAND ROOF MAINTENANCE PROGRAM

FEATURES & BENEFITS

<u>FEATURE</u>	<u>PROVIDER</u>	<u>BENEFIT</u>
1. EMERGENCY LEAK NUMBER	HEARTLAND RFG. CONS. PHONE ANSWERED 24/7	*IMMEDIATE RESPONSE TO YOUR EMERGENCY
2. REPAIR & MAINTENANCE SPECIFICATIONS	HEARTLAND TO CONTRACTOR	*REDUCES RE-WORK *ESTABLISHES STANDARDS & QUALITY EXPECTATIONS *ENSURES CORRECT MATERIALS ARE USED
3. SCHEDULED ANNUAL HOUSEKEEPING	HEARTLAND RFG. CONS.	*REDUCES ROOF PUNCTURES, PLUGGED DRAINS AND GUTTERS *MAXIMIZES ROOF CYCLE LIFE
4. SCHEDULED ANNUAL PREVENTIVE MAINTENANCE	HEARTLAND RFG. CONS.	*PROTECTS INTERNAL OPERATIONS FROM DISRUPTIONS DUE TO LEAKS *REDUCES POTENTIAL FOR LEAKS *REDUCES EMERGENCY REPAIR COSTS *PROTECTS ROOFING INVESTMENT

SCHEDULED HOUSEKEEPING

INSPECT AND PROPERLY DISPOSE OF ALL INCIDENTAL DEBRIS FROM THE ROOF MEMBRANE, DRAINS, GUTTERS AND SCUPPERS. DEBRIS TO BE DISPOSED OF ON SITE.

ANNUAL PREVENTIVE MAINTENANCE

INCLUDES THE FOLLOWING:

METAL EDGE FLASHINGS:

- TEARS, SPLITS AND BREAKS IN THE MEMBRANE FLASHINGS REPAIRED WITH APPROPRIATE MATERIALS.
- OPEN/SPLIT FLASHING STRIP-INS REPAIRED WITH APPROPRIATE MATERIALS.
- METAL EDGE CLEATS AND CLIPS WILL BE RE-SECURED.

PARAPET WALL AND COUNTER-FLASHING SYSTEMS:

- TEARS, SPLITS AND BREAKS IN THE MEMBRANE FLASHINGS WILL BE REPAIRED WITH APPROPRIATE MATERIALS.
- BREAKS, TEARS AND SPLITS IN FLASHING STRIP-INS WILL BE REPAIRED WITH APPROPRIATE MATERIALS.
- COAT ALL EXPOSED REINFORCING MEMBRANE WITH APPROVED MASTIC.
- EXPOSED FASTENERS WILL BE RE-SEALED.
- VOIDS IN TERMINATION BARS, COUNTER-FLASHINGS AND PARAPET CAP WILL BE CLEANED & RE-SEALED.
- RE-SECURE TERMINATION BARS AND COUNTER-FLASHINGS.
- CHECK AND RE-SECURE LOOSE METAL COPING CAPS TO CLEATS.

EQUIPMENT/PROJECTION FLASHING COMPONENTS:

- TEARS, SPLITS AND BREAKS IN THE MEMBRANE FLASHINGS WILL BE REPAIRED WITH APPROPRIATE MATERIALS.
- OPEN OR SPLIT FLASHING STRIP-INS WILL BE REPAIRED WITH APPROPRIATE MATERIALS.
- UNSECURED ROOFTOP EQUIPMENT WILL BE SECURED.

- EXPOSED FASTENERS WILL BE TIGHTENED AND RE-SEALED.
- TERMINATION BAR AND COUNTER-FLASHINGS WILL BE SEALED.
- ALL PITCH PANS WILL BE RE-FILLED AND TOPPED OFF.
- METAL PROJECTIONS, HOODS AND CLAMPS WILL BE CHECKED AND RE-SEALED.

ROOF MEMBRANE:

- TEARS, SPLITS AND BREAKS IN THE MEMBRANE FLASHINGS WILL BE REPAIRED WITH APPROPRIATE MATERIALS.
- OPEN OR SPLIT FLASHING STRIP-INS WILL BE REPAIRED WITH APPROPRIATE MATERIALS.
- ALL MEMBRANE REPAIRS WILL FOLLOW THE MANUFACTURER'S WRITTEN REPAIR AND MAINTENANCE GUIDELINES.
- DRESS-UP REFLECTIVE COATINGS ON FLASHINGS.
- COAT ALL EXPOSED REINFORCING MEMBRANE WITH APPROVED MASTIC.

DRAINS, GUTTERS AND SCUPPERS:

- CHECK AND RE-SECURE DRAIN BOLTS AND CLAMPING RINGS.
- ADVISE OWNER OF MISSING DRAIN STRAINERS.
- CHECK STRIP-IN AROUND DRAIN LEADS, COAT WITH APPROPRIATE MATERIAL.
- CHECK GUTTER STRAPS, JOINTS AND STRIP-INS.
- CHECK INSIDE AND EXTERIOR OF SCUPPERS FOR OPEN SOLDER OR CAULKING SEALS.

METAL ROOFS:

- CHECK ALL FIELD LAPS AND CAULK AS NECESSARY
- CHECK ALL FASTENER HEADS AND RE-TIGHTEN AS NECESSARY
- CHECK FOR PANEL CORROSION
- CHECK GUTTER STRAPS, JOINTS AND STRIP-INS
- CHECK INSIDE GUTTERS FOR JOINT FAILURE AND CORROSION

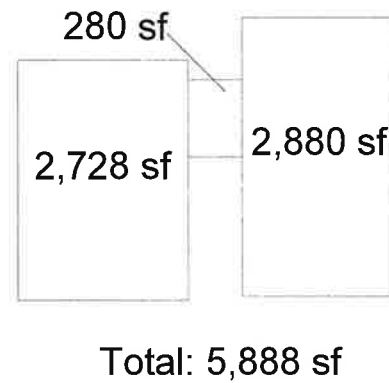
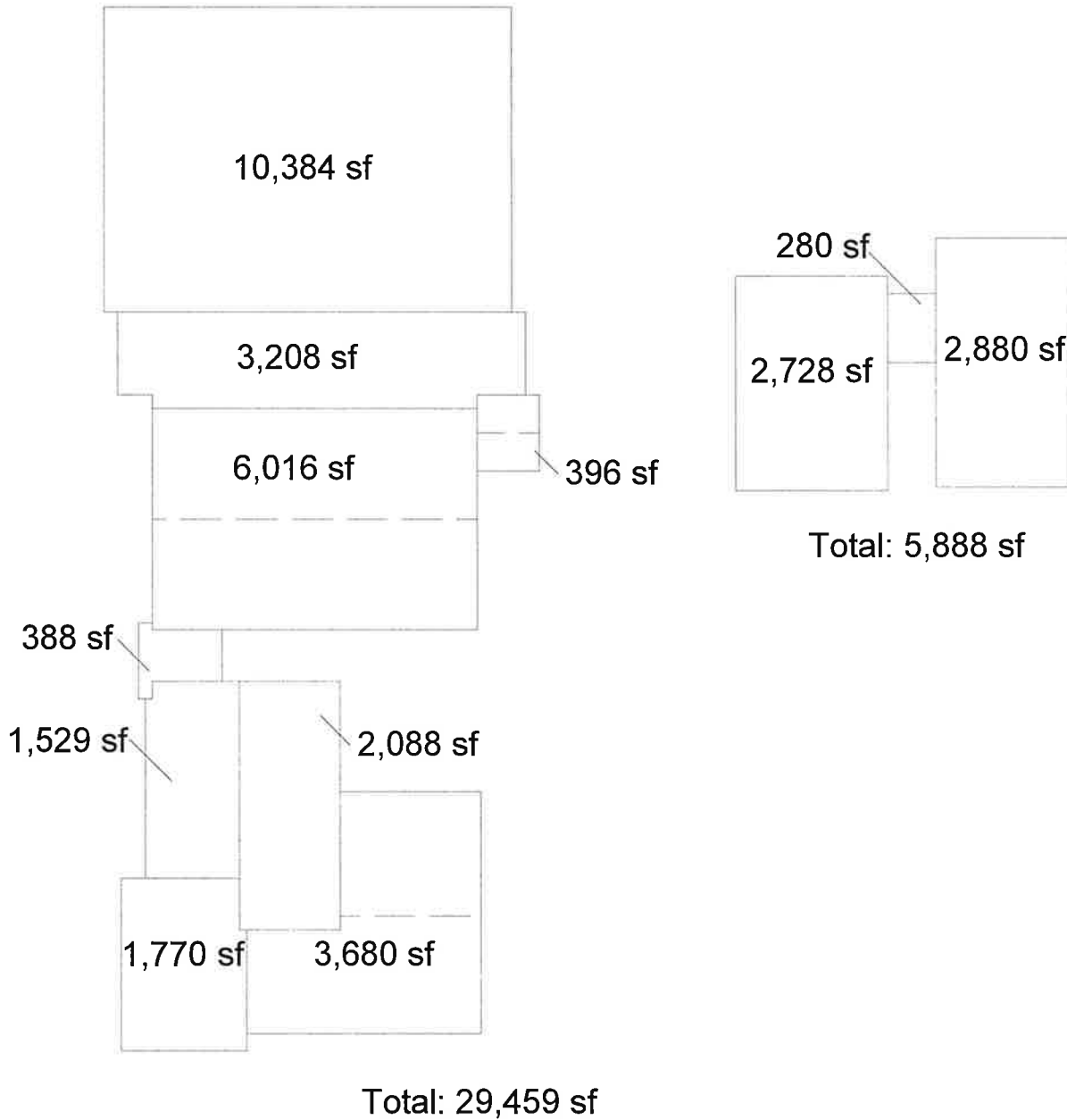

STERLING PUBLIC SCHOOL
TOTAL: 35,347 sf



STERLING PUBLIC SCHOOLS

HOME OF THE JETS · www.sterlingjets.org

Adrian Allen · *Superintendent*

Jacob Davenport · *Principal & Activities Director*



250 MAIN STREET · P.O. BOX 39 · STERLING, NEBRASKA 68443

PHONE (402) 866-4761 · FAX (402) 866-4771

February 15, 2022

Dear Administration and Sterling Board of Education,

After much consideration and thinking, I feel it is the best time for me to resign as the 2nd grade teacher at Sterling Public Schools and enjoy retirement. After 30+ years of teaching at Sterling I want to be grandma. I enjoyed my time and would love the opportunity to serve another capacity in the future. Thank you.

Sincerely,

A handwritten signature in blue ink that reads "Tammy McAuliffe". The signature is fluid and cursive, with a large loop at the end of the last name.

Tammy McAuliffe

STERLING PUBLIC SCHOOLS

HOME OF THE JETS · www.sterlingjets.org

Adrian Allen · Superintendent

Jacob Davenport · Principal & Activities Director



250 MAIN STREET · P.O. BOX 39 · STERLING, NEBRASKA 68443

PHONE (402) 866-4761 · FAX (402) 866-4771

Dear members of the board,

I am writing to inform you that I am resigning from my position as the Special Education teacher (K-6) in Sterling, Nebraska, effective May of 2022. I am resigning from my position because I got a job in my hometown. I would like to take this opportunity to say that making this decision has been difficult, I have had such a positive experience here and I am so grateful. I have gained so much knowledge and have enjoyed working with each and every person in the school.

Sincerely,

A handwritten signature in black ink, appearing to read "Sara Salzman". The signature is fluid and cursive, with a long horizontal flourish extending to the right.

Sara Salzman

Plan for Use of Funds

Air Quality

Replace Fluid Cooler

Teacher Professional Development

Explicit Instruction Training

Curriculum

Wonders Reading Curriculum

S.P.A.R.K. Physical Education/Health Curriculum

Approved: 8/16/21

Reviewed: 2/21/22