

Parks and Recreation Committee Meeting
Tuesday, August 19, 2025 5:00 PM
Crete City Hall
243 E 13th Street
Crete, NE 68333

1. Open Meeting

- In accordance with Nebraska law, a copy of the Open Meetings Act can be found in the back of the Council Chambers.
- Items listed on the agenda may be considered in any order.

2. Roll Call

- Attendance of members will be recorded to determine the presence of a quorum for official actions.

3. Items of Business

- The Committee may discuss or limit discussion on, hear testimony in favor of or in opposition to, or take action to provide a recommendation to the City Council on any matter presented under this title.

3.A. Discuss Usage Agreement between Crete Public Schools and City of Crete

3.B. Discuss playground improvements on Gus Stoll Park

4. Officers' Reports

- Reports may be given by the Mayor, Officers, Departments, or Councilmembers concerning the current operations of the City.
- No action can be taken on matters presented under this title except to answer any questions or to refer the matter for further action.

5. Adjournment

Disclaimers & Notices

- The Council may enter into closed session to discuss any matter on this agenda when it is determined that a closed session is clearly necessary for the protection of the public interest or the prevention of needless injury to the reputation of an individual (if such individual has not requested a public meeting) or as otherwise allowed by law. Any closed session shall be limited to the subject matter for which the closed session was called. If the motion to close passes, then immediately prior to the closed session the Mayor shall restate on the record the limitation of the subject matter of the closed session.
- The City of Crete assures that no person shall on the grounds of race, color, national origin, age, disability, handicap or sex, be excluded from participation in, be denied the benefits of, or be otherwise subjected to discrimination under any program or activity of the City receiving Federal financial assistance. To report discrimination, contact the City Clerk's office.
- The complete agenda with attachments is available at www.crete.ne.gov.

USAGE AGREEMENT

Between Crete Public Schools and the City of Crete

Regarding the Use of Parcels within Little League Park

This Usage Agreement (“Agreement”) is entered into on this ___ day of _____, 2025, by and between Crete Public Schools, a political subdivision of the State of Nebraska (“CPS”), and the City of Crete, a municipal corporation organized under the laws of the State of Nebraska (“City”).

1. Property Description

CPS is the legal owner of the following parcels located within the boundaries of the City of Crete’s Little League Park:

- Parcel No. 760010501
- Parcel No. 760010455
- Parcel No. 760011338
- Parcel No. 760011435

Collectively referred to as the “Property.”

2. Purpose

The City shall be permitted to use the Property for community recreational and athletic activities, including but not limited to City-sponsored Little League events and programs, under the terms and conditions established by CPS.

3. Liability and Indemnification

The City assumes full liability and responsibility for any and all activities conducted by the City, or its designees, on the Property.

The City shall release, defend, indemnify, and hold harmless Crete Public Schools, its Board, officers, employees, and agents from any and all claims, demands, actions, liabilities, damages, or expenses (including attorney’s fees) arising out of or related to use of the Property by the City or any third party participating in City-sponsored activities or while the Property is under the control or supervision of the City. City shall name CPS as an additional insured on its general insurance policies. This Paragraph shall survive the termination of this Agreement.

CPS shall have no responsibility or liability for injuries, damages, or claims arising from any activity conducted on the Property.

4. Calendar of Events

The City shall provide to CPS a calendar of scheduled activities and events to be held on the Property at least 30 days prior to the beginning of each activity season. Any subsequent changes or additions to the calendar shall be submitted to CPS in writing with reasonable advance notice.

5. Fees

At this time, in exchange for benefits provided to CPS by the City, CPS will not charge a fee to the City for the use of the Property. CPS reserves the right to revisit and revise this provision upon mutual agreement in the future.

6. Maintenance

The City shall be solely responsible for the regular and ongoing maintenance, repair, and upkeep of the Property, including but not limited to mowing, trash removal, surface repairs, signage, snow removal, and any other maintenance necessary to ensure the safety and usability of the park. The City’s maintenance staff is solely responsible for ensuring the safety and usability of the park.

7. Term and Termination

This Agreement shall remain in effect unless and until terminated by either party with 60 days’ written notice. Any termination shall not relieve the City of its obligations for any damages or liabilities arising during the period of use.

8. General Provisions

This Agreement represents the entire understanding between the parties and supersedes all prior discussions or agreements regarding the use of the Property.

Any amendments to this Agreement must be made in writing and signed by authorized representatives of both parties.

This Agreement shall be governed by and construed in accordance with the laws of the State of Nebraska.

IN WITNESS WHEREOF, the parties have executed this Agreement as of the date first written above.

CRETE PUBLIC SCHOOLS

By: _____

Dr. Joshua McDowell, Superintendent

Date: _____

CITY OF CRETE

By: _____

[Name, Title]

Date: _____

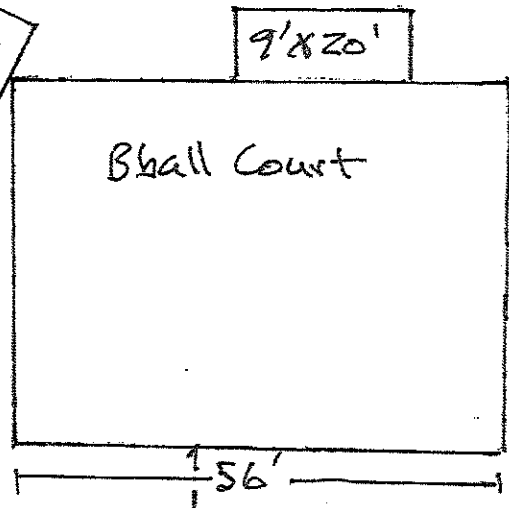
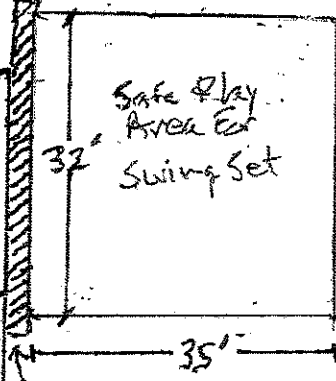
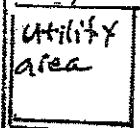
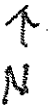
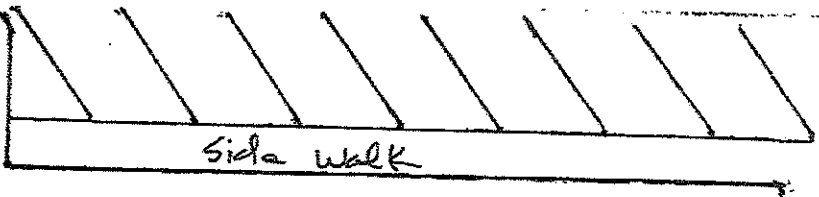
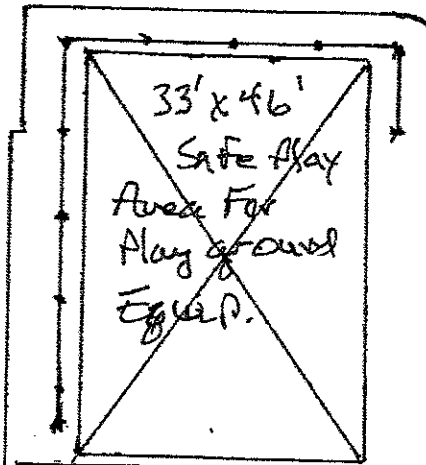

Telephone
pole
parking
barrier

Retaining wall
with bench

40'

1" = 20'
Scale

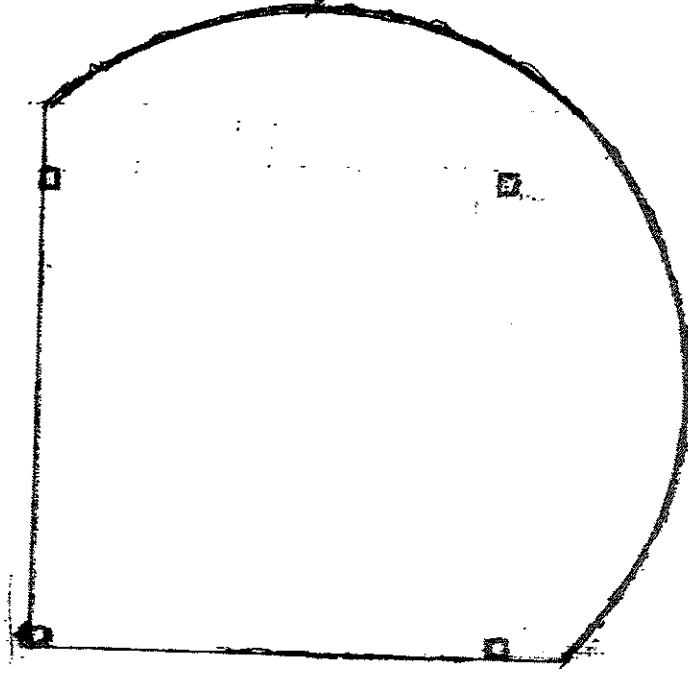



July 29, 2025
11:35 AM

DISCLAIMER: This map is not intended for conveyances, nor is it a legal survey. The information is presented on a best-efforts basis, and should not be relied upon for making financial, survey, legal or other commitments.

1:1,514

- Parcels (Saline County)
- Parcels (Lancaster County)

