

Operations Committee Meeting  
Thursday, October 28, 2021 8:30 AM  
Lower Platte North NRD Office  
P.O. Box 126  
Wahoo, NE 68066

1. UNFINISHED BUSINESS  
Nothing to consider.
2. WILD NE AND OTHER PROGRAMS  
Updated Federal paper work has been completed and turned in to the FSA regarding the Districts properties. We have forwarded a signed contract to NRCS for the prescribed burn that will take place in the Spring of 2022. We were notified that the prescribed burn will be covered 100% by the NRCS, the contract is worth \$6,360.

The tree removal contractor will start in November.

3. OPERATION & MAINTENANCE & OTHER ITEMS  
The O & M crew is busy removing trees at Czechland and Clear Creek Levee. Removed a mound of mud, provided by beaver, around the principal spillway at the Swedeburg. Finished inspecting the final three dams in the Bellwood Watershed. Hauled rip-rap to Rawhide Ditch as requested by a landowner for an eroded stream bank.
  - A. Wanhoo Stilling Basin - (FEMA)  
We have not heard from FEMA whether the change of scope is approved or disapproved.  
This morning we received this permanent well estimates from Valley Corp see attached.
  - B. Platte Valley Drainage District Levee Repairs  
Platte Valley Drainage District is seeking the remaining allocation of \$31,791.90 for their levee repair project. (Letter Attached) The District allocated \$65,000 to Platte Valley D & D after the 2019 flood event. The District paid \$33,208.10 in January for completed work and to also help with cash flow for the remaining repairs.
  - C. Hay Harvest Recreation Areas  
See attached the hay harvest summary for our recreational lands.

The Wanhoo hay revenue is \$11,233.87 and Czechland/Homestead is \$6,720.15, totaling \$17,954.02.

- D. Trapper for Hire  
Staff is soliciting trappers for quotes to trap beaver on our watershed dams and ditches. With the lack of fur bearing harvest because of low fur prices we are seeing an increase in beaver activity on our dams and ditches. Staff would like to hire a trapper for year around purposes. Staff and the hired trapper would work with the local Conservation Officer in obtaining a depredation permit. Lower Platte South had a trapper hired before he retired and are currently looking for another. See the attached photo of a mud mound we dug out on a Swedeburg Dam.  
We received one quote from Bill Chizek, set up fee whether 1 or 20 traps is \$150,

will run traps for as long as there is sign of activity, if traps are pulled and within a month there is fresh activity, we will come back and forgo the setup fee. We would like \$185/tail. He does have a fur harvest permit.

E. Bellwood Ditch 4

The Bellwood Ditch 4 system is approximately 4.5 miles in length from the bluffs to the south, to the Platte River. It was proposed by the SCS/NRCS in the mid 60's that the ditches from the Bellwood Watershed Dams be improved and maintained. The only segment that LPNDRD easements were obtained was on a 3/4 mile segment of ditch 4 (see attached map). Landowner Dennis Kucera has reminded us that we have O & M on this 3/4 of a mile. There are numerous trees to be taken out, a breach on the west bank and a large beaver dam that should be removed. The O & M crew is making plans to cut and remove trees this Fall.

Mr. Kucera may make a request for the NRD to clear more of the ditch, specifically the last 1/2 mile to the Platte River.

4. ROCK AND JETTY

There wasn't any activity this past month.

5. LAKE WANAHOO

A. HWY 77/92 & 109 Intersection and Wanahoo Dam Changes

Over the past couple of years, there has been quite a bit of discussion regarding the Hwy 77/92 and 109 intersection due to the danger of crossing 4 lanes of traffic and the fatal accidents at that location. I met with NDOT representatives this past week and was informed they will be making some changes to the highway as it crosses the Wanahoo dam in the near future.

First, within the next few weeks, the location of the 4-lane to 2-lane transition will be moved west to approximately the middle of the dam. This will allow for the 109 crossing to be a 2-lane crossing rather than a 4-lane crossing.

Next, sometime next year, there are plans to install a roundabout at the current intersection and remove the blinking red/yellow lights.

I will continue to keep the board updated as information is shared with me.

B. Lake Wanahoo Permit Sales

For the month of October, the District received \$757.50 in annual park permit revenue. The year by year breakdown for annual permits sold during the month of October is listed below. Year to date annual permit and day pass revenue total equals \$104,367.46.

C. Month	D. Monthly Total	E. YTD Total
F. October 2021	G. 757.50	H. 85,546.85
I. October 2020	J. 512.50	K. 95,957.50
L. October 2019	M. 572.50	N. 82,200.00

O. Lake Wanahoo Camping Revenue

For the month of October (as of 10/26), the District received \$4,714.00 in camping revenue at Lake Wanahoo. For the calendar year, camping revenue totals \$114,640.11. The year by year breakdown for camping revenue during the month of October is listed below.

P. Month	Q. Monthly Total	R. YTD Total
S. October 2021	T. 4,714.00	U. 114,640.11
V. October 2020	W. 10,236.02	X. 131,137.03
Y. October 2019	Z. 4,365.36	AA. 90,942.60

**BB. Clint Johannes Education Building**

During the month of October, the building was rented 17 times. This number includes 1 NRD-involved events. Revenue for month of October is \$1,520.

**6. INFORMATION AND EDUCATION**

**A. Information**

**1. Radio & eAds**

The October's KTIC Radio ad and Wahoo Newspaper e-Ad are attached. These ads shared feature no-till drill rental.

**2. Analytics**

**B. Education**

C. Date	D. School /Group	E. Grade/ Age	F. # of students	G. Topic	H. Staff
I.	J.	K.	L.	M.	N.
O. Oct 4	P. North Bend Elementary	Q. 4 <sup>th</sup> grade	R. 35	S. Wildlife CSI	T. SA / LS
U. Oct 21	V. Wahoo Public School	W. 8 <sup>th</sup> grade	X. 8	Y. Survival Club	Z. EG / LS

**7. RURAL WATER SYSTEMS**

Elliott participated in a virtual meeting with NeDHHS regarding their Low Income Household Water Assistance Program (LIHWAP). The program is purposed to provide payment to water utilities for customers who have past due balances, or disconnections. Elliott has supplied DHHS with the vendor information required to receive any payments from qualifying residents.

**A. Colon System**

Routine monthly sampling completed, meters read and bills will go out 11/1.

B. Bruno System

Attached is a proposed rate increase for the Bruno RWD. As per recommendations from auditors, and following guidance from Nebraska Rural Water Associations rate study, the proposed increase:

\$6.25/1000 gallons

\$47.00 - 3/4" meter service (residential)

\$185.00 - 2" meter service (commercial)

\$560.00 - 4" meter service (municipal)

Routine monthly sampling completed, meters read, bills out 11/1.

C. Other



# UNEARTH THE POSSIBILITIES



28001 Ida Circle  
PO BOX 589

Valley, Nebraska 68064

Phone:(402) 359-2578

Fax: (402) 359-5416

## BID PROPOSAL

Project:	Wanahoo Permanent Well Conversions			Date:	10/27/2021
Work Scope:	Permanent Well Conversions			Addedums:	
Location:	Wahoo, NE			Arch/Eng:	FYRA
Item#	Description	Unit	Quantity	Unit Price	Extended Total
1	Option 1 - Deep Well - PVC - 5 New Wells	LS	1.00	98,280.00	\$98,280.00
2	Option 1-PVC Tee Connection,Outlet Pipe & Pads (5)	LS	1.00	36,431.95	\$36,431.95
3	Option 2 - Deep Wells - SS - 5 New Wells	LS	1.00	299,426.40	\$299,426.40
4	Option 2-PVC Tee Connection,Outlet Pipe & Pads (5)	LS	1.00	36,431.95	\$36,431.95
5	Alternate - Drill Additional Well	LS	1.00	31,690.71	\$31,690.71
6	Alternate-PVC Tee Connection,Outlet Pipe & Pads(1)	LS	1.00	7,826.26	\$7,826.26
7	CMP Well Covers	EA	5.00	2,293.20	\$11,466.00
			<b>Total Extended</b>		<b>\$521,553.27</b>

This Proposal may be withdrawn if not accepted in 10 Days

\*\*\*Performance & Payment Bonds EXCLUDED, if bond is required please add 1.1% for 1 year and 1.4% for 2 Yrs\*\*\*

\*\*\*\*\*Please see below for list of exclusions\*\*\*\*\*

### EXCLUSIONS

#### General Exclusions

- Performance and Payment Bonds
- Surveying/ staking
- Testing/ Inspections
- Permits/ Fees
- Erosion control
- Traffic Control and Flaggers
- Dewatering of any Soils
- By-Pass Pumping

#### Grading Exclusions

- Rework of any compacted subgrade after passing compaction testing
- Excavation or Backfill of Structures, Walls, and Footings.
- SWPPP Inspections, BMP Repairs, Administration or Monitoring
- Over excavation or surcharge
- Shouldering of paving, Curb, and Gutter

Project:	<b>Wanahoo Permanent Well Conversions</b>	Date:	<b>10/27/2021</b>
Work Scope:	<b>Permanent Well Conversions</b>	Addeddums:	
Location:	<b>Wahoo, NE</b>	Arch/Eng:	FYRA

Item#	Description	Unit	Quantity	Unit Price	Extended Total
-------	-------------	------	----------	------------	----------------

Finish Grading for sidewalks, paving, or landscaping  
 Import or Export of topsoil or lean clay  
 Spreading of any topsoil  
 Sub Grade Preparation for Paving  
 Removal of unidentified Buried obstructions  
 Haul off of Footing or Utilities Spoils  
 Settlement Plates or Monitoring

**Utilities Exclusions**

Excavation or Backfill of Structures, Walls, and Footings.  
 SWPPP Inspections, BMP Repairs, Administration or Monitoring  
 Any Permits of installation of Utilities into building/structure service entrance  
 Capitol Utilities Fees  
 Roof Drain Connections  
 Utilities constructed to 5' of building Foundation  
 Concrete Removals other than for Utilities installation  
 Downspout connection to roof drain riser by others  
 Grate Trench Drains embedded in concrete (Paving contractor install)  
 Haul off of Spoils from Utilities Excavation  
 PIV Electrical Switch or Wiring

**NOTES / INCLUSIONS**

Backfill for Foundations material from on site source  
 Griffin Lead Time To Install PVC Well Approximatly 3 Weeks  
 Additional Lead Time For Stainless Steel Screens - 3 to 4 Weeks  
 Assuming 40-50' of pipe necessary for each relief well outlet. No FES or Turndown Construction Included in Proposal

If there are any questions please me at call at 402-659-5590

Respectfully Submitted:



Tanner Almerly, Sr. Project Manager

Accepted By: \_\_\_\_\_

Printed Name: \_\_\_\_\_

Date: \_\_\_\_\_

October 21, 2021

Lower Platte North NRD  
Attn: Bob Heimann  
511 Commercial Park Road  
Wahoo, NE 68066

RE: Cost Share Assistance – March 2019 Flood Damage Repairs

Please consider this an update from our December, 2020, request for assistance on the Platte Valley Drainage District damages. Work is ongoing on Site #8 with a contract from High Plains Enterprises.

At this time, we are requesting the remainder of your committed financial assistance in the amount of \$31,791.90.

JEO Consulting	Nov. '20 to Oct. '21	\$36,231.25	PD.
Widman	11-25-20	\$ 7,825.00	NOT PD.

Attached please find copies of the bills for each of the above listed expenses. Please let me know if you need any additional information or have any questions.

Thank you,

Kent Merryweather, Treasurer  
Platte Valley Drainage District  
626 S. 264<sup>th</sup> St.  
Waterloo, NE 68069  
402-490-4130

# Recreation Area Hay Harvest 2021

<u>Name Contractor</u>	<u>Areas Hayed</u>	<u>Wanahoo</u>	<u>Czechland/Homestead</u>
John Vybiral		<u>Area "B" \$85</u> 71 bales @ 39.87T = <u>\$3,389.80</u>	
Lazy J Cattle & Hay Craig Jelinek			<u>\$70.50</u> 142 bales @ 94.65T = <u>\$6,720.15</u>
Matt Sillivan		<u>East Rec \$78.50</u> 32 bales @ 24.37T = <u>\$1,913.05</u> <u>Area "A" \$80.00</u> 31 bales & 17 bales Snitly @ 34.61T = <u>\$2,768.80</u>	
Ken Cejka		<u>West Rec \$86.00</u> 59 bales @ 36.77T = <u>\$3,162.22</u>	
Revenue from Wannahoo		\$11,233.87	
Revenue from Czechland/Homestead			\$6,720.15
	TOTAL	<u>\$17,954.02</u>	



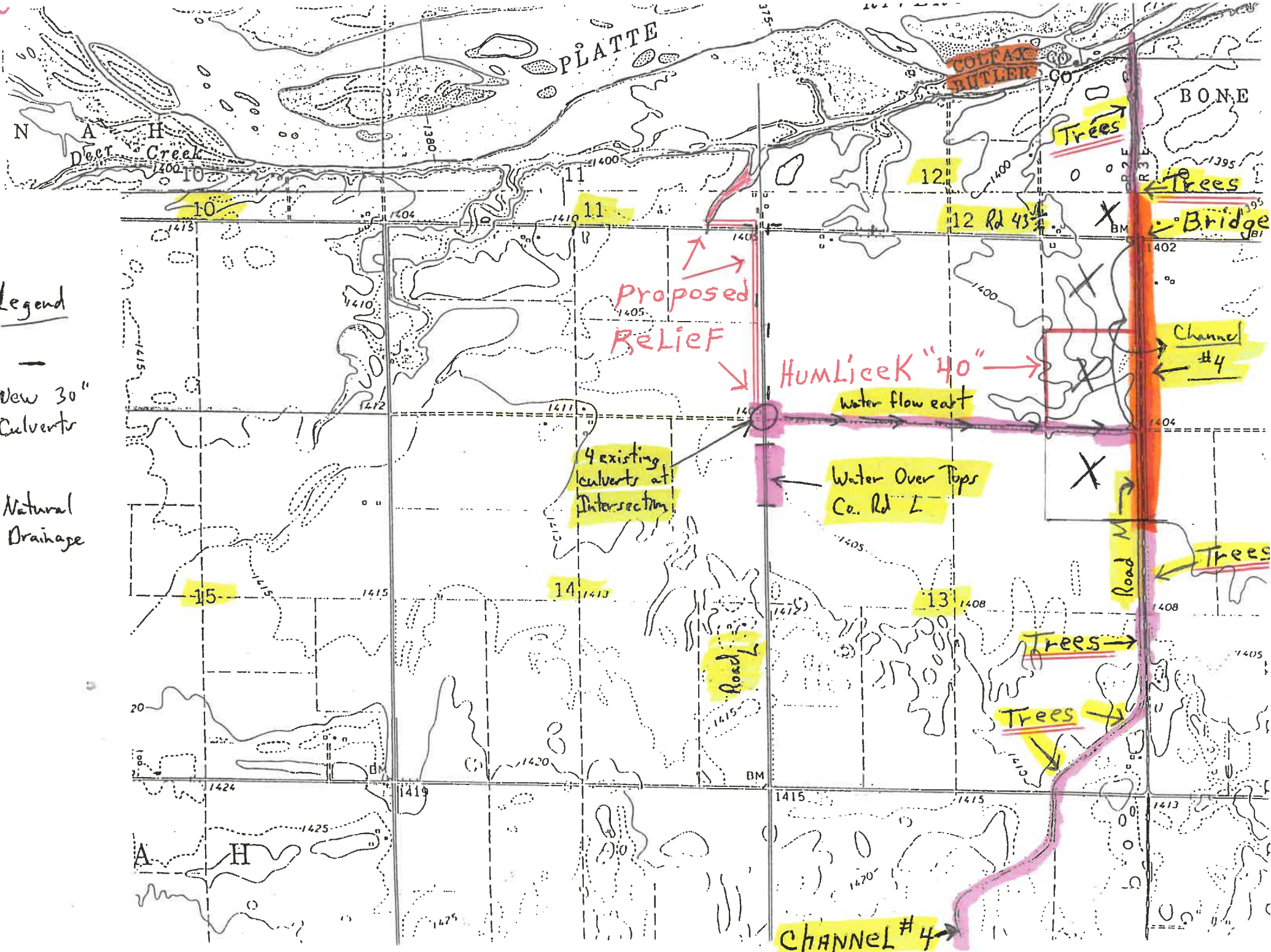

- Legend
- New 30" Culverts
  - - - Natural Drainage

Proposed Relief

Humlicek "40" water flow east

Water Over Tops Co. Rd L

4 existing culverts at Intersection

Channel #4

CHANNEL #4

Trees

Trees

Bridge

Trees

Trees

Trees

N A H Deer Creek

PLATTE

COLFAC BUTLER CO

BONE

1400 1380

1475 1410

1415 1412

15 1415

20 1424

A H 1425

11 1410

1411

14 1413

1419

1425

12 1400

12 Rd 43

1400

13 1408

1415

1415

1420

R 2 E

R 3 E

BM

402

1406

1408

1410

1413

1413

1413

1413

1413



## **KTIC Radio Ad**

**October 2021 – No-till drills**

**89 words**

Contact:  
Lacey Sabatka  
Information Coordinator  
Lower Platte North NRD  
(402) 443-4675  
lsabatka@lpnnrd.org

The Lower Platte North NRD has Great Plains No-Till drills available for rental to landowners planting native grasses, grains, and legumes. Rental rates include \$25 per day, plus \$10 per acre. There is a minimum \$75 charge.

Contact our local cooperators for drill rental: the Schuyler Co-op for Colfax County area; Rosendahl Feed & Seed for Platte County area; and in Saunders County contact Rezac Seed. Cooperators can assist in setting the drill for the appropriate mixtures. For more information, please visit [www.lpnnrd.org](http://www.lpnnrd.org) or call the NRD at 402-443-4675.

# No-Till Drill Rental

Landowners planting native grasses, grains and legumes. \$25 per day, plus \$10 per acre. Minimum \$75 charge.

**Schuyler Co-Op (Colfax County)**

**Rosendahl Feed & Seed (Platte County)**

**Rezac Seed (Saunders County)**

For more information visit [lpnnrd.org](http://lpnnrd.org) or call 402-443-4675



**LOWER PLATTE NORTH**  
Natural Resources District

## LPNNRD SOCIAL MEDIA ANALYTICS OCTOBER 2021

Number of followers

**1,297**



Gain of 5

Facebook

Number of followers

**344**

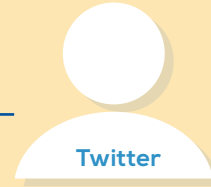

No change

Twitter

**1,311** Total views

↑ 321 from last month

**874** Total impressions

↓ 852 from last month

**44** Post engagements

↑ 4 from last month

**25** Engaged users

↓ 31 from last month

### Top Posts

- October 7th Coffee, Lakeside event
- No-till drills are available to rent
- PATH program available at Lake Wanahoo
- Handplant trees and shrubs available to order
- 2022 Nitrogen Certification and Water Management class dates

## LPNNRD WEBSITE ANALYTICS OCTOBER 2021

### HOW USERS FIND LPNNRD.ORG

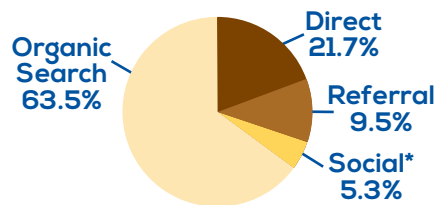

The Social Traffic included 51 clicks from Facebook and 2 from Twitter.

### USER DEVICES

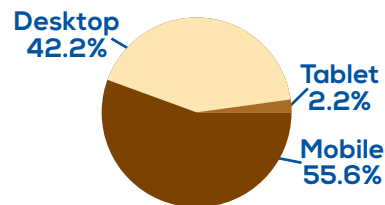

**964** Users

↓ 314 from last month

**1,186** Sessions

↓ 497 from last month

### Top Pages

Lake Wanahoo, Home, Czechland Lake, Downloads, Outdoor Recreation, Staff, Contact, Forestry, About, Projects and Programs

LOWER PLATTE NORTH NATURAL RESOURCES DISTRICT 11/2021

WATER RATE SCHEDULE FOR BRUNO RURAL WATER SUPPLY SYSTEM

Pursuant to the Rules and Regulations of the Lower Platte North Natural Resources District for the Butler County (Bruno) Rural Water System, the following shall be the rates and fees to be paid by the consumers of water service of District for the Butler County (Bruno) Rural Water Supply System.

The Water Rate Schedule for each calendar month shall be as follows:

A. Quantity (usage rate):

1 <sup>st</sup> 10,000 gallons	\$6.25/1000 gallons*
All over 10,000 gallons	\$6.25/1000 gallons*

(\* ) Plus applicable Nebraska Sales Tax

The monthly billing for water service per each type for Bruno RWD (resident/commercial) Rural Water Supply

Type of Service	Rate (*)
¾" meter (residential hookup)	\$47.00
1" meter	\$60.00
1 ½" meter	\$80.00
2" meter (commercial)	\$185.00
4" meter (municipal)	\$560.00

(\* ) Plus applicable Nebraska Sales Tax

**These rates will take effect during the March 2021 billing period.** Please feel free to contact the LPNNRD Rural Water District at (402)443-4675 with any questions. Thank you for your service.