

AGREEMENT FOR UTILITY RELOCATION
BLAIR EXECUTIVE AIRPORT(BTA)
Blair, Nebraska

AIP PROJECT NO. 3-31-0109-025/026/027/028

THIS AGREEMENT, made on the date indicated below, by and between The Blair Telephone Company, a Nebraska Corporation dba Fastwyre Broadband (13200 Metcalf Ave, Suite 400, Overland park, KS 66213) hereinafter called the Utility, and the Blair Executive Airport Authority of Blair, Nebraska, hereinafter called the Airport.

WHEREAS, Blair Airport Authority has established an airport in Blair, Nebraska, and

WHEREAS, a service line and appurtenances of the Utility have been constructed to serve the Airport and adjacent properties along County Roads 35 and 38. and will conflict with the construction of the Runway 13 extension and County Roads 35 and 38 relocation, and

WHEREAS, the Airport has coordinated with the Utility to move the said Utility line and appurtenances in the areas that conflict with the Runway 13 extension and relocation and construction of County Road 35 and 38.

NOW THEREFORE, the parties hereto agree as follows:

- 1 . The Utility agrees to relocate said utility lines and appurtenances as shown on the attached drawing marked Exhibit "A"- Utility Removal Boundary Plan – Fastwyre and relocated said underground utility lines within the newly relocated/dedicated County Roads 35 and 38 right of way shown on the attached drawing marked Exhibit "B"- Relocated County Roads 35 and 38 Right of Way Boundary Plan, which is attached hereto and made a part hereof. The work is to be done as promptly as possible upon notice to proceed by the Airport at cost not to exceed \$205,645.66, breakdown as shown on Exhibit C.
2. The Utility agrees to comply with all laws, government rules, ordinances, regulation orders or decrees, easements and required permits regulating the lowering of said utility. The Utility shall hold harmless the Airport or its authorized agents against any claim or liability resulting from work performed pursuant to this agreement, whether such work is accomplished by the Utility or by its employees, subcontractors, or agents.
3. The Airport agrees to reimburse the Utility the actual cost of construction for the actual non-betterment costs for moving said utility line not to exceed \$205,645.66. It is further agreed that upon completion of the work, the Airport's Engineer shall be notified. The Airport agrees to pay the Utility for actual non-betterment costs within 30 days of receipt of an itemized final job cost statement.

4. It is understood and agreed that this contract and any subcontracts or supplemental agreements are subject to approval by the Federal Aviation Administration before any Federal or project funds are obligated. It is further agreed by both parties hereto that upon reasonable request their cost records for the work will be made available to representatives of the Airport or the United States Government.

IN WITNESS WHEREOF the parties hereto have executed this agreement on January _____, 2026.

Blair Executive Airport, Blair Airport Authority
Blair, Nebraska

By: _____
David E. Johnson

The Blair Telephone Company, a Nebraska Corporation dba Fastwyre Broadband

By: _____

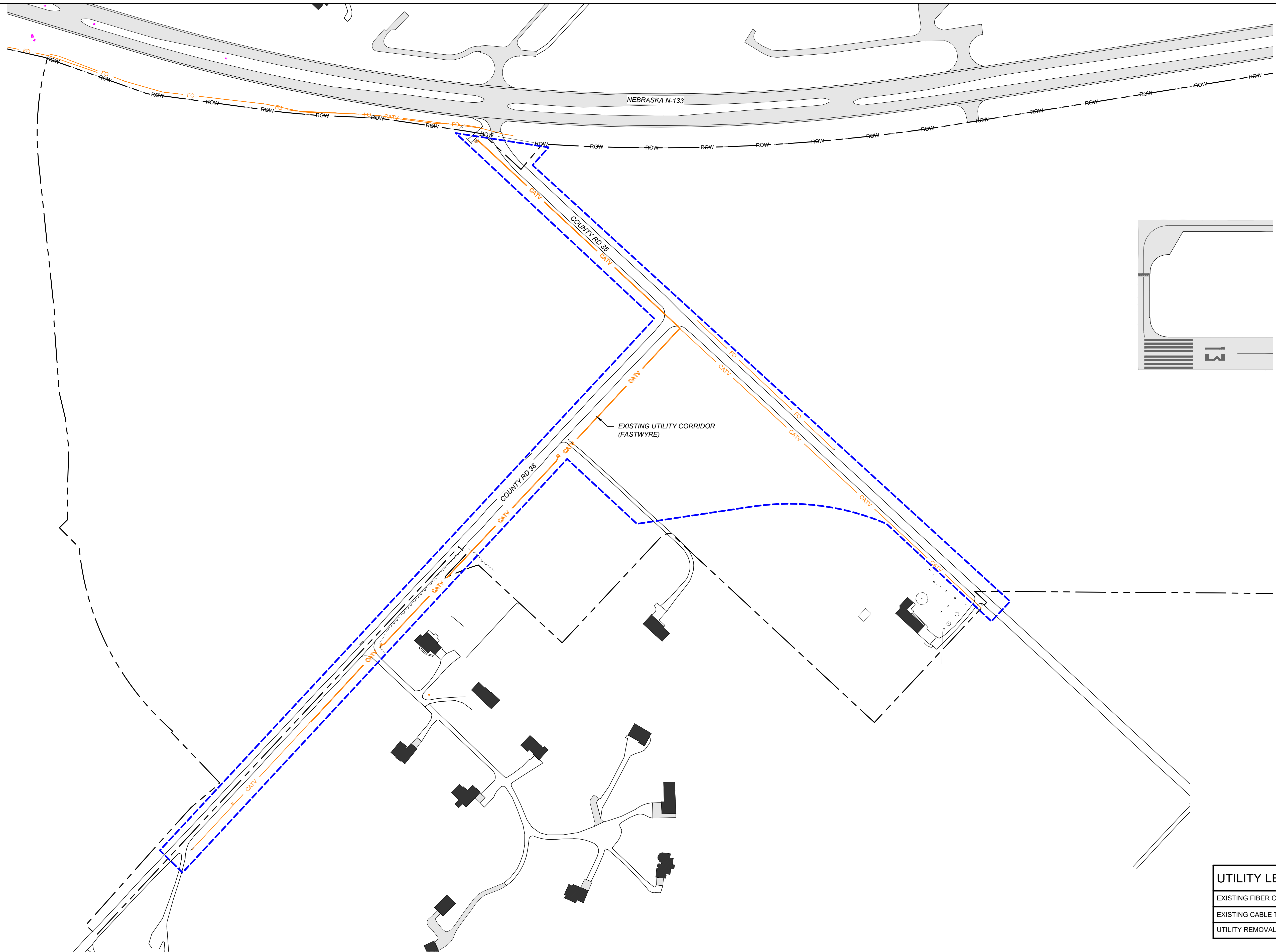
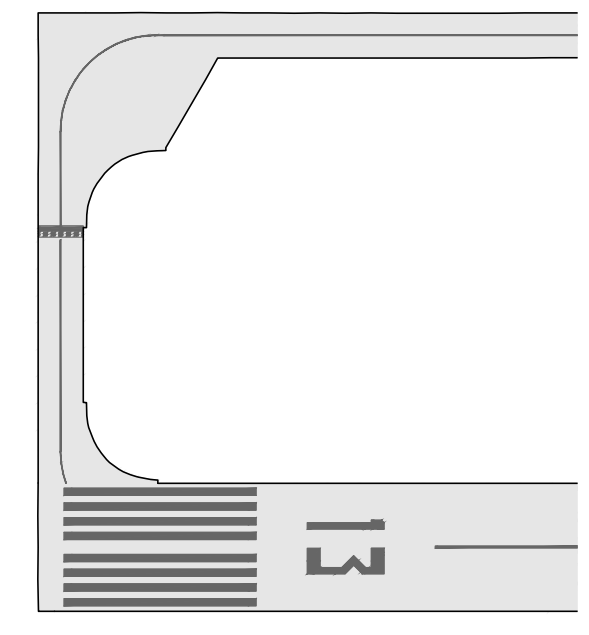
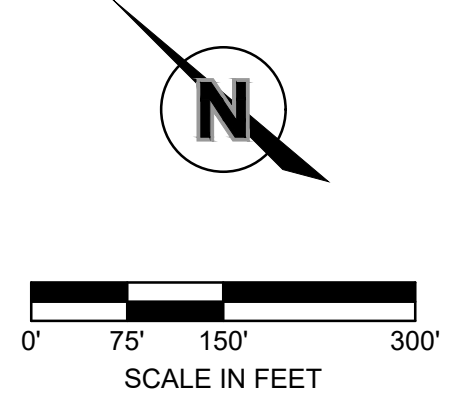

UTILITY LEGEND	
EXISTING FIBER OPTIC LINE	FO
EXISTING CABLE TV LINE	CATV
UTILITY REMOVAL BOUNDARY AREA	

PROJECT NO: 025-01994
 DRAWN BY: JTO
 DATE: 01.09.2026

BLAIR EXECUTIVE AIRPORT
 UTILITY REMOVAL BOUNDARY PLAN - FASTWYRE

olsson
 601 P Street, Suite 200
 P.O. Box 84608
 Lincoln, NE 68508
 olsson.com
 TEL 402.474.6311
 Olsson - Engineering
 Nebraska COA #CA-0638

EXHIBIT
 A

F:\2025\01\01_020501994\025-01994-CA-0638\025-01994-CA-0638-01.dwg
 DATE: Jun 13, 2026 12:14pm USER: jto

Exhibit C: Cost breakdown: The Blair Telephone Company, A Nebraska Corporation dba Fastwyre Broadband Plant Relocate Estimate

Estimate Date	10/6/2025
----------------------	------------------

Fastwyre Broadband 13200 Metcalf Ave Overland Park, KS 66212	Estimate No. Address FDA City Map Location	RL001 Blair Executive Airport N/A Blair, NE Various
--	---	---

REPAIR NOTES

This Project Sheet describes the Project agreed upon by Fastwyre and Contractor, and is issued pursuant to the Purchase Order dated September __, 2023 (the "Purchase Order") and the Master Services Agreement dated June 27, 2022, as amended, by and between the parties (the "Agreement"). The terms and conditions of the Purchase Order and the Agreement are incorporated herein by reference.			
	<table border="1" style="width: 100%; border-collapse: collapse;"> <tr> <td style="width: 60%;">Labor Costs</td> <td style="width: 40%; text-align: right;">\$ 180,174.50</td> </tr> </table>	Labor Costs	\$ 180,174.50
Labor Costs	\$ 180,174.50		
The airport in Blair is extending the length of their runway which effects Fastwyre's utilities that are currently in the area. This estimate is to move 3 ducts with fiber and coax mainline out of the area. The project linear length is roughly 8,200'. Will be diverting (2) fibers and a coax around the imminent domain areas to serve the on County Roads 35 and 38.			
	<table border="1" style="width: 100%; border-collapse: collapse;"> <tr> <td style="width: 60%;">Material Costs</td> <td style="width: 40%; text-align: right;">\$ 25,471.16</td> </tr> </table>	Material Costs	\$ 25,471.16
Material Costs	\$ 25,471.16		
	<table border="1" style="width: 100%; border-collapse: collapse;"> <tr> <td style="width: 60%;">Miscellaneous</td> <td style="width: 40%; text-align: right;">\$ 21,800</td> </tr> </table>	Miscellaneous	\$ 21,800
Miscellaneous	\$ 21,800		
This estimate should be considered high level and may not include additional labor items that aren't readily visible to Open Country at the time of this estimate.			
	<table border="1" style="width: 100%; border-collapse: collapse;"> <tr> <td style="width: 60%;">Subtotal</td> <td style="width: 40%; text-align: right;">\$ 180,174.50</td> </tr> </table>	Subtotal	\$ 180,174.50
Subtotal	\$ 180,174.50		
	<table border="1" style="width: 100%; border-collapse: collapse;"> <tr> <td style="width: 60%;">Tax 9.49%</td> <td style="width: 40%; text-align: right;">\$ -</td> </tr> </table>	Tax 9.49%	\$ -
Tax 9.49%	\$ -		
	<table border="1" style="width: 100%; border-collapse: collapse;"> <tr> <td style="width: 60%;">Total</td> <td style="width: 40%; text-align: right;">\$ 205,645.66</td> </tr> </table>	Total	\$ 205,645.66
Total	\$ 205,645.66		



Plant Relocate Estimate

ESTIMATED LABOR

Open Country, LLC
 7131 W. 135th Street #1028
 Overland Park, KS 66223
 (844) 673-6268

Estimate No. RL001
Address Blair Executive Airport
FDA N/A
City Blair, NE
Map Location Various

Code	Labor Item	Description	U/M	Quantity	Rate	Item Total
824	Place or Replace Large Vault(30x48x36)	Includes back filling, compacting, and restoration of the area around the vault back to its original condition. Includes removal and disposal of spoils on the same day. All associated hardware will be fastened as designed if applicable. This includes the placement of gravel and restoration, excluding hard scape. Includes placing ground rod if required and sealing of all conduits.	EA	11	\$ 475.00	\$ 5,225.00
823	Place or Replace Medium Vault (17x30x24)	Includes back filling, compacting, and restoration of the area around the vault back to its original condition. Includes removal and disposal of spoils on the same day. All associated hardware will be fastened as designed if applicable. This includes the placement of gravel and restoration, excluding hard scape. Includes placing ground rod if required and sealing of all conduits.	EA	2	\$ 375.00	\$ 750.00
810	Place Underground Conduit	Unit includes placement of a (1) new conduit (up to 2") at a minimum depth of 30" using any method.	FT	8202	\$ 13.00	\$ 106,626.00
811	Place Underground Conduit - Adder	Installation of an additional conduit (up to 2") to be used when design calls for more than 1 conduit in a running line. Price includes a single conduit, paid per trench foot.	FT	14223	\$ 2.50	\$ 35,557.50
830	Fiber Placement (Same Trip)	Installation of up to (2) fibers (any size) or tracer wire in a single empty conduit. Paid per trench foot.	FT	16234	\$ 1.50	\$ 24,351.00
815	Dig Up and Repair	Applies to accessing existing conduits in a given repair location. Includes repair of damaged conduit by approved means. Does not include hard surface restoration. Includes all labor to expose existing underground fiber conduit up to 8 Linear Trench (LT) feet at a maximum of 36" depth to find damaged pipe and make necessary repairs. Area to be restored to prior condition	EA	3	\$ 475.00	\$ 1,425.00
843	Mid-Sheath Fiber Entry	Unit includes all work necessary to open the sheath on a fiber (any count) in preparation for splicing.	EA	2	\$ 100.00	\$ 200.00
841	Splice Enclosure Install	Includes preparation, installation and labeling of a new splice closure. Unit for standard FOSC A,D,C size enclosures.	EA	3	\$ 300.00	\$ 900.00
842	Splice Enclosure Re-Entry	Unit includes all work necessary to bring a new fiber cable into an existing enclosure in preparation for splicing.	EA	3	\$ 225.00	\$ 675.00
840	Splice Fiber	Fusion splicing of individual strands of fiber (loose tube). Includes prep, splice and testing with splice loss not to exceed .02db per splice. Includes Uni-Directional OTDR testing	EA	96	\$ 40.00	\$ 3,840.00
845	Splice Coax	Splice in coaxial mainline	EA	5	\$ 125.00	\$ 625.00
Subtotal						\$ 180,174.50
Sales Tax						\$ -
Total						\$ 180,174.50

